

ORDINANCE NO. O-2016-103

AN ORDINANCE AMENDING THE CITY OF TYLER ZONING ORDINANCE OF THE CODE OF ORDINANCES OF THE CITY OF TYLER, TEXAS; BY CHANGING THE ZONING FROM "R-MH", MANUFACTURED HOME RESIDENTIAL DISTRICT TO "R-1A", SINGLE-FAMILY RESIDENTIAL DISTRICT ON LOT 2 OF NCB 835Y, ONE LOT CONTAINING APPROXIMATELY 0.51 ACRES OF LAND LOCATED AT THE NORTHEAST INTERSECTION OF BARNES STREET AND ROY STREET (2007 ROY STREET); DIRECTING THE AMENDMENT OF THE ZONING MAP; PROVIDING A SEVERABILITY CLAUSE; AND ESTABLISHING AN EFFECTIVE DATE.

WHEREAS, the Planning and Zoning Commission of the City of Tyler, Texas, and the City Council of the City of Tyler, Texas, in compliance with the Charter and the State law with reference to the zoning ordinance of the City of Tyler, Texas, and zoning map, have given requisite notices by publication and otherwise and after holding a due hearing and affording a full and fair hearing to all the property owners, generally and to the persons interested, situated in the affected area and in the vicinity thereof, the City Council is of the opinion that the zoning change should be made as set forth herein;

NOW, THEREFORE, BE IT ORDAINED BY THE CITY COUNCIL OF THE CITY OF TYLER, TEXAS:

PART 1: That the following zone change is hereby approved as follows:

I. APPLICATION Z16-015

That the following described property, which has heretofore been zoned "R-MH", Manufactured Home Residential District shall hereafter bear the zoning classification of "R-1A", Single-Family Residential District, to wit:

Lot 2 of NCB 835Y, one lot containing approximately 0.51 acres of land located at the northeast intersection of Barnes Street and Roy Street (2007 Roy Street).

PART 2: That the City Manager is hereby ordered and directed to cause the zoning map to be amended to reflect the above described zoning.

PART 3: Should any section, subsection, sentence, provision, clause or phrase be held to be invalid for any reason, such holding shall not render invalid any other section, subsection, sentence, provision, clause or phrase of this ordinance and same are deemed severable for this purpose.

PART 4: That this ordinance shall be effective on and after its date of passage and approval by the City Council.

PASSED AND APPROVED this the 14th day of December A.D., 2016.

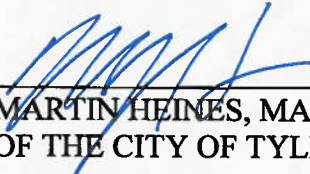

MARTIN HEINES, MAYOR
OF THE CITY OF TYLER, TEXAS

ATTEST:

APPROVED:

CASSANDRA BRAGER, CITY CLERK

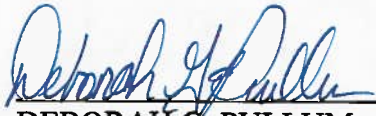

DEBORAH G. PULLUM,
CITY ATTORNEY

**ORDINANCE NO. O-2016-103
EXHIBIT "A"
LOCATION MAP**

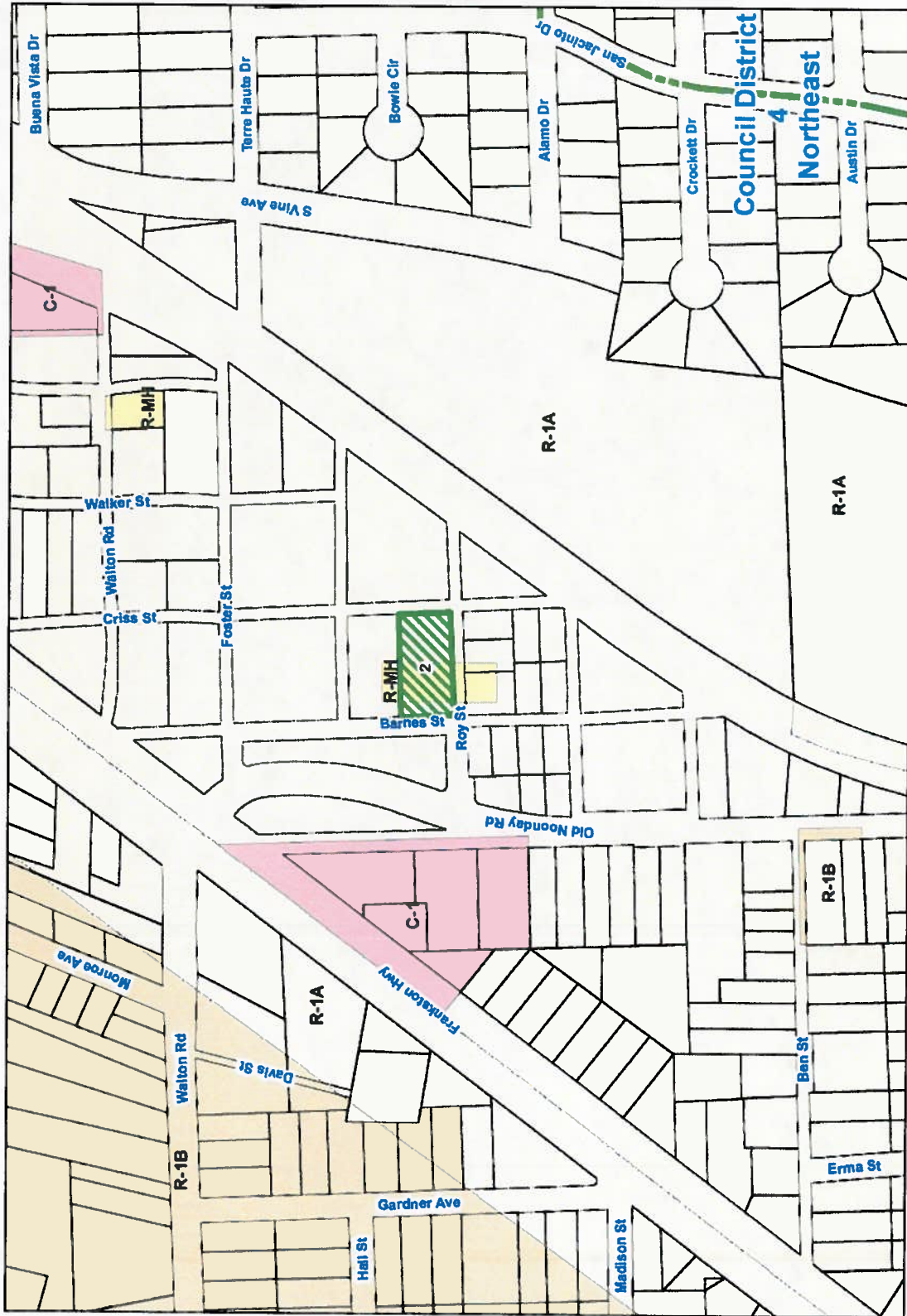

ZONING CASE
 Zoning Case #: Z16-015
 Existing Zoning: R-MH Proposed Zoning: R-1A
 Applicant: Guillermo Gomez

This product is for informational purposes and may not have been prepared for or be suitable for legal, engineering, or surveying purposes. It does not represent an on-the-ground survey and boundaries are only the approximate relative location of property boundaries.

250 0 250 Feet

**ORDINANCE NO. O-2016-103
EXHIBIT "B"
TYLER 1st FUTURE LAND USE MAP**



 Subject Property

ZONING CASE
Zoning Case #: Z16-015
Existing Zoning: R-MH Proposed Zoning: R-1A
Applicant: Guillermo Gomez

This product is for informational purposes and may not have been prepared for or be suitable for legal, engineering, or surveying purposes. It does not represent an on-the-ground survey and represents only the approximate relative location of property boundaries.



**ORDINANCE NO. O-2016-103
EXHIBIT "C"
NOTIFICATION MAP**

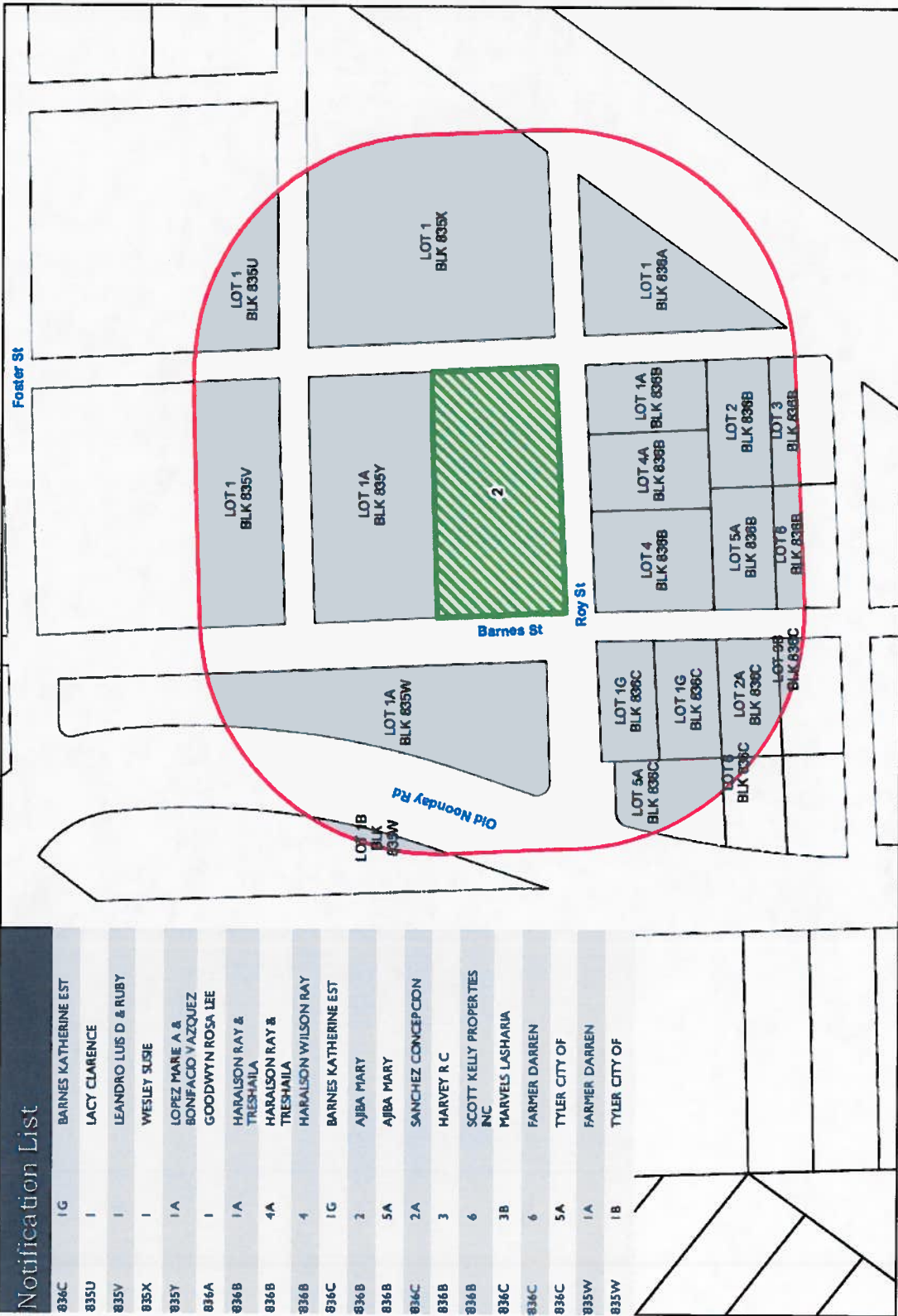

Notification List	
836C	1G BARNES KATHERINE EST
835U	1 LACY CLARENCE
835V	1 LEANDRO LUIS D & RUBY
835X	1 WESLEY SLISE
835Y	1A LOPEZ MARE A & BONIFACIO VAZQUEZ
836A	1 GOODWYN ROSA LEE
836B	1A HARALSON RAY & TRESHAILA
836B	4A HARALSON RAY & TRESHAILA
836B	4 HARALSON WILSON RAY
836C	1G BARNES KATHERINE EST
836B	2 AJIBA MARY
836B	5A AJIBA MARY
836C	2A SANCHEZ CONCEPCION
836B	3 HARVEY R C
836B	6 SCOTT KELLY PROPERTIES NC
836C	3B MARVELS LASHARIA
836C	6 FARMER DARREN
836C	5A TYLER CITY OF
835W	1A FARMER DARREN
835W	1B TYLER CITY OF



ZONING CASE
Zoning Case #: Z16-015
Existing Zoning: R-MH Proposed Zoning: R-1A
Applicant: Guillermo Gomez

This product is for informational purposes and may not have been prepared for or be suitable for legal, engineering, or surveying purposes. It does not represent an on-the-ground survey and represents only the approximate relative location of property boundaries.