

**STA 100+00  
BEGIN SPOKE 2 SPOKE 2**

**STA 100+00  
BEGIN SPOKE 2**

**SPOKE 2**

**SPOKE 6**

**SPOKE 2**

**STA 237+69  
END SPOKE 2**

**HUB**

**SPOKE 2**

**SPOKE 4**

**STA 191+71  
END SPOKE 2**

THIS DOCUMENT IS  
RELEASED FOR THE  
PURPOSE OF INTERIM  
REVIEW UNDER THE  
AUTHORITY OF MENA I.  
SOULIMAN, P.E. 136203  
ON APRIL 24, 2020. IT  
IS NOT TO BE USED FOR  
CONSTRUCTION, BIDDING  
OR PERMIT PURPOSES.



**The University of Texas at  
TYLER**

**TYLER BIKE STRIPES  
SPOKE 2 VICINITY MAP**

FED. AD. DIV. NO.	FEDERAL AID PROJECT NO.	SHT. NO.	
6.	STP 2019 (290)	S2-0	
STATE	STATE DIST. NO.	COUNTY	
TEXAS	10	SMITH	
CONT.	SECT.	JOB	HIGHWAY NO.
0910	16	144	CS

EXISTING CONDITIONS			
Roadway Name	Station	Number of Lanes	Lane Widths*
Garden Valley Rd.	100+00-120+00	4	11' - 11.5'

\* Distances are measured from the edge of the pavement, excluding the gutter.

PROPOSED CONDITIONS				
Roadway Name	Station	Number of Lanes	Lane Widths*	Bicycle Lane Width*
Garden Valley Rd.	100+00-120+00	4	11' - 11.5'	0'

\* Distances are measured from the edge of the pavement, excluding the gutter.

**LEGEND**

- EXISTING ROW
- PROPOSED SIGN

- NOTES:
- \* CONTRACTOR TO VERIFY LOCATION OF EXISTING SIDEWALKS AND DRIVEWAYS
  - \* CONTRACTOR TO VERIFY LOCATION OF EXISTING SIGNAGE TO ENSURE PROPER SIGN SPACING.

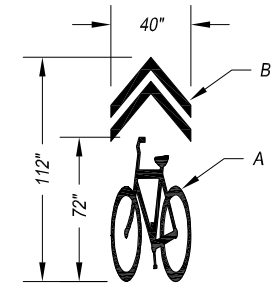

**SHARED LANE PAVEMENT MARKING DETAIL**

- A - PREFAB PAV MRK TY C (W) (BICYCLE SYML)
- B - PREFAB PAV MRK TY C (W) (CHEVRONS)

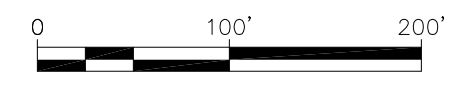
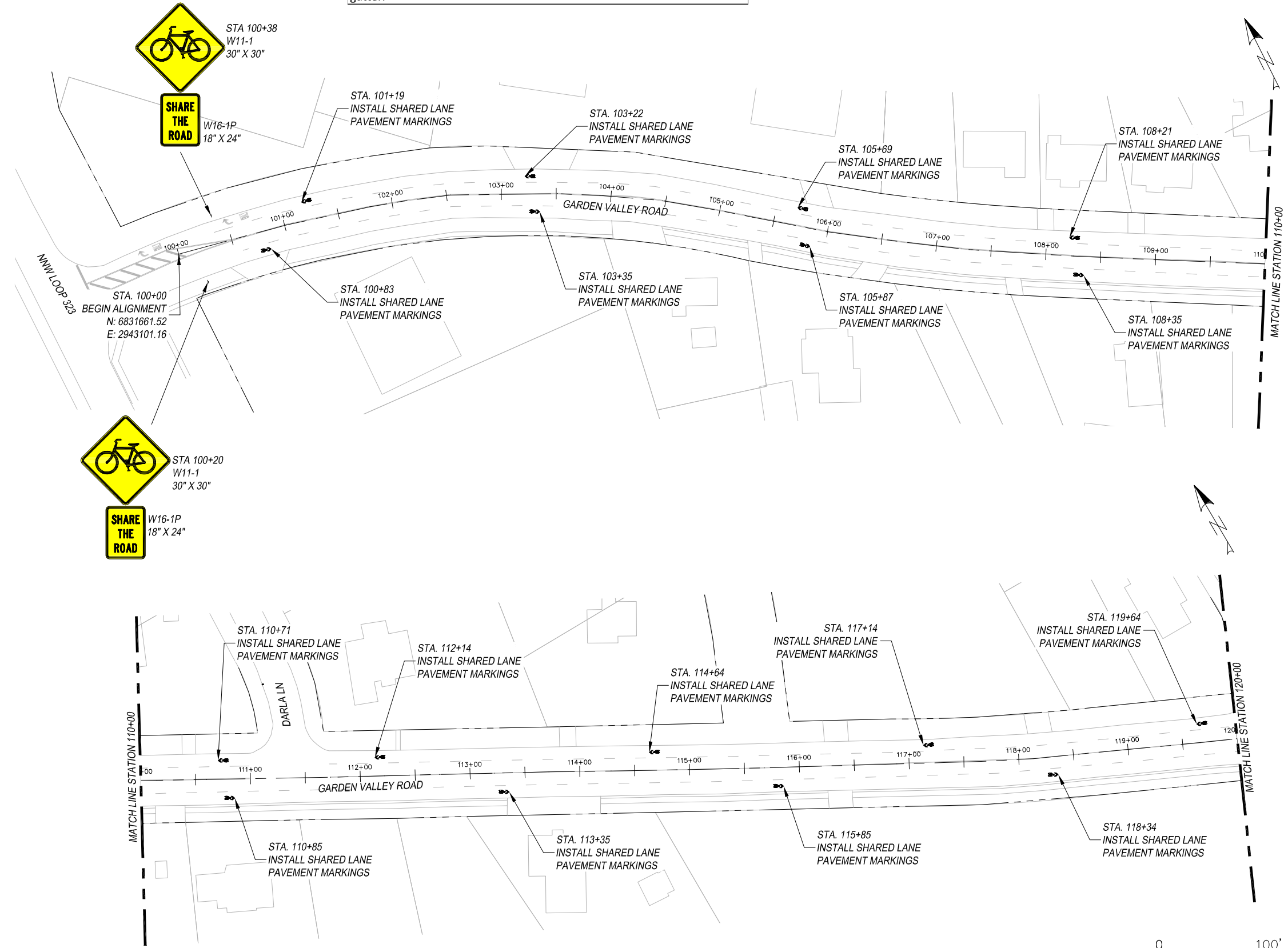

THIS DOCUMENT IS RELEASED FOR THE PURPOSE OF INTERIM REVIEW UNDER THE AUTHORITY OF MENA I. SOULIMAN, P.E. 136203 ON APRIL 24, 2020. IT IS NOT TO BE USED FOR CONSTRUCTION, BIDDING OR PERMIT PURPOSES.



TYLER BIKE STRIPES  
SPOKE 2  
SCALE: 1" = 100'

FED. AD. DIV. NO.	FEDERAL AID PROJECT NO.	SHT. NO.	
6.	STP 2019 (290)	S2-1	
STATE	STATE DIST. NO.	COUNTY	
TEXAS	10	SMITH	
CONT.	SECT.	JOB	HIGHWAY NO.
0910	16	144	CS

EXISTING CONDITIONS			
Roadway Name	Station	Number of Lanes	Lane Widths*
Garden Valley Rd.	120+00-140+00	4	11'-13'

\* Distances are measured from the edge of the pavement, excluding the gutter.

PROPOSED CONDITIONS				
Roadway Name	Station	Number of Lanes	Lane Widths*	Bicycle Lane Width*
Garden Valley Rd.	120+00-140+00	4	11'-13'	0'

\* Distances are measured from the edge of the pavement, excluding the gutter.

### LEGEND

- EXISTING ROW
- PROPOSED SIGN

#### NOTES:

- \* CONTRACTOR TO VERIFY LOCATION OF EXISTING SIDEWALKS AND DRIVEWAYS
- \* CONTRACTOR TO VERIFY LOCATION OF EXISTING SIGNAGE TO ENSURE PROPER SIGN SPACING.

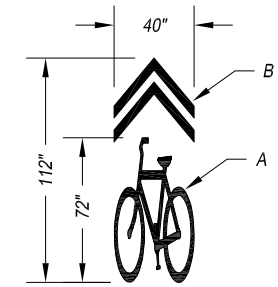
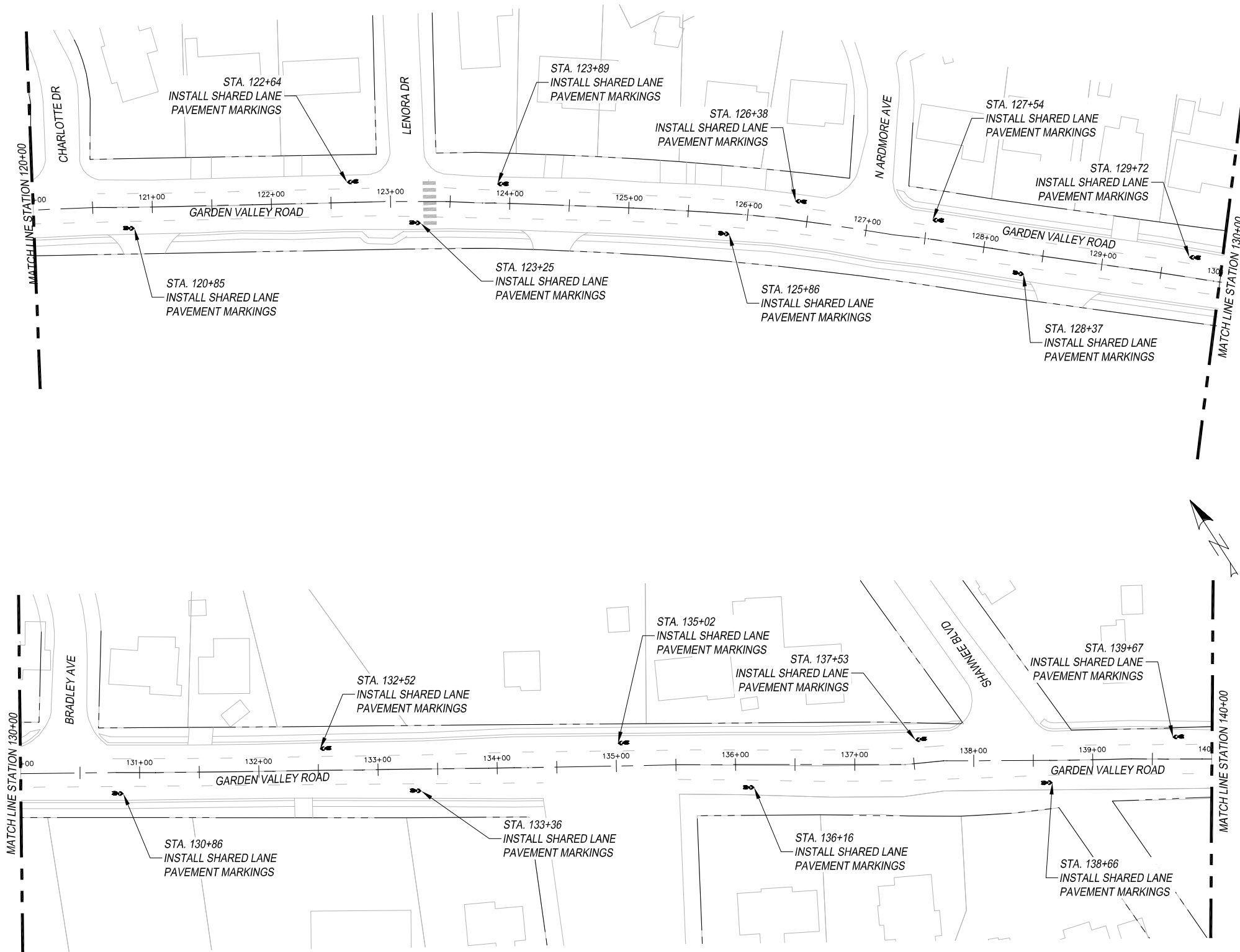

**SHARED LANE PAVEMENT MARKING DETAIL**

- A – PREFAB PAV MRK TY C (W) (BICYCLE SYML)
- B – PREFAB PAV MRK TY C (W) (CHEVRONS)

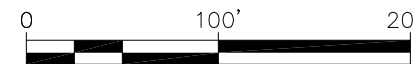

THIS DOCUMENT IS RELEASED FOR THE PURPOSE OF INTERIM REVIEW UNDER THE AUTHORITY OF MENA I. SOULIMAN, P.E. 136203 ON APRIL 24, 2020. IT IS NOT TO BE USED FOR CONSTRUCTION, BIDDING OR PERMIT PURPOSES.



### TYLER BIKE STRIPES SPOKE 2

SCALE: 1" = 100'

FED. AD. DIV. NO.	FEDERAL AID PROJECT NO.	SHT. NO.	
6.	STP 2019 (290)	S2-2	
STATE	STATE DIST. NO.	COUNTY	
TEXAS	10	SMITH	
CONT.	SECT.	JOB	HIGHWAY NO.
0910	16	144	CS



EXISTING CONDITIONS			
Roadway Name	Station	Number of Lanes	Lane Widths*
Garden Valley Rd.	140+00-160+00	4	11'-12.5'

\* Distances are measured from the edge of the pavement, excluding the gutter.

PROPOSED CONDITIONS				
Roadway Name	Station	Number of Lanes	Lane Widths*	Bicycle Lane Width*
Garden Valley Rd.	140+00-160+00	4	11'-12.5'	0'

\* Distances are measured from the edge of the pavement, excluding the gutter.

### LEGEND

- EXISTING ROW
- PROPOSED SIGN

- NOTES:
- \* CONTRACTOR TO VERIFY LOCATION OF EXISTING SIDEWALKS AND DRIVEWAYS
  - \* CONTRACTOR TO VERIFY LOCATION OF EXISTING SIGNAGE TO ENSURE PROPER SIGN SPACING.

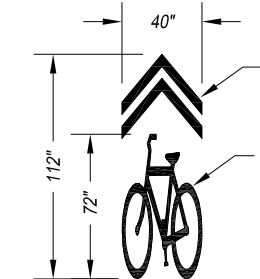
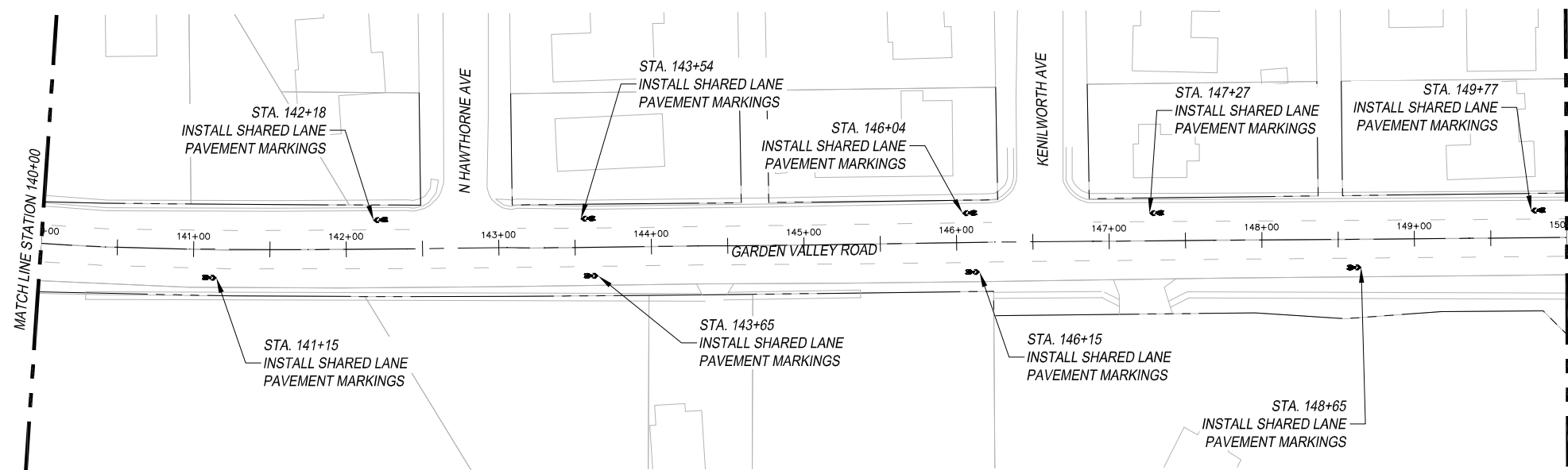

**SHARED LANE PAVEMENT MARKING DETAIL**  
 A – PREFAB PAV MRK TY C (W) (BICYCLE SYML)  
 B – PREFAB PAV MRK TY C (W) (CHEVRONS)

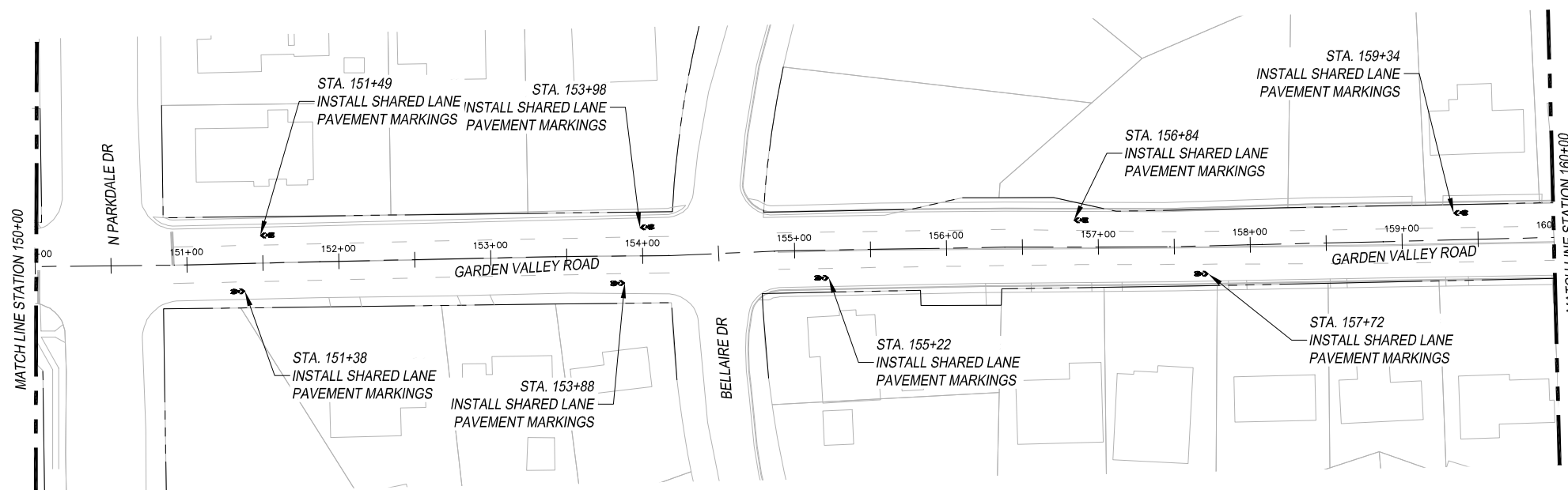

THIS DOCUMENT IS RELEASED FOR THE PURPOSE OF INTERIM REVIEW UNDER THE AUTHORITY OF MENA I. SOULIMAN, P.E. 136203 ON APRIL 24, 2020. IT IS NOT TO BE USED FOR CONSTRUCTION, BIDDING OR PERMIT PURPOSES.



### TYLER BIKE STRIPES SPOKE 2

SCALE: 1" = 100'

FED. AD. DIV. NO.	FEDERAL AID PROJECT NO.	SHT. NO.	
6.	STP 2019 (290)	S2-3	
STATE	STATE DIST. NO.	COUNTY	
TEXAS	10	SMITH	
CONT.	SECT.	JOB	HIGHWAY NO.
0910	16	144	CS



EXISTING CONDITIONS			
Roadway Name	Station	Number of Lanes	Lane Widths*
Garden Valley Rd.	160+00-180+00	4	10'-11.5'

\* Distances are measured from the edge of the pavement, excluding the gutter.

PROPOSED CONDITIONS				
Roadway Name	Station	Number of Lanes	Lane Widths*	Bicycle Lane Width*
Garden Valley Rd.	160+00-180+00	4	10'-11.5'	0'

\* Distances are measured from the edge of the pavement, excluding the gutter.

### LEGEND

- EXISTING ROW
- PROPOSED SIGN

- NOTES:
- \* CONTRACTOR TO VERIFY LOCATION OF EXISTING SIDEWALKS AND DRIVEWAYS
  - \* CONTRACTOR TO VERIFY LOCATION OF EXISTING SIGNAGE TO ENSURE PROPER SIGN SPACING.

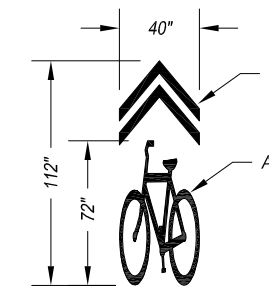
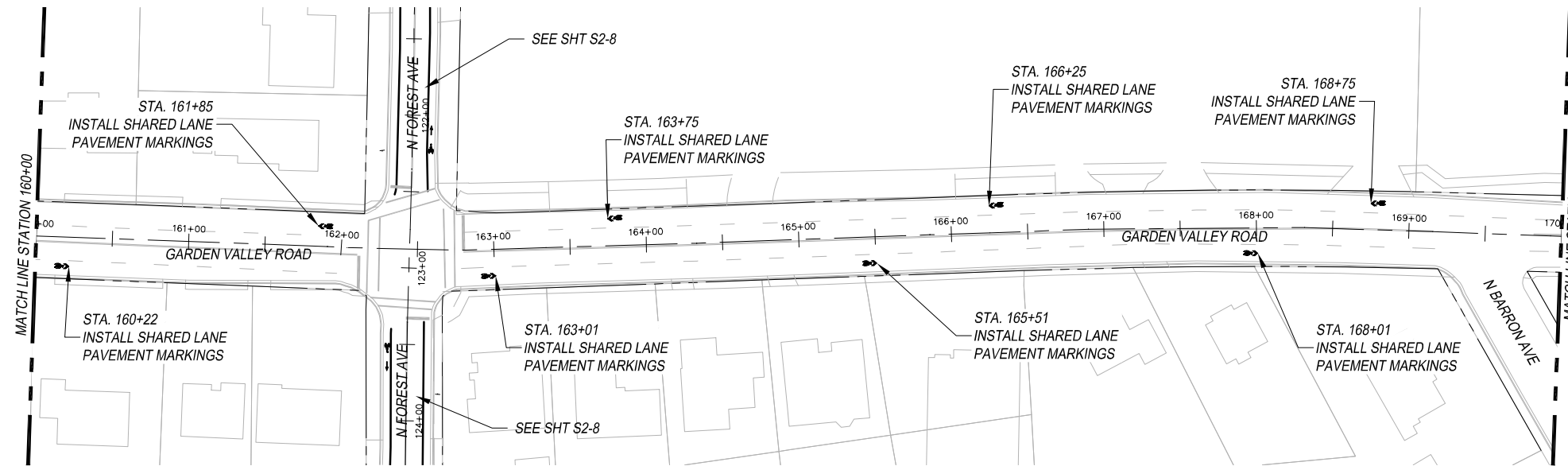

**SHARED LANE  
PAVEMENT MARKING DETAIL**

A – PREFAB PAV MRK TY C (W) (BICYCLE SYML)  
B – PREFAB PAV MRK TY C (W) (CHEVRONS)

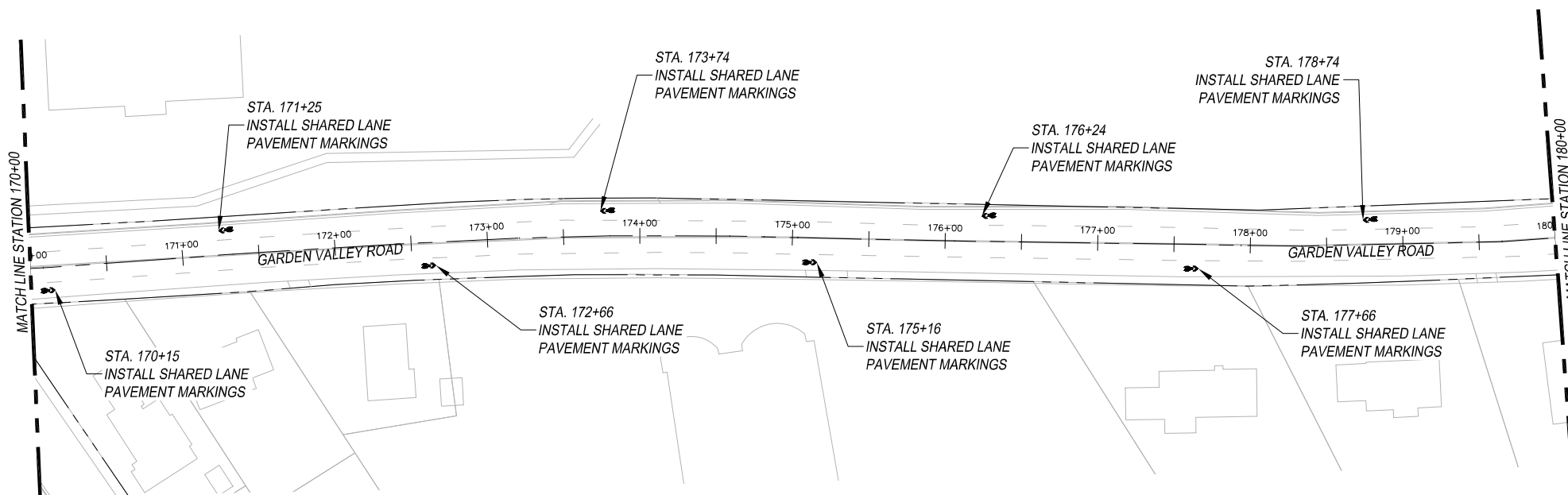

THIS DOCUMENT IS RELEASED FOR THE PURPOSE OF INTERIM REVIEW UNDER THE AUTHORITY OF MENA I. SOULIMAN, P.E. 136203 ON APRIL 24, 2020. IT IS NOT TO BE USED FOR CONSTRUCTION, BIDDING OR PERMIT PURPOSES.



### TYLER BIKE STRIPES SPOKE 2 SCALE: 1" = 100'

FED. AD. DIV. NO.	FEDERAL AID PROJECT NO.	SHT. NO.	
6.	STP 2019 (290)	S2-4	
STATE	STATE DIST. NO.	COUNTY	
TEXAS	10	SMITH	
CONT.	SECT.	JOB	HIGHWAY NO.
0910	16	144	CS

EXISTING CONDITIONS			
Roadway Name	Station	Number of Lanes	Lane Widths*
Garden Valley Rd	180+00-182+00	4	10.5'-11.5'
Garden Valley Rd	182+00-184+00	4	11.5'-17'
Garden Valley Rd	184+00-188+50	3	12'-12.5'
Garden Valley Rd	188+50-192+00	2	18.5'-19'
Gaston Ave.	192+00-194+00	2	16.5'-19'
W. Oakwood St.	194+00-200+00	2	16.5'-19'

\* Distances are measured from the edge of the pavement, excluding the gutter.

PROPOSED CONDITIONS				
Roadway Name	Station	Number of Lanes	Lane Widths*	Bicycle Lane Width*
Garden Valley Rd	180+00-182+00	4	10.5'-11.5'	0'
Garden Valley Rd	182+00-184+00	4	11.5'-17'	0'
Garden Valley Rd	184+00-188+50	3	12'-12.5'	0'
Garden Valley Rd	188+50-192+00	2	13.5'-14'	5'
Gaston Ave.	192+00-194+00	2	11.5'-14'	5'
W. Oakwood St.	194+00-200+00	2	11.5'-14'	5'

\* Distances are measured from the edge of the pavement, excluding the gutter.

### LEGEND

- EXISTING ROW
- PROPOSED SIGN

#### NOTES:

- \* CONTRACTOR TO VERIFY LOCATION OF EXISTING SIDEWALKS AND DRIVEWAYS
- \* CONTRACTOR TO VERIFY LOCATION OF EXISTING SIGNAGE TO ENSURE PROPER SIGN SPACING.

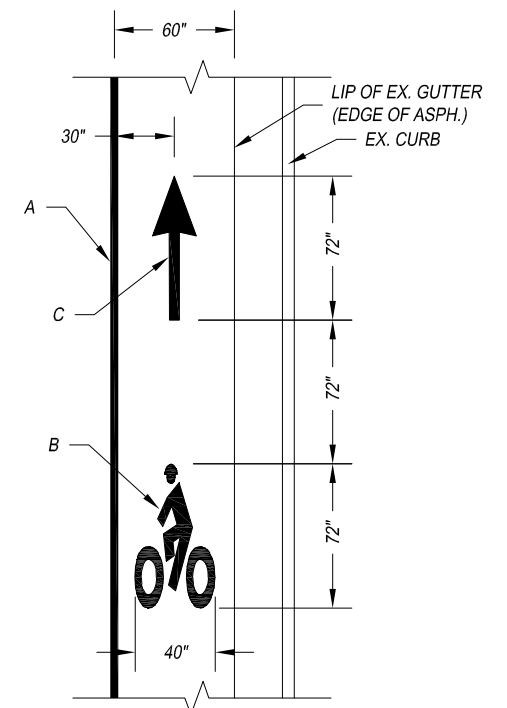
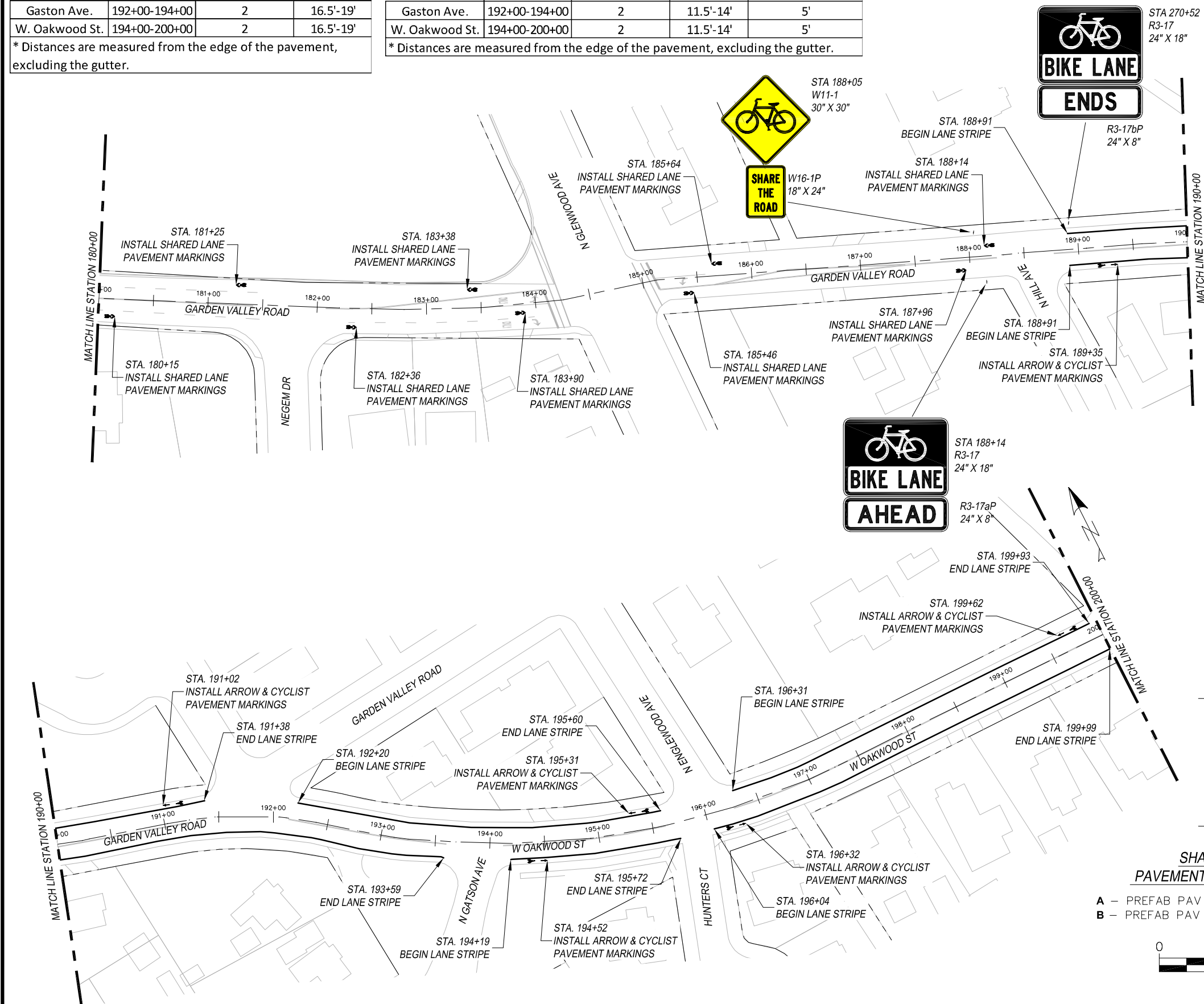

**ARROW & CYCLIST PAVEMENT MARKING DETAIL**

- A - REFL PAV MRK TY I (W) 4" (SLD)
- B - PREFAB PAV MRK TY C (W) (BIKE SYML)
- C - PREFAB PAV MRK TY C (W) (BIKE ARROW)

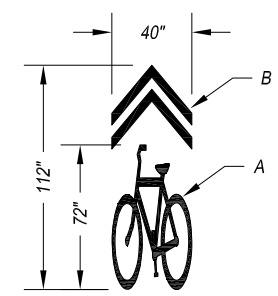

**SHARED LANE PAVEMENT MARKING DETAIL**

- A - PREFAB PAV MRK TY C (W) (BICYCLE SYML)
- B - PREFAB PAV MRK TY C (W) (CHEVRONS)



THIS DOCUMENT IS RELEASED FOR THE PURPOSE OF INTERIM REVIEW UNDER THE AUTHORITY OF MENA I. SOULIMAN, P.E. 136203 ON APRIL 24, 2020. IT IS NOT TO BE USED FOR CONSTRUCTION, BIDDING OR PERMIT PURPOSES.



### TYLER BIKE STRIPES SPOKE 2 SCALE: 1" = 100'

FED. AD. DIV. NO.	FEDERAL AID PROJECT NO.	SHT. NO.	
6.	STP 2019 (290)	S2-5	
STATE	STATE DIST. NO.	COUNTY	
TEXAS	10	SMITH	
CONT.	SECT.	JOB	HIGHWAY NO.
0910	16	144	CS

EXISTING CONDITIONS			
Roadway Name	Station	Number of Lanes	Lane Widths*
W. Oakwood St.	200+00-211+00	2	18.9'-19.7'
W. Oakwood St.	211+00-216+50	3	12.6'-13.2'
W. Oakwood St.	216+50-220+00	2	14.7'-16.4'

\* Distances are measured from the edge of the pavement, excluding the gutter.

PROPOSED CONDITIONS				
Roadway Name	Station	Number of Lanes	Lane Widths*	Bicycle Lane Width*
W. Oakwood St.	200+00-211+00	2	13.9'-14.7'	5'
W. Oakwood St.	211+00-216+50	3	12.6'-13.2'	0'
W. Oakwood St.	216+50-220+00	2	9.7'-11.4'	5'

\* Distances are measured from the edge of the pavement, excluding the gutter.

### LEGEND

- EXISTING ROW
- PROPOSED SIGN

- NOTES:
- \* CONTRACTOR TO VERIFY LOCATION OF EXISTING SIDEWALKS AND DRIVEWAYS
  - \* CONTRACTOR TO VERIFY LOCATION OF EXISTING SIGNAGE TO ENSURE PROPER SIGN SPACING.

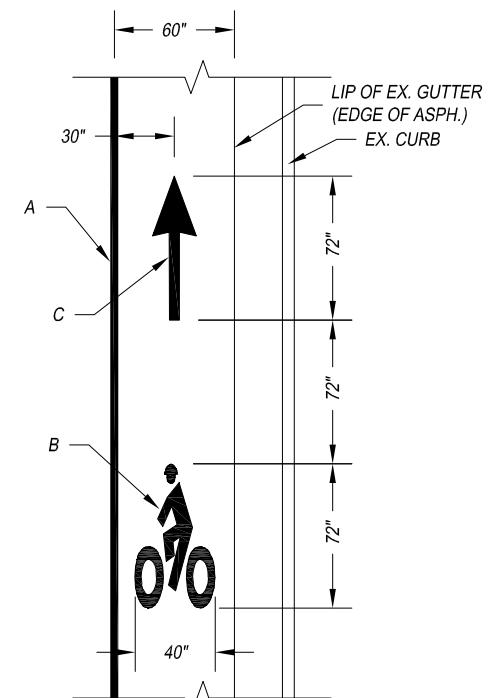
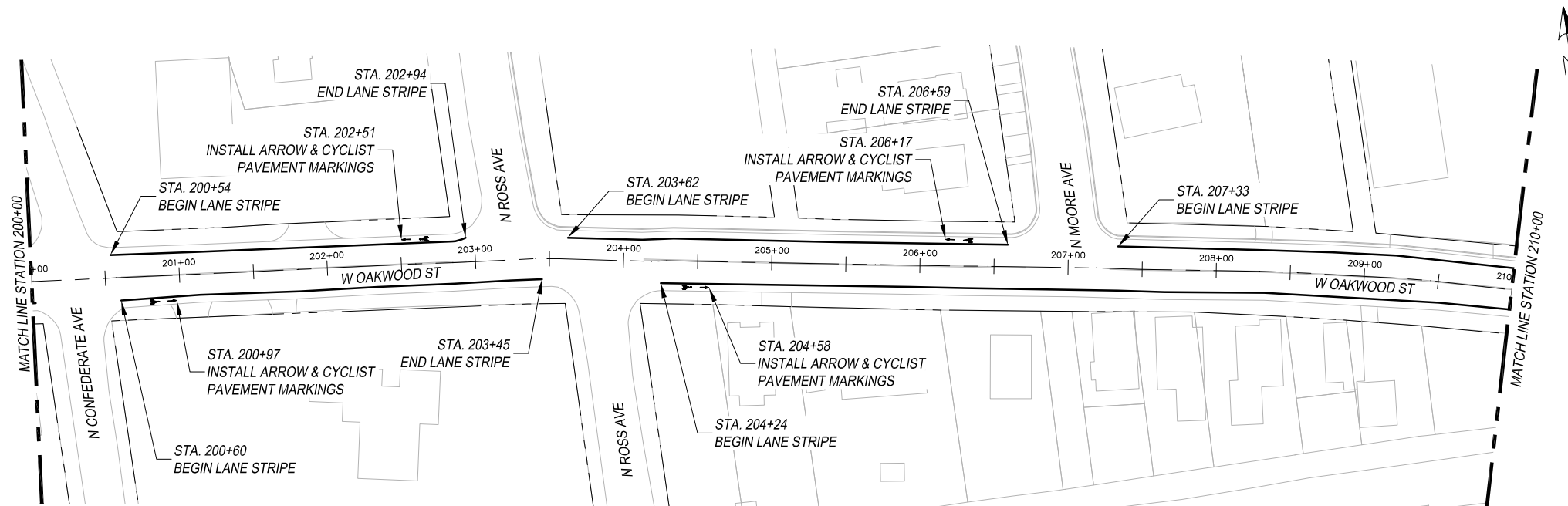

- ARROW & CYCLIST PAVEMENT MARKING DETAIL**
- A - REFL PAV MRK TY I (W) 4" (SLD)
  - B - PREFAB PAV MRK TY C (W) (BIKE SYML)
  - C - PREFAB PAV MRK TY C (W) (BIKE ARROW)

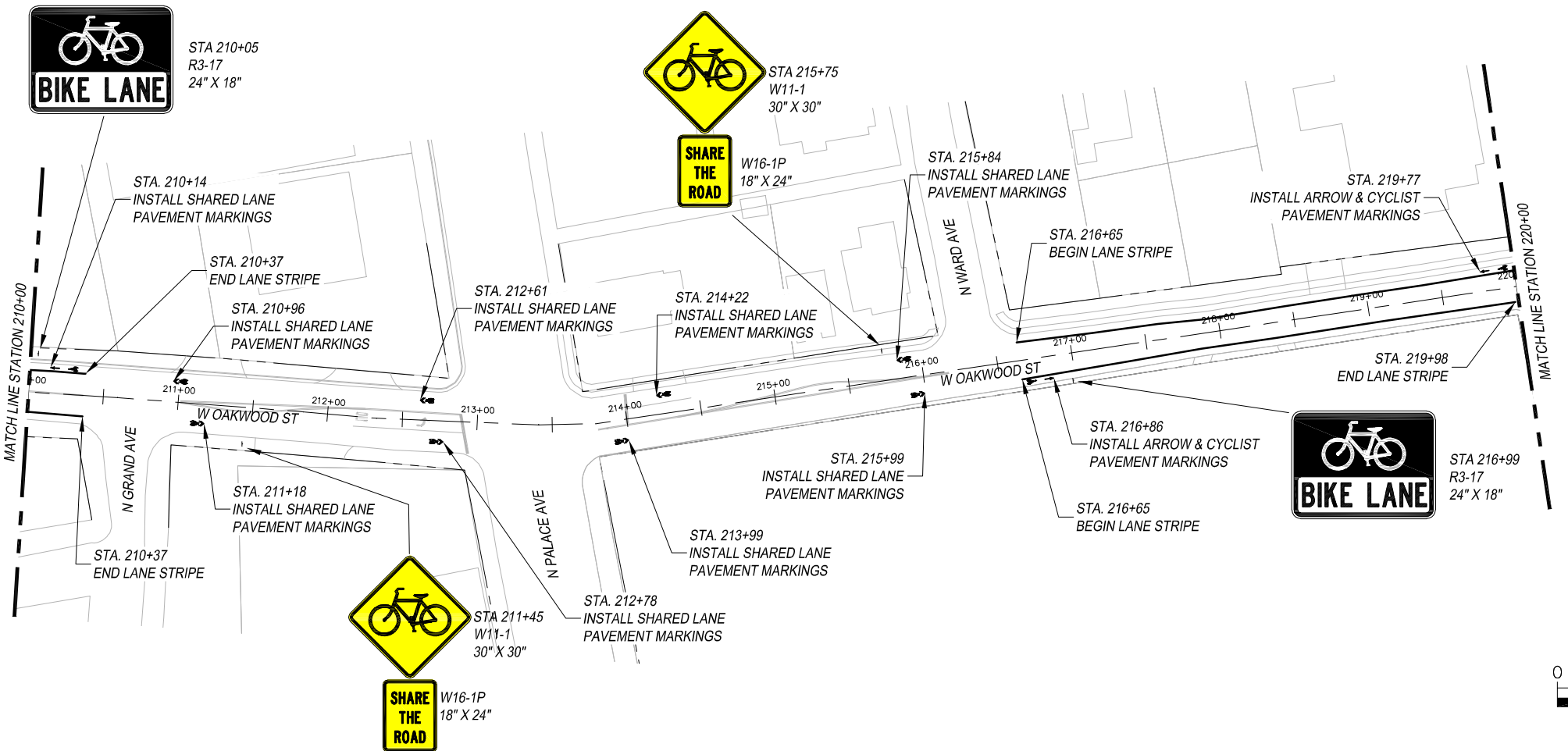

THIS DOCUMENT IS RELEASED FOR THE PURPOSE OF INTERIM REVIEW UNDER THE AUTHORITY OF MENA I. SOULIMAN, P.E. 136203 ON APRIL 24, 2020. IT IS NOT TO BE USED FOR CONSTRUCTION, BIDDING OR PERMIT PURPOSES.



The University of Texas at  
**TYLER**

TYLER BIKE STRIPES  
SPOKE 2  
SCALE: 1" = 100'

FED. AD. DIV. NO.	FEDERAL AID PROJECT NO.	SHT. NO.	
6.	STP 2019 (290)	S2-6	
STATE	STATE DIST. NO.	COUNTY	
TEXAS	10	SMITH	
CONT.	SECT.	JOB	HIGHWAY NO.
0910	16	144	CS



EXISTING CONDITIONS				
Roadway Name	Station	Number of Lanes	Lane Widths*	Parking Lane Width*
W. Oakwood St.	220+00-226+28	2	15.1'-17.1'	0
N. Bonner Ave.	226+28-230+00	2	19.1'-20'	0
N. Bonner Ave.	230+00-234+00	2	18.9'-19.7'	0
N. Bonner Ave.	234+00-236+25	2	11.9'-12.2'	8' (One-Side)
N. Bonner Ave.	236+25-236+75	2	11.9'-12.2'	8' (Both Sides)
N. Bonner Ave.	236+75-237+63	2	11.9'-12.2'	8' (One-Side)

\* Distances are measured from the edge of the pavement, excluding the gutter.



STA 212+45  
R3-17  
24" X 18"

STA. 225+14  
INSTALL ARROW & CYCLIST  
PAVEMENT MARKINGS

STA. 225+50  
END LANE STRIPE

STA. 226+28  
END ALIGNMENT  
N: 6827000.51  
E: 2954595.67

STA. 226+87  
BEGIN LANE STRIPE

STA. 226+94  
BEGIN LANE STRIPE

STA. 227+06  
INSTALL ARROW & CYCLIST  
PAVEMENT MARKINGS

STA. 225+49  
END LANE STRIPE

STA. 224+04  
INSTALL ARROW & CYCLIST  
PAVEMENT MARKINGS

STA. 223+75  
BEGIN LANE STRIPE

STA. 223+68  
END LANE STRIPE

STA. 223+43  
INSTALL ARROW & CYCLIST  
PAVEMENT MARKINGS

STA. 220+02  
END LANE STRIPE

STA. 220+52  
BEGIN LANE STRIPE

STA. 220+76  
INSTALL ARROW & CYCLIST  
PAVEMENT MARKINGS

STA. 220+50  
BEGIN LANE STRIPE



STA 234+13  
R3-17  
24" X 18"

R3-17aP  
24" X 8"

PROPOSED CONDITIONS					
Roadway Name	Station	Number of Lanes	Lane Widths*	Bicycle Lane Width*	Parking Lane Width*
W. Oakwood St.	220+00-226+28	2	10.1'-12.15'	5'	0
N. Bonner Ave.	226+28-230+00	2	14.15'-15'	5'	0
N. Bonner Ave.	230+00-234+00	2	13.9'-14.7'	5'	0
N. Bonner Ave.	234+00-236+25	2	11.9'-12.2'	0'	8' (One-Side)
N. Bonner Ave.	236+25-236+75	2	11.9'-12.2'	0'	8' (Both Sides)
N. Bonner Ave.	236+75-237+63	2	11.9'-12.2'	0	8' (One-Side)

\* Distances are measured from the edge of the pavement, excluding the gutter.

STA. 234+71  
INSTALL SHARED LANE  
PAVEMENT MARKINGS

STA. 237+21  
INSTALL SHARED LANE  
PAVEMENT MARKINGS

STA. 237+69  
END ALIGNMENT  
N: 6825899.15  
E: 2954818.85

STA. 233+13  
INSTALL ARROW & CYCLIST  
PAVEMENT MARKINGS

STA. 233+47  
END LANE STRIPE

STA. 234+61  
INSTALL SHARED LANE  
PAVEMENT MARKINGS

STA. 234+65  
W11-1  
30" X 30"



W16-1P  
18" X 24"



STA 233+32  
R3-17  
24" X 18"

R3-17bP  
24" X 8"

### LEGEND

- EXISTING ROW
- PROPOSED SIGN

### NOTES:

- \* CONTRACTOR TO VERIFY LOCATION OF EXISTING SIDEWALKS AND DRIVEWAYS
- \* CONTRACTOR TO VERIFY LOCATION OF EXISTING SIGNAGE TO ENSURE PROPER SIGN SPACING.

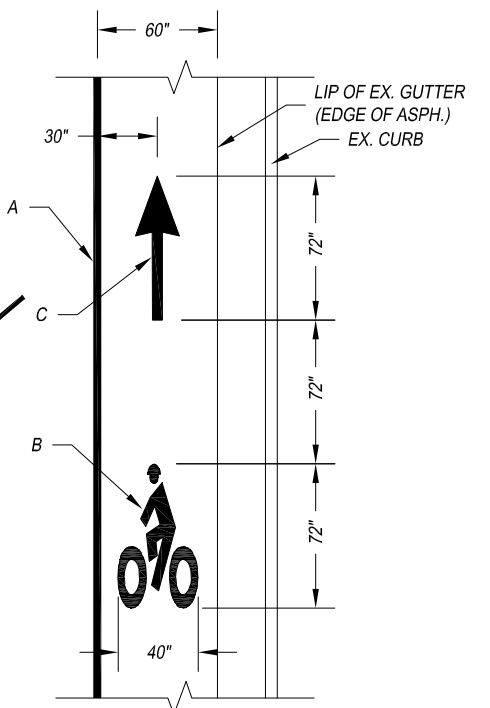

ARROW & CYCLIST PAVEMENT MARKING DETAIL

- A - REFL PAV MRK TY I (W) 4" (SLD)
- B - PREFAB PAV MRK TY C (W) (BIKE SYML)
- C - PREFAB PAV MRK TY C (W) (BIKE ARROW)

THIS DOCUMENT IS RELEASED FOR THE PURPOSE OF INTERIM REVIEW UNDER THE AUTHORITY OF MENA I. SOULIMAN, P.E. 136203 ON APRIL 24, 2020. IT IS NOT TO BE USED FOR CONSTRUCTION, BIDDING OR PERMIT PURPOSES.



TYLER BIKE STRIPES  
SPOKE 2  
SCALE: 1" = 100'

FED. AD. DIV. NO.	FEDERAL AID PROJECT NO.	SHT. NO.	
6.	STP 2019 (290)	S2-7	
STATE	STATE DIST. NO.	COUNTY	
TEXAS	10	SMITH	
CONT.	SECT.	JOB	HIGHWAY NO.
0910	16	144	CS

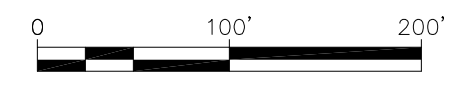

EXISTING CONDITIONS			
Roadway Name	Station	Number of Lanes	Lane Widths*
N. Forest Ave.	100+00-120+00	2	14'-17.5'

\* Distances are measured from the edge of the pavement, excluding the gutter.

PROPOSED CONDITIONS				
Roadway Name	Station	Number of Lanes	Lane Widths*	Bicycle Lane Width*
N. Forest Ave.	100+00-120+00	2	9'-12.5'	5'

\* Distances are measured from the edge of the pavement, excluding the gutter.

### LEGEND

- EXISTING ROW
- PROPOSED SIGN

#### NOTES:

- \* CONTRACTOR TO VERIFY LOCATION OF EXISTING SIDEWALKS AND DRIVEWAYS
- \* CONTRACTOR TO VERIFY LOCATION OF EXISTING SIGNAGE TO ENSURE PROPER SIGN SPACING.



STA 100+99  
R3-17  
24" X 18"



STA 100+90  
R3-17  
24" X 18"

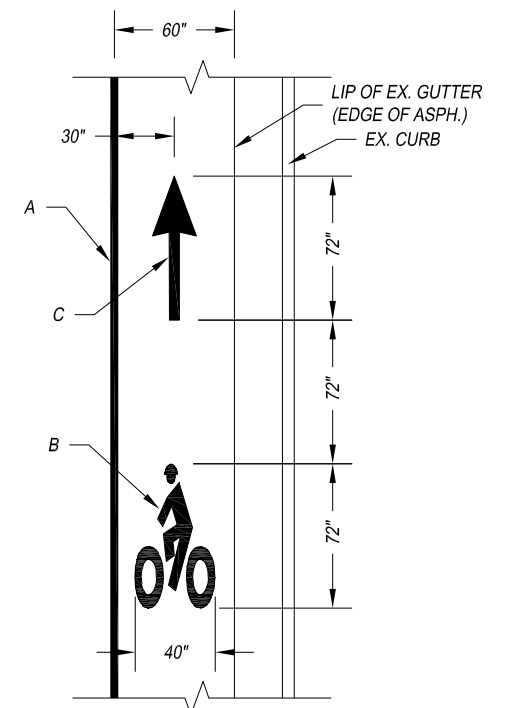
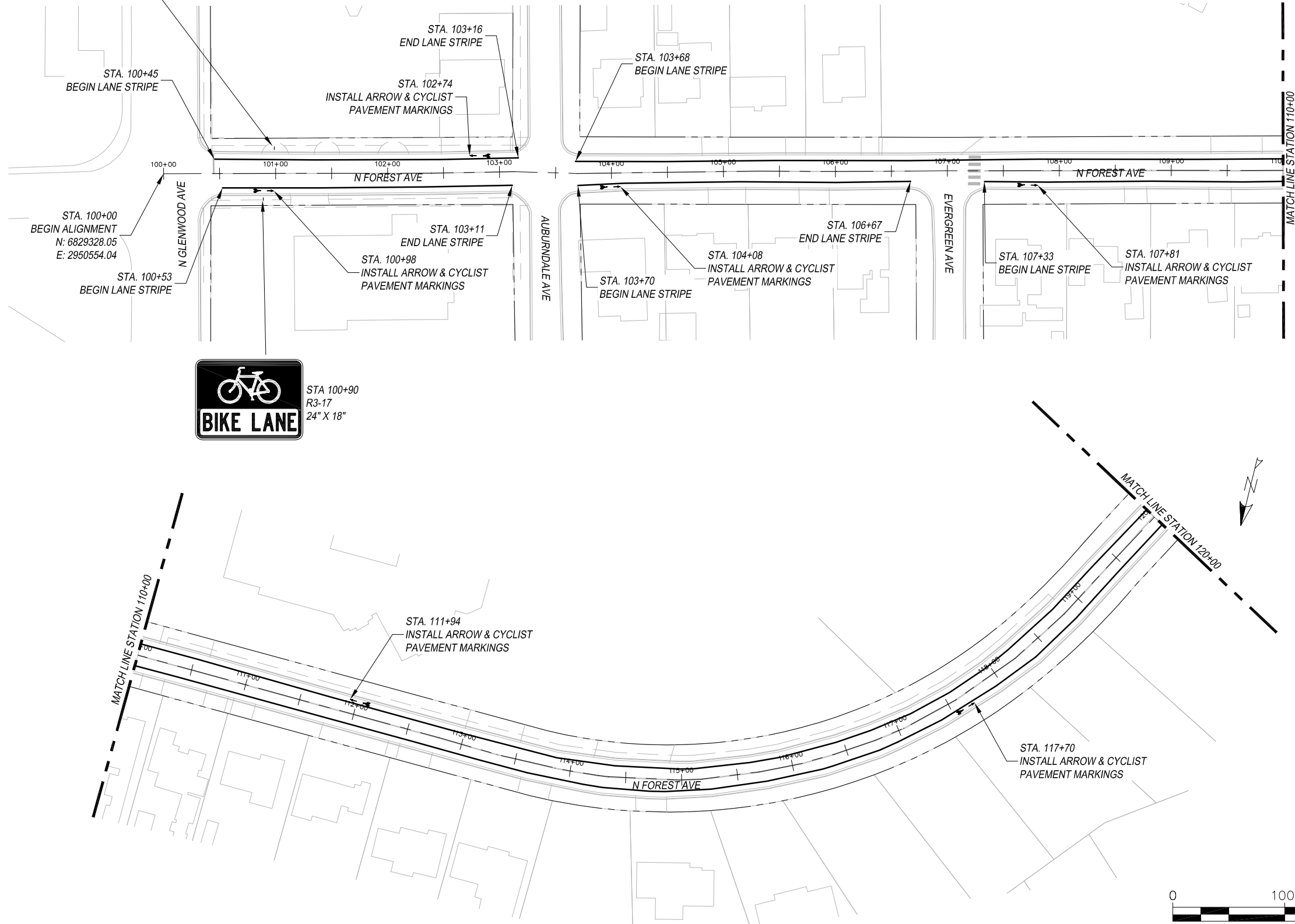

**ARROW & CYCLIST PAVEMENT MARKING DETAIL**

- A - REFL PAV MRK TY I (W) 4" (SLD)
- B - PREFAB PAV MRK TY C (W) (BIKE SYML)
- C - PREFAB PAV MRK TY C (W) (BIKE ARROW)

THIS DOCUMENT IS RELEASED FOR THE PURPOSE OF INTERIM REVIEW UNDER THE AUTHORITY OF MENA I. SOULIMAN, P.E. 136203 ON APRIL 24, 2020. IT IS NOT TO BE USED FOR CONSTRUCTION, BIDDING OR PERMIT PURPOSES.



TYLER BIKE STRIPES  
SPOKE 2  
SCALE: 1" = 100'

FED. AD. DIV. NO.	FEDERAL AID PROJECT NO.	SHT. NO.	
6.	STP 2019 (290)	S2-8	
STATE	STATE DIST. NO.	COUNTY	
TEXAS	10	SMITH	
CONT.	SECT.	JOB	HIGHWAY NO.
0910	16	144	CS

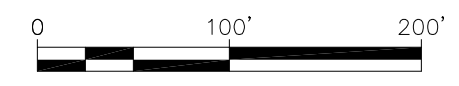

EXISTING CONDITIONS			
Roadway Name	Station	Number of Lanes	Lane Widths*
N. Forest Ave.	120+00-140+00	2	14'-17.5'

\* Distances are measured from the edge of the pavement, excluding the gutter.

PROPOSED CONDITIONS				
Roadway Name	Station	Number of Lanes	Lane Widths*	Bicycle Lane Width*
N. Forest Ave.	120+00-140+00	2	9'-12.5'	5'

\* Distances are measured from the edge of the pavement, excluding the gutter.

### LEGEND

- EXISTING ROW
- PROPOSED SIGN

#### NOTES:

- \* CONTRACTOR TO VERIFY LOCATION OF EXISTING SIDEWALKS AND DRIVEWAYS
- \* CONTRACTOR TO VERIFY LOCATION OF EXISTING SIGNAGE TO ENSURE PROPER SIGN SPACING.

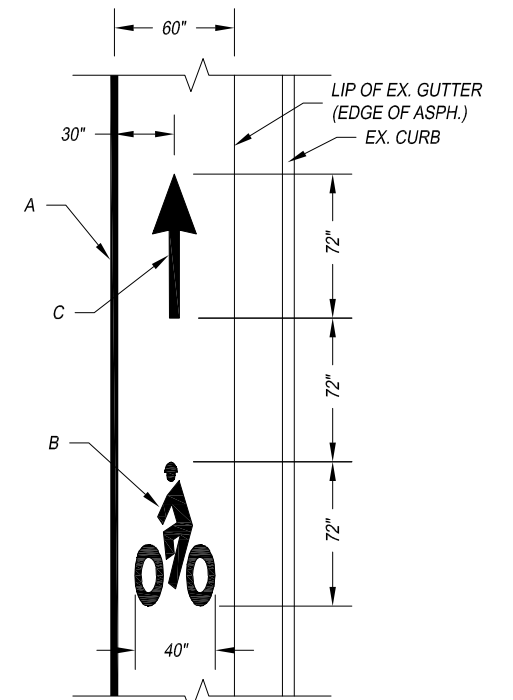
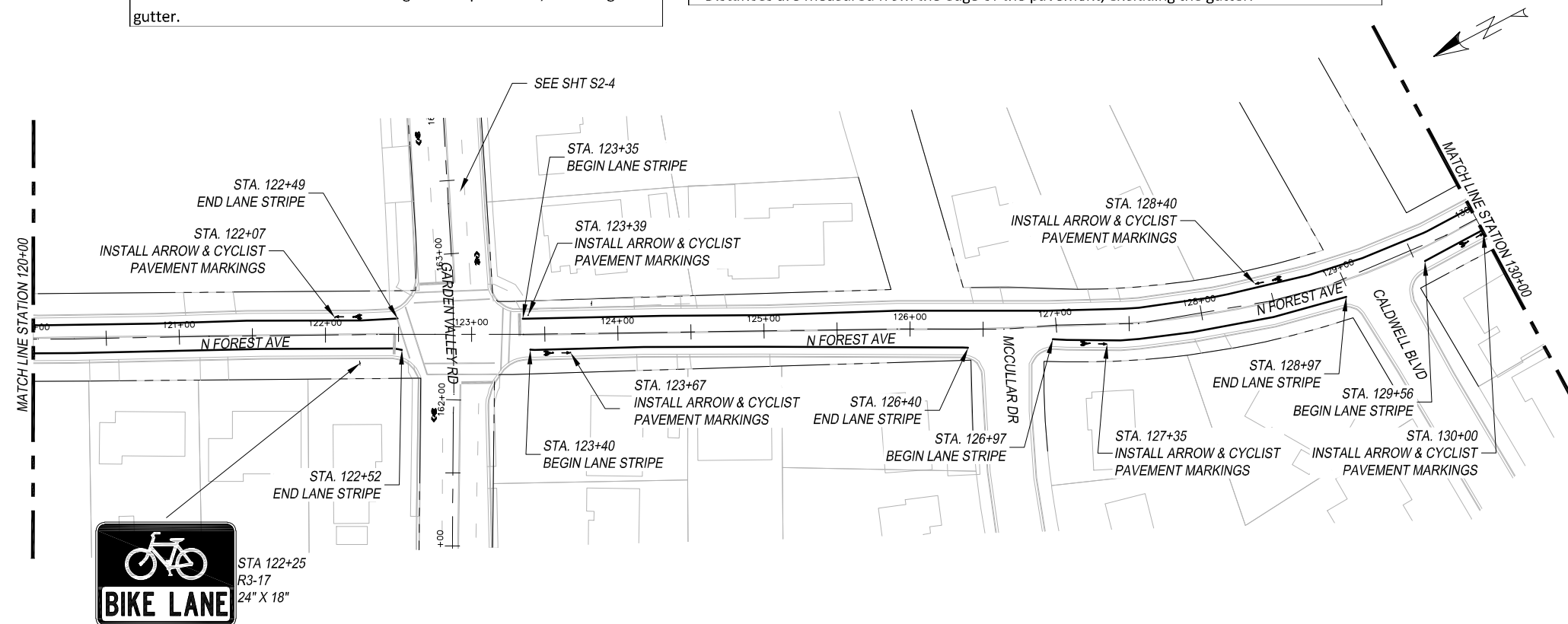

**ARROW & CYCLIST PAVEMENT MARKING DETAIL**

- A - REFL PAV MRK TY I (W) 4" (SLD)
- B - PREFAB PAV MRK TY C (W) (BIKE SYML)
- C - PREFAB PAV MRK TY C (W) (BIKE ARROW)

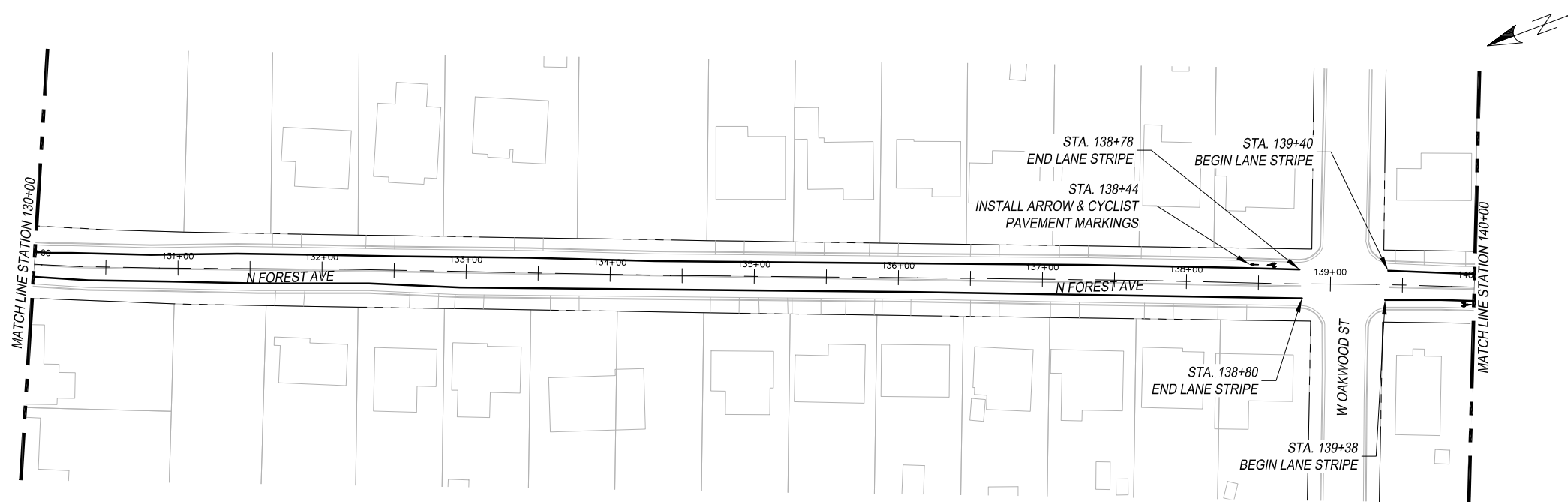

THIS DOCUMENT IS RELEASED FOR THE PURPOSE OF INTERIM REVIEW UNDER THE AUTHORITY OF MENA I. SOULIMAN, P.E. 136203 ON APRIL 24, 2020. IT IS NOT TO BE USED FOR CONSTRUCTION, BIDDING OR PERMIT PURPOSES.



TYLER BIKE STRIPES  
SPOKE 2  
SCALE: 1" = 100'

FED. AD. DIV. NO.	FEDERAL AID PROJECT NO.	SHT. NO.	
6.	STP 2019 (290)	S2-9	
STATE	STATE DIST. NO.	COUNTY	
TEXAS	10	SMITH	
CONT.	SECT.	JOB	HIGHWAY NO.
0910	16	144	CS



EXISTING CONDITIONS			
Roadway Name	Station	Number of Lanes	Lane Widths*
N. Forest Ave.	140+00-160+00	2	14'-16'

\* Distances are measured from the edge of the pavement, excluding the gutter.

PROPOSED CONDITIONS				
Roadway Name	Station	Number of Lanes	Lane Widths*	Bicycle Lane Width*
N. Forest Ave.	140+00-160+00	2	9'-11'	5'

\* Distances are measured from the edge of the pavement, excluding the gutter.

### LEGEND

- EXISTING ROW
- PROPOSED SIGN

- NOTES:
- \* CONTRACTOR TO VERIFY LOCATION OF EXISTING SIDEWALKS AND DRIVEWAYS
  - \* CONTRACTOR TO VERIFY LOCATION OF EXISTING SIGNAGE TO ENSURE PROPER SIGN SPACING.

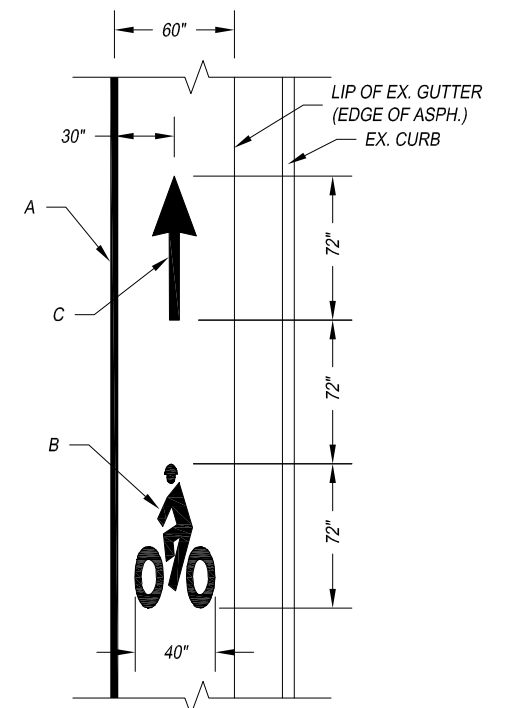
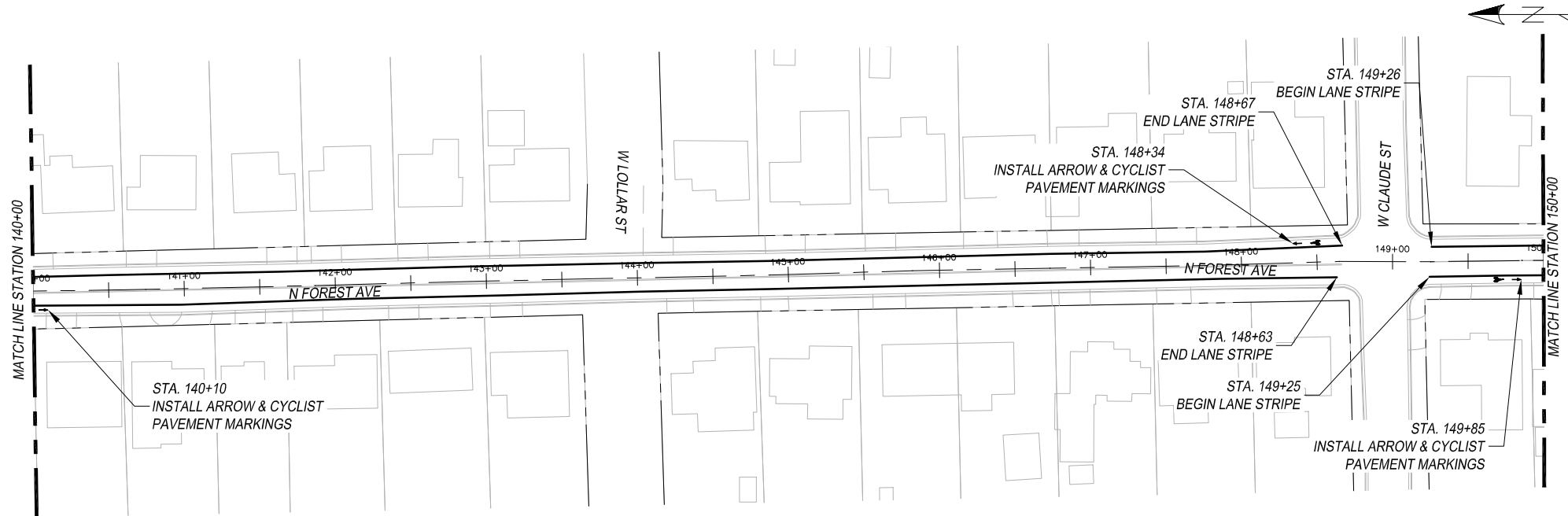

**ARROW & CYCLIST PAVEMENT MARKING DETAIL**

- A - REFL PAV MRK TY I (W) 4" (SLD)
- B - PREFAB PAV MRK TY C (W) (BIKE SYML)
- C - PREFAB PAV MRK TY C (W) (BIKE ARROW)

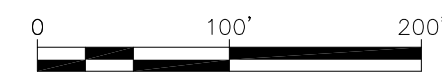
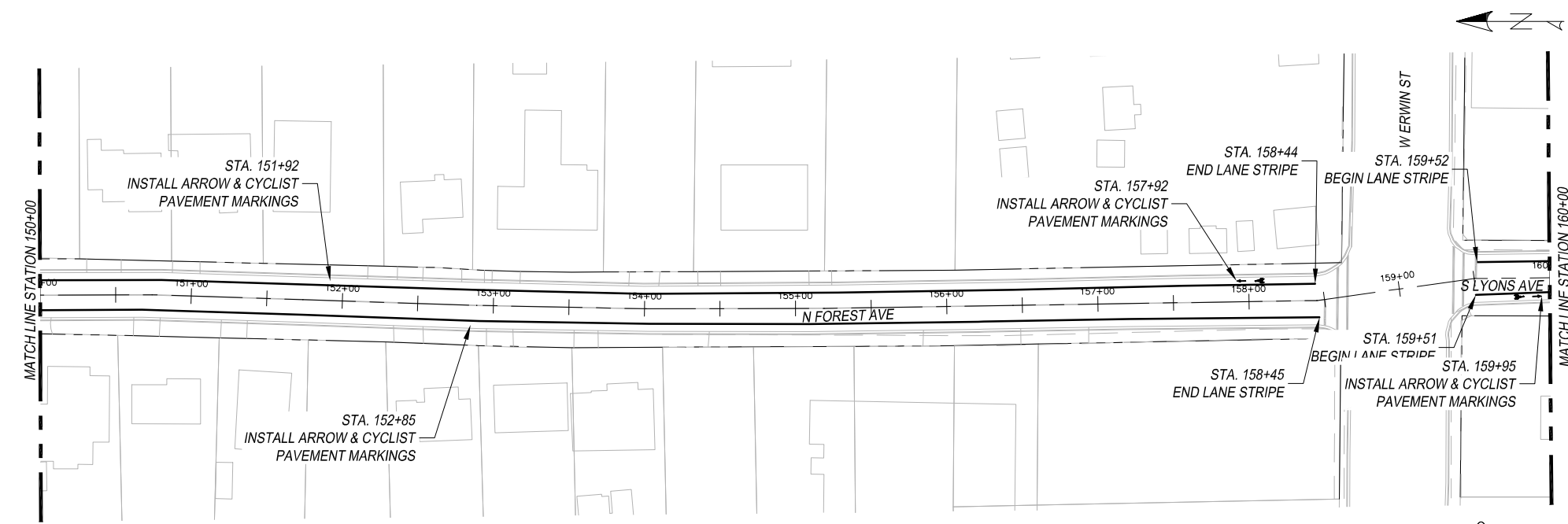

THIS DOCUMENT IS RELEASED FOR THE PURPOSE OF INTERIM REVIEW UNDER THE AUTHORITY OF MENA I. SOULIMAN, P.E. 136203 ON APRIL 24, 2020. IT IS NOT TO BE USED FOR CONSTRUCTION, BIDDING OR PERMIT PURPOSES.



## TYLER BIKE STRIPES SPOKE 2

SCALE: 1" = 100'

FED. AD. DIV. NO.	FEDERAL AID PROJECT NO.	SHT. NO.	
6.	STP 2019 (290)	S2-10	
STATE	STATE DIST. NO.	COUNTY	
TEXAS	10	SMITH	
CONT.	SECT.	JOB	HIGHWAY NO.
0910	16	144	CS

EXISTING CONDITIONS			
Roadway Name	Station	Number of Lanes	Lane Widths*
S. Lyons Ave.	160+00-173+00	2	14.5'-15'
S. Lyons Ave.	173+00-175+00	3	12'-12.5'
S. Lyons Ave.	175+00-180+00	2	18'-18.5'

\* Distances are measured from the edge of the pavement, excluding the gutter.

PROPOSED CONDITIONS				
Roadway Name	Station	Number of Lanes	Lane Widths*	Bicycle Lane Width*
S. Lyons Ave.	160+00-173+00	2	9.5'-10'	5'
S. Lyons Ave.	173+00-175+00	3	12'-12.5'	0'
S. Lyons Ave.	175+00-180+00	2	13'-13.5'	5'

\* Distances are measured from the edge of the pavement, excluding the gutter.

### LEGEND

- EXISTING ROW
- PROPOSED SIGN

- NOTES:
- \* CONTRACTOR TO VERIFY LOCATION OF EXISTING SIDEWALKS AND DRIVEWAYS
  - \* CONTRACTOR TO VERIFY LOCATION OF EXISTING SIGNAGE TO ENSURE PROPER SIGN SPACING.

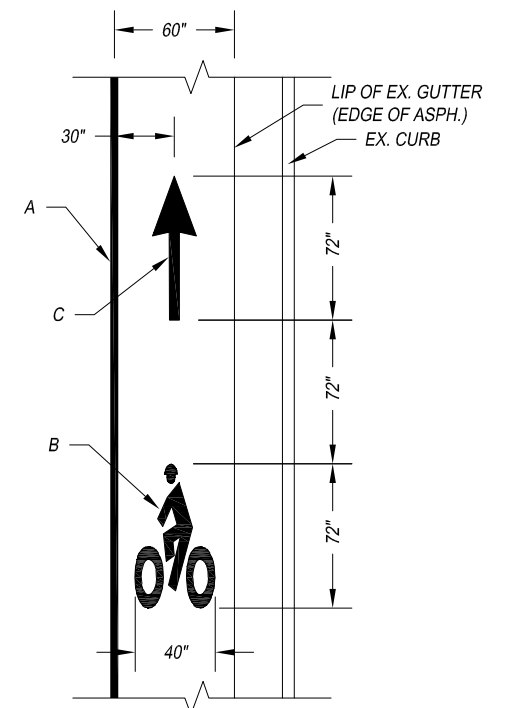
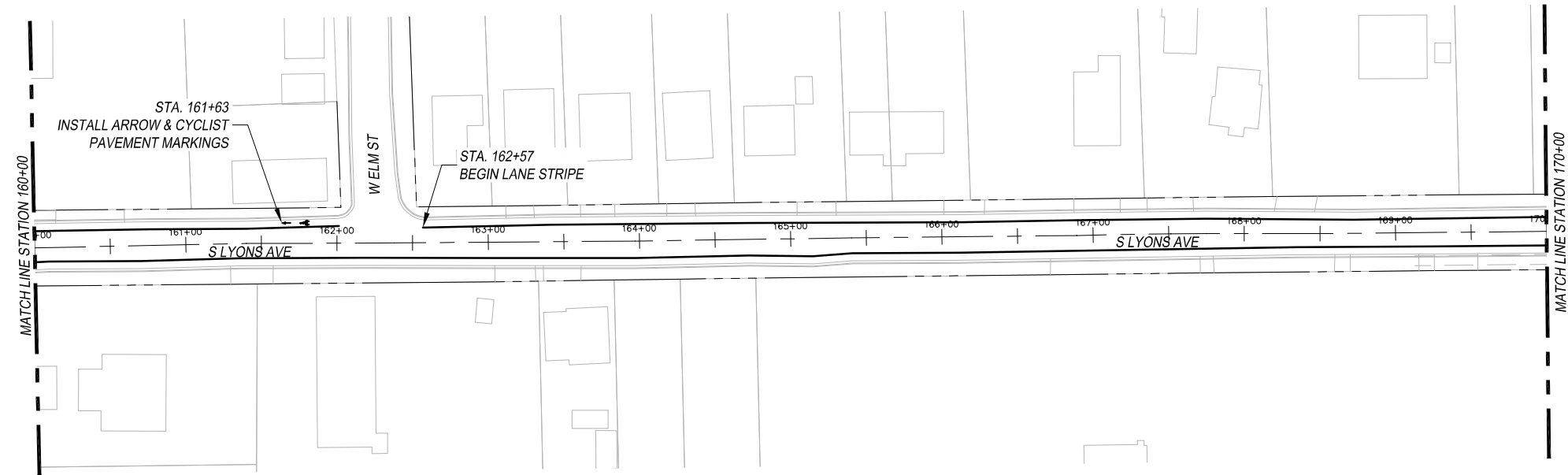

**ARROW & CYCLIST PAVEMENT MARKING DETAIL**

- A - REFL PAV MRK TY I (W) 4" (SLD)
- B - PREFAB PAV MRK TY C (W) (BIKE SYML)
- C - PREFAB PAV MRK TY C (W) (BIKE ARROW)

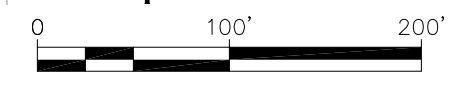
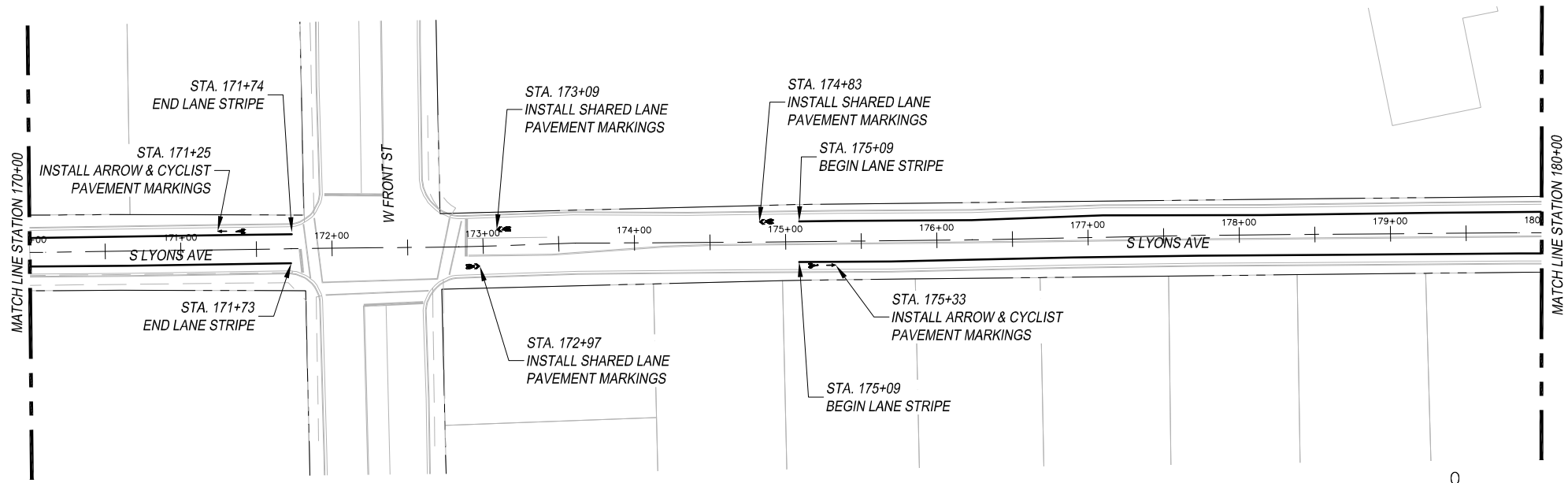

THIS DOCUMENT IS RELEASED FOR THE PURPOSE OF INTERIM REVIEW UNDER THE AUTHORITY OF MENA I. SOULIMAN, P.E. 136203 ON APRIL 24, 2020. IT IS NOT TO BE USED FOR CONSTRUCTION, BIDDING OR PERMIT PURPOSES.



### TYLER BIKE STRIPES SPOKE 2 SCALE: 1" = 100'

FED. AD. DIV. NO.	FEDERAL AID PROJECT NO.	SHT. NO.	
6.	STP 2019 (290)	S2-11	
STATE	STATE DIST. NO.	COUNTY	
TEXAS	10	SMITH	
CONT.	SECT.	JOB	HIGHWAY NO.
0910	16	144	CS

EXISTING CONDITIONS			
Roadway Name	Station	Number of Lanes	Lane Widths*
S. Lyons Ave.	180+00+191+71	2	18.5'-19'

\* Distances are measured from the edge of the pavement, excluding the gutter.

PROPOSED CONDITIONS				
Roadway Name	Station	Number of Lanes	Lane Widths*	Bicycle Lane Width*
S. Lyons Ave.	180+00+191+71	2	13.5'-14'	5'

\* Distances are measured from the edge of the pavement, excluding the gutter.

### LEGEND

- EXISTING ROW
- PROPOSED SIGN

- NOTES:
- \* CONTRACTOR TO VERIFY LOCATION OF EXISTING SIDEWALKS AND DRIVEWAYS
  - \* CONTRACTOR TO VERIFY LOCATION OF EXISTING SIGNAGE TO ENSURE PROPER SIGN SPACING.

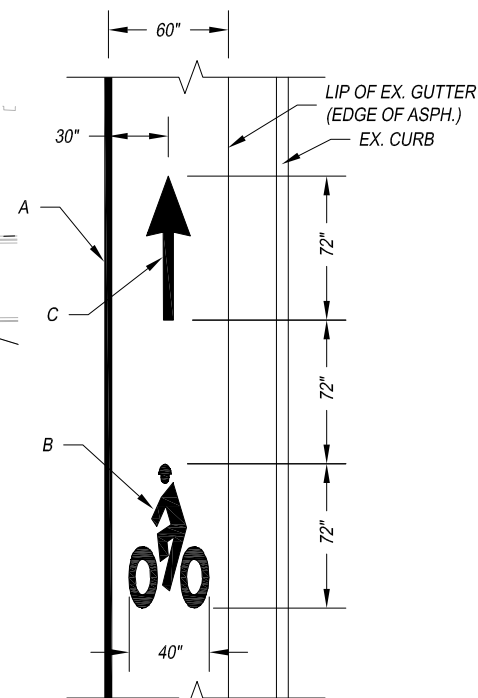
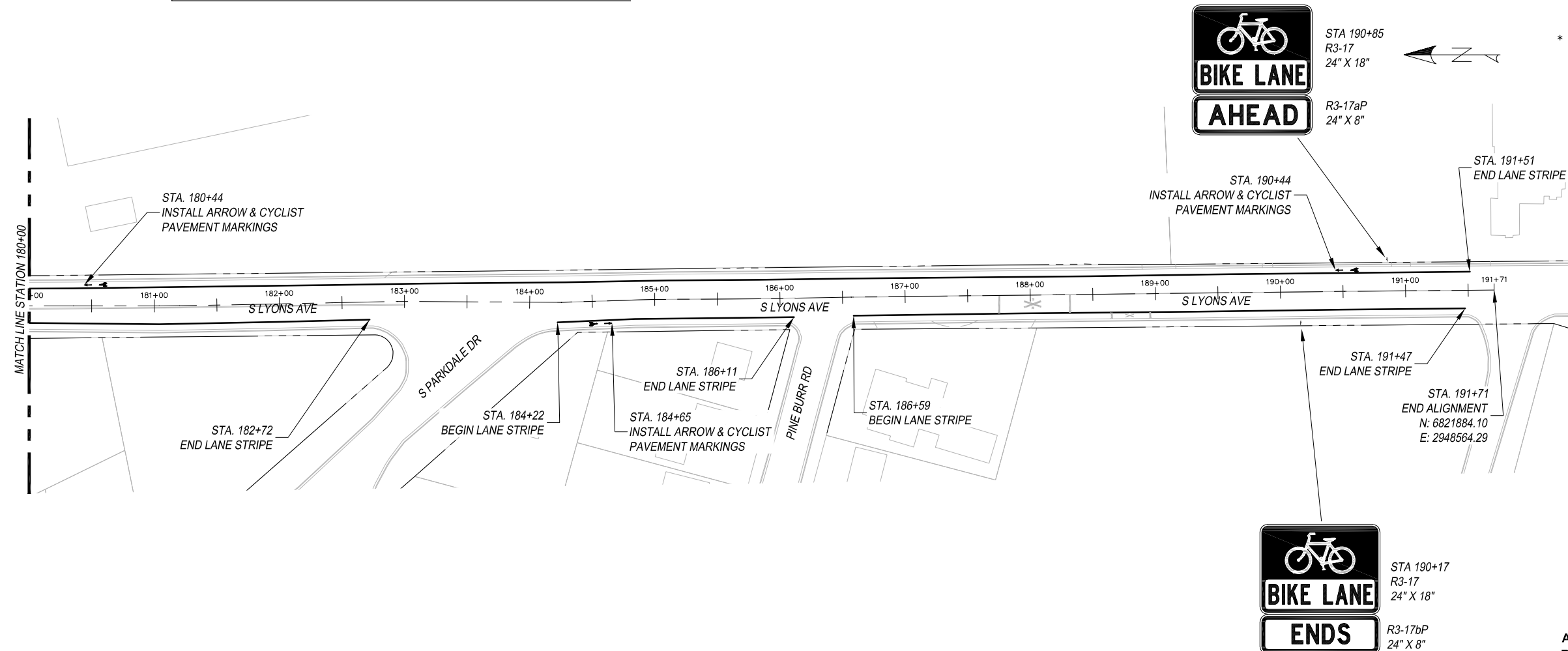

- ARROW & CYCLIST PAVEMENT MARKING DETAIL**
- A - REFL PAV MRK TY I (W) 4" (SLD)
  - B - PREFAB PAV MRK TY C (W) (BIKE SYML)
  - C - PREFAB PAV MRK TY C (W) (BIKE ARROW)



THIS DOCUMENT IS RELEASED FOR THE PURPOSE OF INTERIM REVIEW UNDER THE AUTHORITY OF MENA I. SOULIMAN, P.E. 136203 ON APRIL 24, 2020. IT IS NOT TO BE USED FOR CONSTRUCTION, BIDDING OR PERMIT PURPOSES.



TYLER BIKE STRIPES  
SPOKE 2  
SCALE: 1" = 100'

FED. AD. DIV. NO.	FEDERAL AID PROJECT NO.	SHT. NO.	
6.	STP 2019 (290)	S2-12	
STATE	STATE DIST. NO.	COUNTY	
TEXAS	10	SMITH	
CONT.	SECT.	JOB	HIGHWAY NO.
0910	16	144	CS