

THIS DOCUMENT IS RELEASED FOR THE PURPOSE OF INTERIM REVIEW UNDER THE AUTHORITY OF MENA I. SOULIMAN, P.E. 136203 ON APRIL 24, 2020. IT IS NOT TO BE USED FOR CONSTRUCTION, BIDDING OR PERMIT PURPOSES.



The University of Texas at  
**TYLER**

TYLER BIKE STRIPES  
 SPOKE 4 VICINITY MAP

FED. AD. DIV. NO.	FEDERAL AID PROJECT NO.	SHT. NO.	
6.	STP 2019 (290)	S4-0	
STATE	STATE DIST. NO.	COUNTY	
TEXAS	10	SMITH	
CONT.	SECT.	JOB	HIGHWAY NO.
0910	16	144	CS

EXISTING CONDITIONS			
Roadway Name	Station	Number of Lanes	Lane Widths*
Bellwood Rd	100+00-120+00	2	19.5'-20'

\* Distances are measured from the edge of the pavement, excluding the gutter.

PROPOSED CONDITIONS					
Roadway Name	Station	Number of Lanes	Lane Widths*	Bicycle Lane Width*	Buffer Width*
Bellwood Rd	100+00-120+00	2	12'-13'	5'	1.5'

\* Distances are measured from the edge of the pavement, excluding the gutter.

**LEGEND**  
 — EXISTING ROW  
 ○ PROPOSED SIGN

**NOTES:**  
 \* CONTRACTOR TO VERIFY LOCATION OF EXISTING SIDEWALKS AND DRIVEWAYS  
 \* CONTRACTOR TO VERIFY LOCATION OF EXISTING SIGNAGE TO ENSURE PROPER SIGN SPACING.

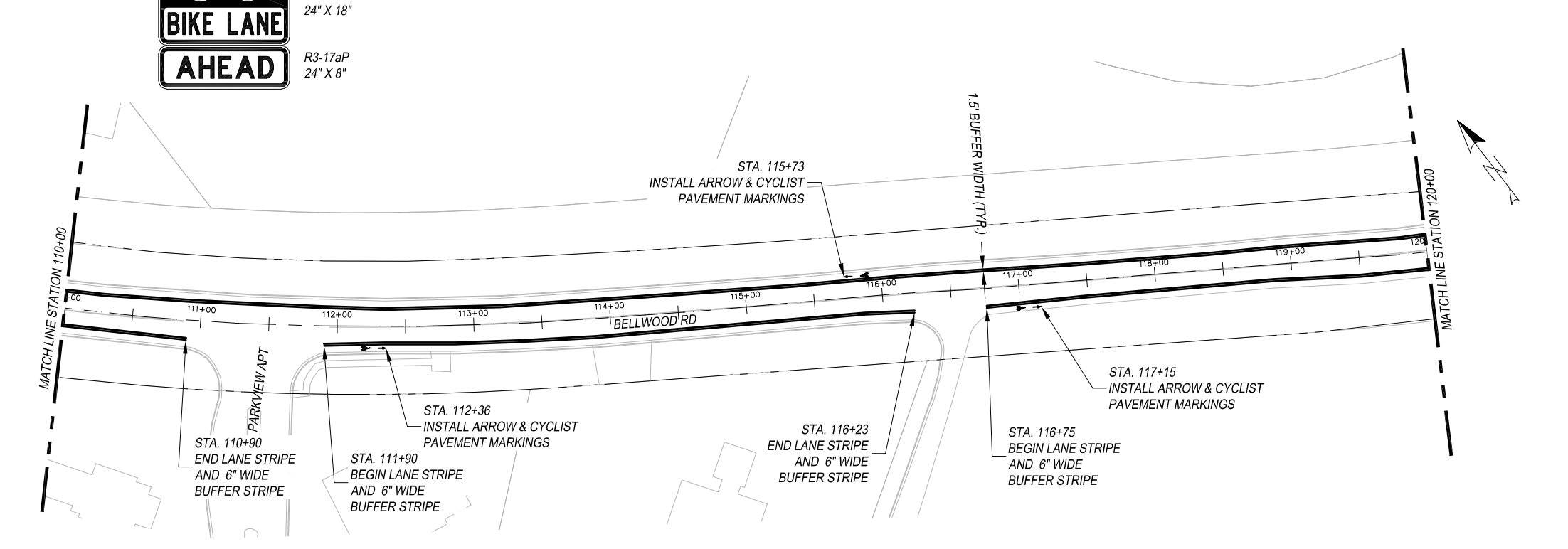
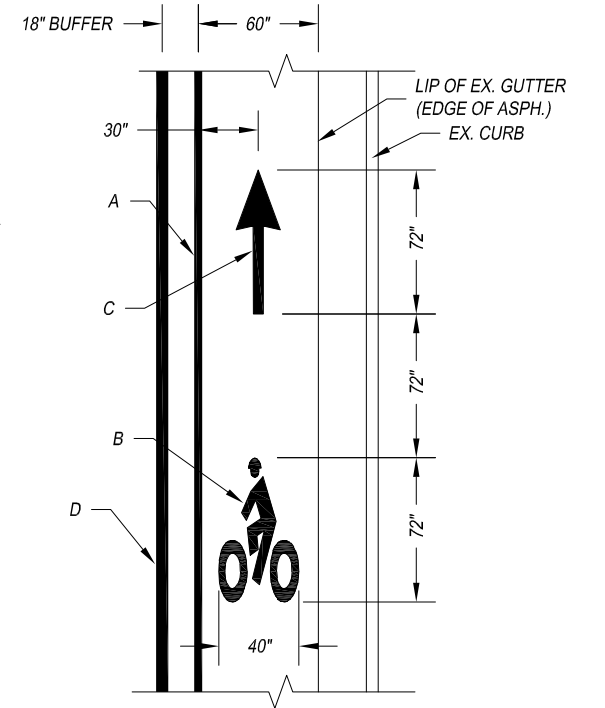
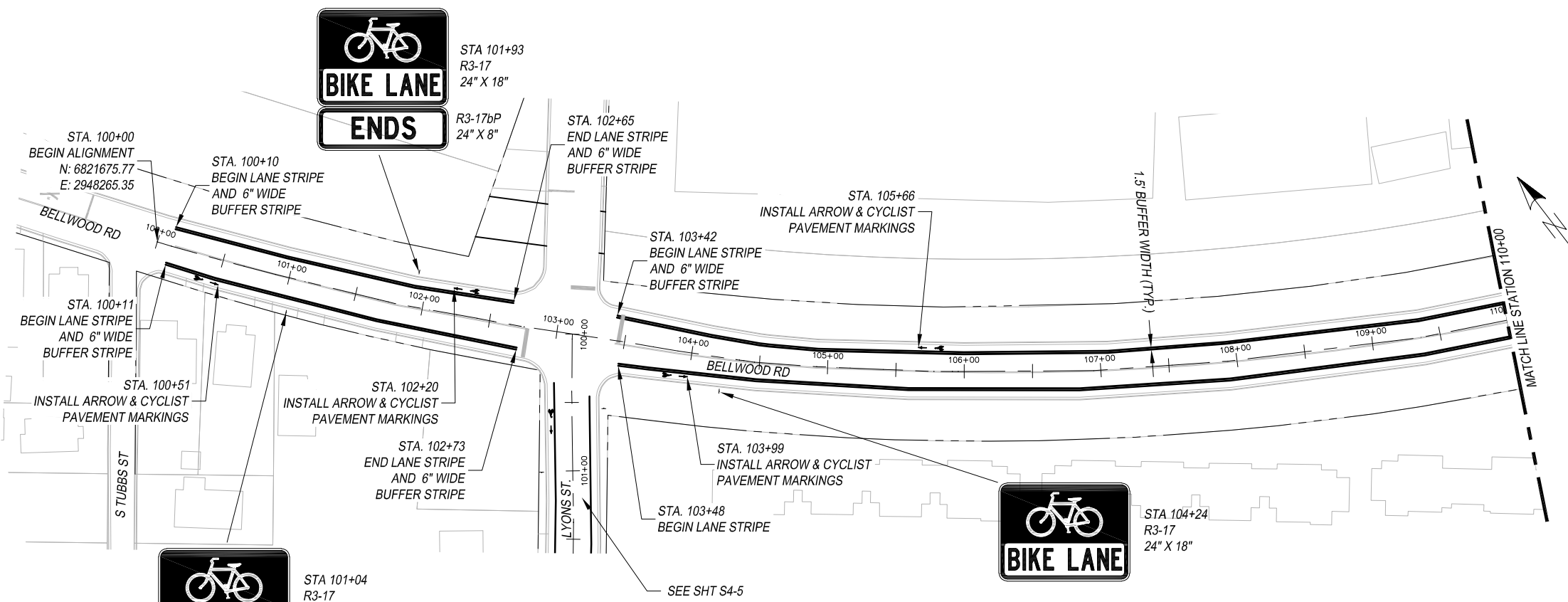

**ARROW & CYCLIST PAVEMENT MARKING DETAIL**  
 A - REFL PAV MRK TY I (W) 4" (SLD)  
 B - PREFAB PAV MRK TY C (W) (BIKE SYML)  
 C - PREFAB PAV MRK TY C (W) (BIKE ARROW)  
 D - REFL PAV MRK TY I (W) 6" (SLD)

THIS DOCUMENT IS RELEASED FOR THE PURPOSE OF INTERIM REVIEW UNDER THE AUTHORITY OF MENA I. SOULIMAN, P.E. 136203 ON APRIL 24, 2020. IT IS NOT TO BE USED FOR CONSTRUCTION, BIDDING OR PERMIT PURPOSES.



TYLER BIKE STRIPES  
 SPOKE 4  
 SCALE: 1" = 100'

FED. AD. DIV. NO.	FEDERAL AID PROJECT NO.	SHT. NO.	
6.	STP 2019 (290)	S4-1	
STATE	STATE DIST. NO.	COUNTY	
TEXAS	10	SMITH	
CONT.	SECT.	JOB	HIGHWAY NO.
0910	16	144	CS

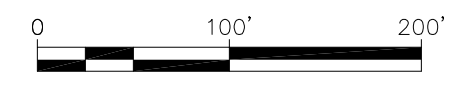

EXISTING CONDITIONS			
Roadway Name	Station	Number of Lanes	Lane Widths*
Bellwood Rd	120+00-137+00	2	17.5'-21'
W. Houston St.	137+00-140+00	4	12.5'-13.5'

\* Distances are measured from the edge of the pavement, excluding the gutter.

PROPOSED CONDITIONS						
Roadway Name	Station	Number of Lanes	Lane Widths*	Bicycle Lane Width*	Buffer Width*	
Bellwood Rd	120+00-137+00	2	11'-14.5'	5'	1.5'	
W. Houston St.	137+00-140+00	4	12.5'-13.5'	0'	0'	

\* Distances are measured from the edge of the pavement, excluding the gutter.

### LEGEND

- EXISTING ROW
- PROPOSED SIGN

- NOTES:
- \* CONTRACTOR TO VERIFY LOCATION OF EXISTING SIDEWALKS AND DRIVEWAYS
  - \* CONTRACTOR TO VERIFY LOCATION OF EXISTING SIGNAGE TO ENSURE PROPER SIGN SPACING.

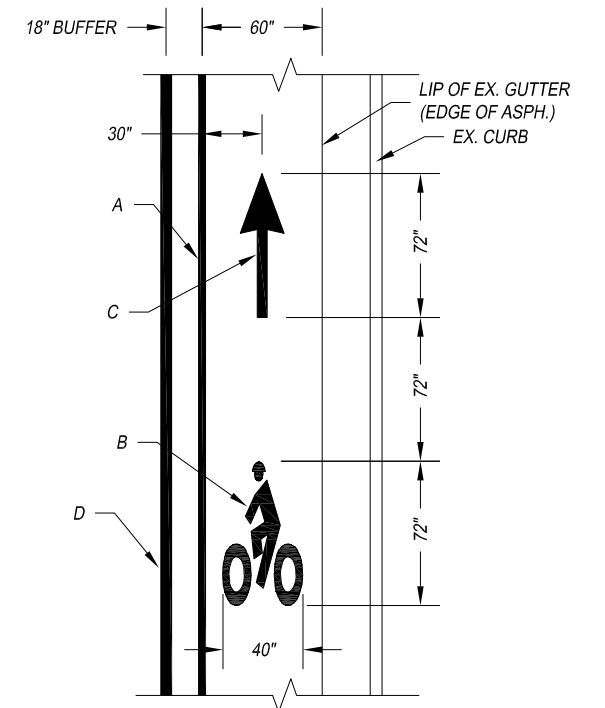
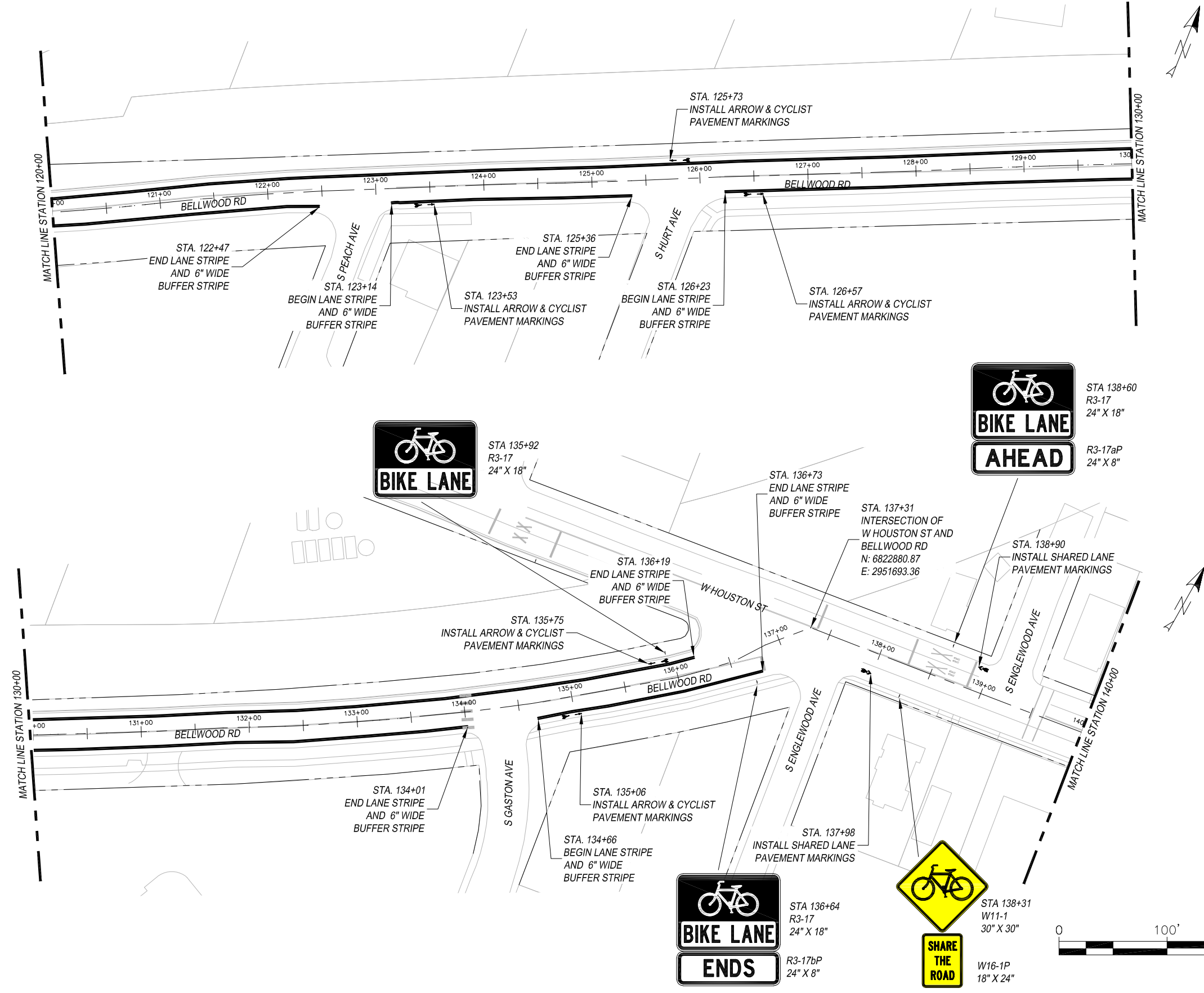

**ARROW & CYCLIST PAVEMENT MARKING DETAIL**

- A - REFL PAV MRK TY I (W) 4" (SLD)
- B - PREFAB PAV MRK TY C (W) (BIKE SYML)
- C - PREFAB PAV MRK TY C (W) (BIKE ARROW)
- D - REFL PAV MRK TY I (W) 6" (SLD)

THIS DOCUMENT IS RELEASED FOR THE PURPOSE OF INTERIM REVIEW UNDER THE AUTHORITY OF MENA I. SOULIMAN, P.E. 136203 ON APRIL 24, 2020. IT IS NOT TO BE USED FOR CONSTRUCTION, BIDDING OR PERMIT PURPOSES.



TYLER BIKE STRIPES  
SPOKE 4  
SCALE: 1" = 100'

FED. AD. DIV. NO.	FEDERAL AID PROJECT NO.	SHT. NO.	
6.	STP 2019 (290)	S4-2	
STATE	STATE DIST. NO.	COUNTY	
TEXAS	10	SMITH	
CONT.	SECT.	JOB	HIGHWAY NO.
0910	16	144	CS

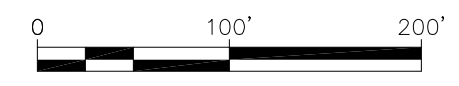



EXISTING CONDITIONS			
Roadway Name	Station	Number of Lanes	Lane Widths*
W. Houston St.	140+00-148+50	4	12.5'-13.5'
W. Houston St.	148+50-149+50	3	11.5'-14'
W. Houston St.	149+50-157+00	2	18'-18.5'
W. Houston St.	157+00-160+88	3	12'

\* Distances are measured from the edge of the pavement, excluding the gutter.

PROPOSED CONDITIONS				
Roadway Name	Station	Number of Lanes	Lane Widths*	Bicycle Lane Width*
W. Houston St.	140+00-148+50	4	12.5'-13.5'	0'
W. Houston St.	148+50-149+50	3	11.5'-14'	0'
W. Houston St.	149+50-157+00	2	18'-18.5'	0'
W. Houston St.	157+00-160+88	3	12'	0'

\* Distances are measured from the edge of the pavement, excluding the gutter.

### LEGEND

- EXISTING ROW
- PROPOSED SIGN

#### NOTES:

- \* CONTRACTOR TO VERIFY LOCATION OF EXISTING SIDEWALKS AND DRIVEWAYS
- \* CONTRACTOR TO VERIFY LOCATION OF EXISTING SIGNAGE TO ENSURE PROPER SIGN SPACING.

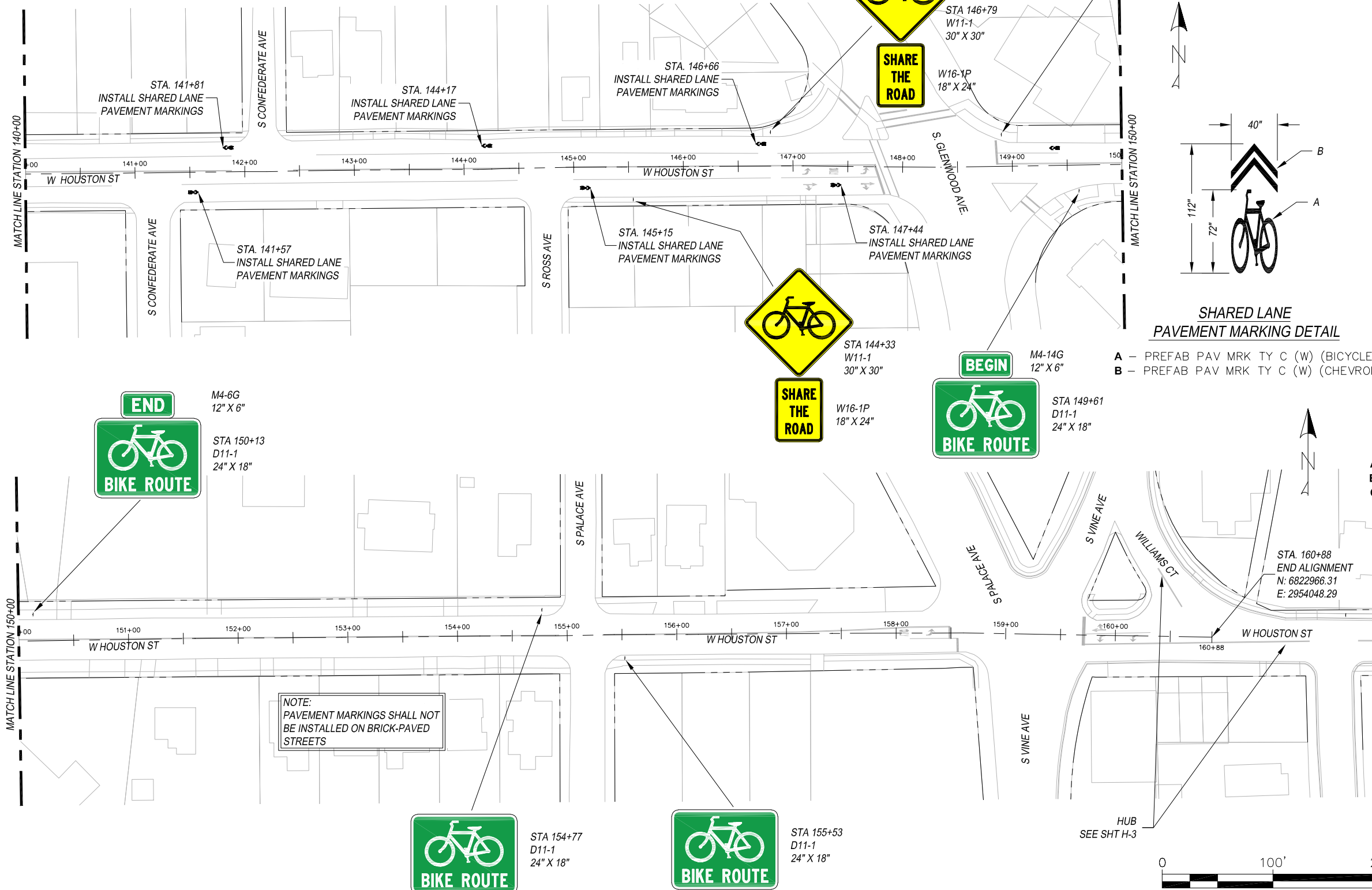

STA 148+90  
W11-1  
30" X 30"

W16-1P  
18" X 24"



STA 146+79  
W11-1  
30" X 30"

W16-1P  
18" X 24"



STA 144+33  
W11-1  
30" X 30"

W16-1P  
18" X 24"



M4-14G  
12" X 6"

STA 149+61  
D11-1  
24" X 18"



M4-6G  
12" X 6"

STA 150+13  
D11-1  
24" X 18"



STA 154+77  
D11-1  
24" X 18"



STA 155+53  
D11-1  
24" X 18"

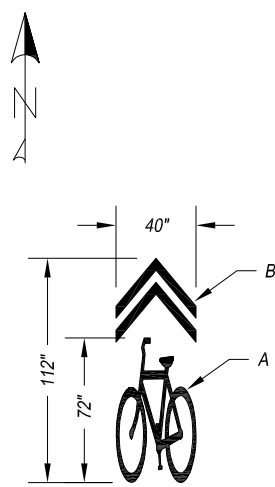

SHARED LANE PAVEMENT MARKING DETAIL

- A - PREFAB PAV MRK TY C (W) (BICYCLE SYML)
- B - PREFAB PAV MRK TY C (W) (CHEVRONS)

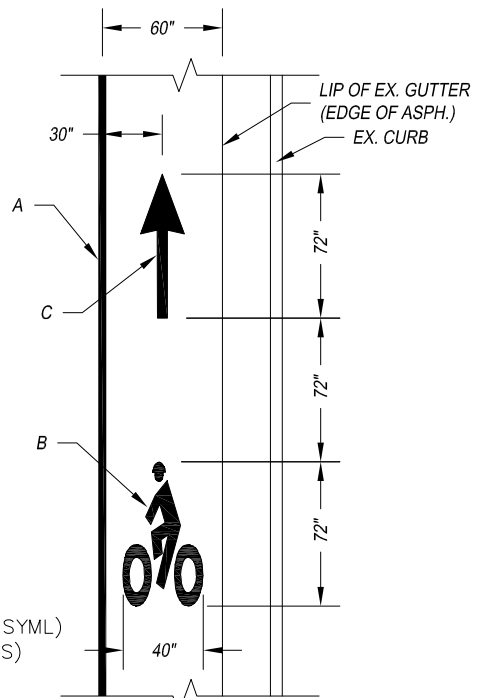

ARROW & CYCLIST PAVEMENT MARKING DETAIL

- A - REFL PAV MRK TY I (W) 4" (SLD)
- B - PREFAB PAV MRK TY C (W) (BIKE SYML)
- C - PREFAB PAV MRK TY C (W) (BIKE ARROW)

NOTE:  
PAVEMENT MARKINGS SHALL NOT  
BE INSTALLED ON BRICK-PAVED  
STREETS

THIS DOCUMENT IS RELEASED FOR THE PURPOSE OF INTERIM REVIEW UNDER THE AUTHORITY OF MENA I. SOULIMAN, P.E. 136203 ON APRIL 24, 2020. IT IS NOT TO BE USED FOR CONSTRUCTION, BIDDING OR PERMIT PURPOSES.



The University of Texas at  
**TYLER**

TYLER BIKE STRIPES  
SPOKE 4  
SCALE: 1" = 100'

FED. AD. DIV. NO.	FEDERAL AID PROJECT NO.	SHT. NO.	
6.	STP 2019 (290)	S4-3	
STATE	STATE DIST. NO.	COUNTY	
TEXAS	10	SMITH	
CONT.	SECT.	JOB	HIGHWAY NO.
0910	16	144	CS





STA 100+54  
R3-17  
24" X 18"

R3-17bP  
24" X 8"

EXISTING CONDITIONS			
Roadway Name	Station	Number of Lanes	Lane Widths*
S. Lyons Ave.	100+00-113+67	2	16.5'-17.5'

\* Distances are measured from the edge of the pavement, excluding the gutter.

PROPOSED CONDITIONS				
Roadway Name	Station	Number of Lanes	Lane Widths*	Bicycle Lane Width*
S. Lyons Ave.	100+00-113+67	2	11.5'-12.5'	5'

\* Distances are measured from the edge of the pavement, excluding the gutter.

### LEGEND

- EXISTING ROW
- PROPOSED SIGN

#### NOTES:

- \* CONTRACTOR TO VERIFY LOCATION OF EXISTING SIDEWALKS AND DRIVEWAYS
- \* CONTRACTOR TO VERIFY LOCATION OF EXISTING SIGNAGE TO ENSURE PROPER SIGN SPACING.

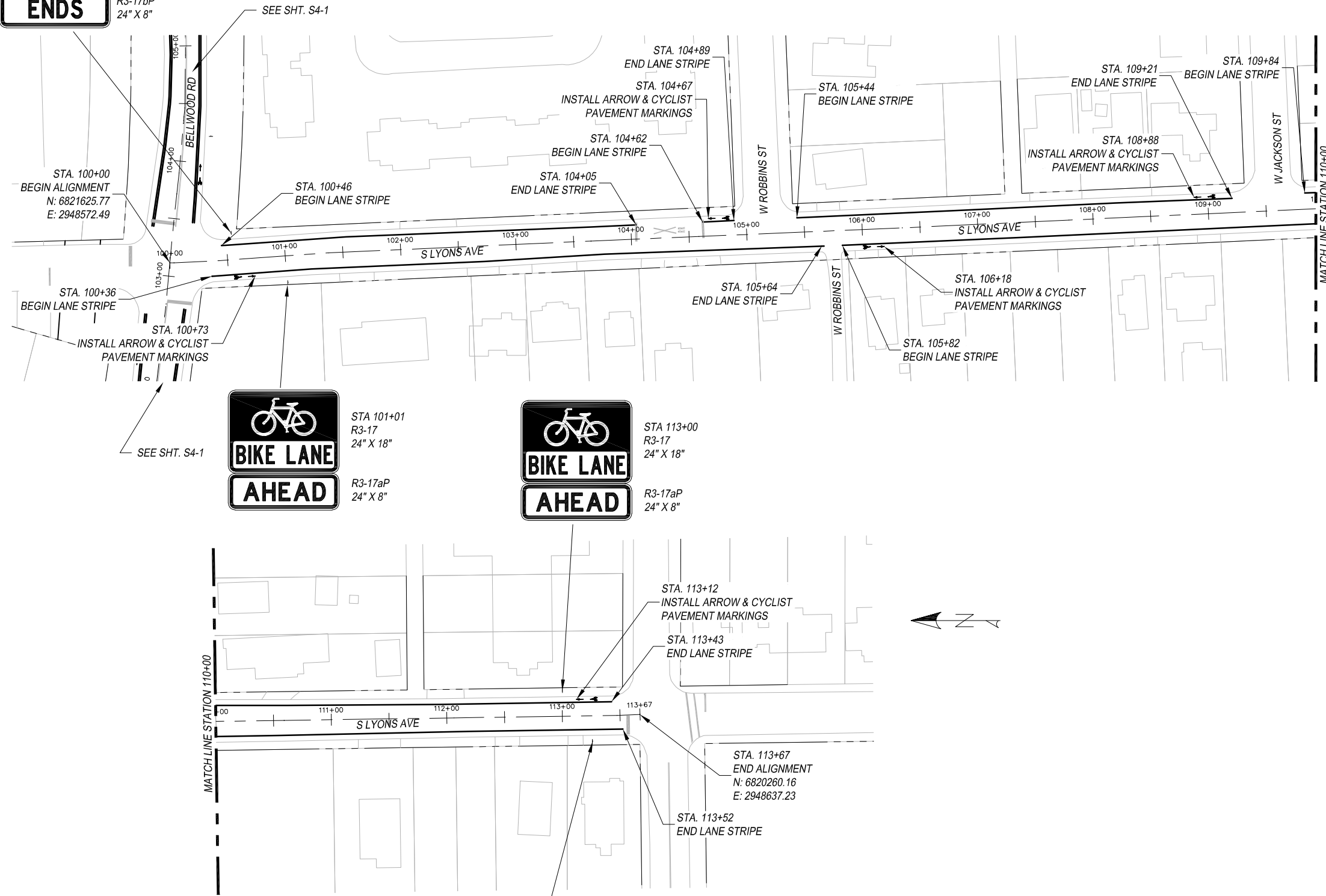

STA 101+01  
R3-17  
24" X 18"

R3-17aP  
24" X 8"



STA 113+00  
R3-17  
24" X 18"

R3-17aP  
24" X 8"



STA 113+25  
R3-17  
24" X 18"

R3-17bP  
24" X 8"

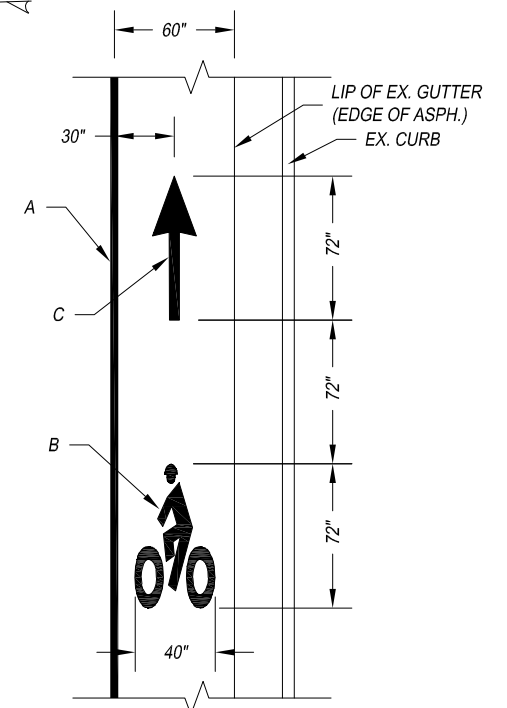

**ARROW & CYCLIST PAVEMENT MARKING DETAIL**

- A - REFL PAV MRK TY I (W) 4" (SLD)
- B - PREFAB PAV MRK TY C (W) (BIKE SYML)
- C - PREFAB PAV MRK TY C (W) (BIKE ARROW)

THIS DOCUMENT IS RELEASED FOR THE PURPOSE OF INTERIM REVIEW UNDER THE AUTHORITY OF MENA I. SOULIMAN, P.E. 136203 ON APRIL 24, 2020. IT IS NOT TO BE USED FOR CONSTRUCTION, BIDDING OR PERMIT PURPOSES.



TYLER BIKE STRIPES  
SPOKE 4  
SCALE: 1" = 100'

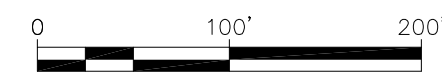

FED. AD. DIV. NO.	FEDERAL AID PROJECT NO.	SHT. NO.	
6.	STP 2019 (290)	S4-4	
STATE	STATE DIST. NO.	COUNTY	
TEXAS	10	SMITH	
CONT.	SECT.	JOB	HIGHWAY NO.
0910	16	144	CS