

**STA 100+00  
BEGIN SPOKE 6**

**SPOKE 6**

**STA 191+84  
END SPOKE 6**

**SPOKE 2**

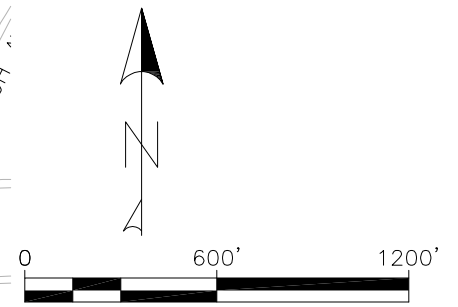

THIS DOCUMENT IS RELEASED FOR THE PURPOSE OF INTERIM REVIEW UNDER THE AUTHORITY OF MENA I. SOULIMAN, P.E. 136203 ON APRIL 24, 2020. IT IS NOT TO BE USED FOR CONSTRUCTION, BIDDING OR PERMIT PURPOSES.



The University of Texas at  
**TYLER**

TYLER BIKE STRIPES  
SPOKE 6 VICINITY MAP

FED. AD. DIV. NO.	FEDERAL AID PROJECT NO.	SHT. NO.	
6.	STP 2019 (290)	S6-0	
STATE	STATE DIST. NO.	COUNTY	
TEXAS	10	SMITH	
CONT.	SECT.	JOB	HIGHWAY NO.
0910	16	144	CS



STA 100+47  
R3-17  
24" X 18"  
  
R3-17bP  
24" X 8"

EXISTING CONDITIONS			
Roadway Name	Station	Number of Lanes	Lane Widths*
N. Palace Ave.	100+00-117+00	2	14.5'-15.5'
W. Harmony St.	117+00-120+00	2	14'-15'

\* Distances are measured from the edge of the pavement, excluding the gutter.

PROPOSED CONDITIONS				
Roadway Name	Station	Number of Lanes	Lane Widths*	Bicycle Lane Width*
N. Palace Ave.	100+00-117+00	2	9.5'-10.5'	5'
W. Harmony St.	117+00-120+00	2	9'-10'	5'

\* Distances are measured from the edge of the pavement, excluding the gutter.

### LEGEND

- EXISTING ROW
- PROPOSED SIGN

#### NOTES:

- \* CONTRACTOR TO VERIFY LOCATION OF EXISTING SIDEWALKS AND DRIVEWAYS
- \* CONTRACTOR TO VERIFY LOCATION OF EXISTING SIGNAGE TO ENSURE PROPER SIGN SPACING.

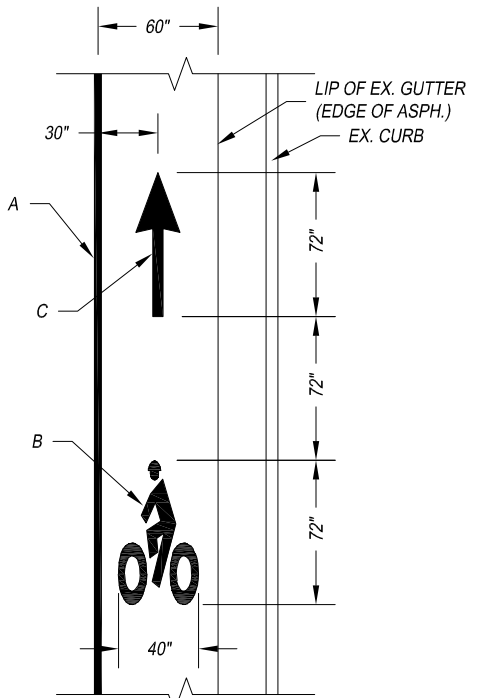
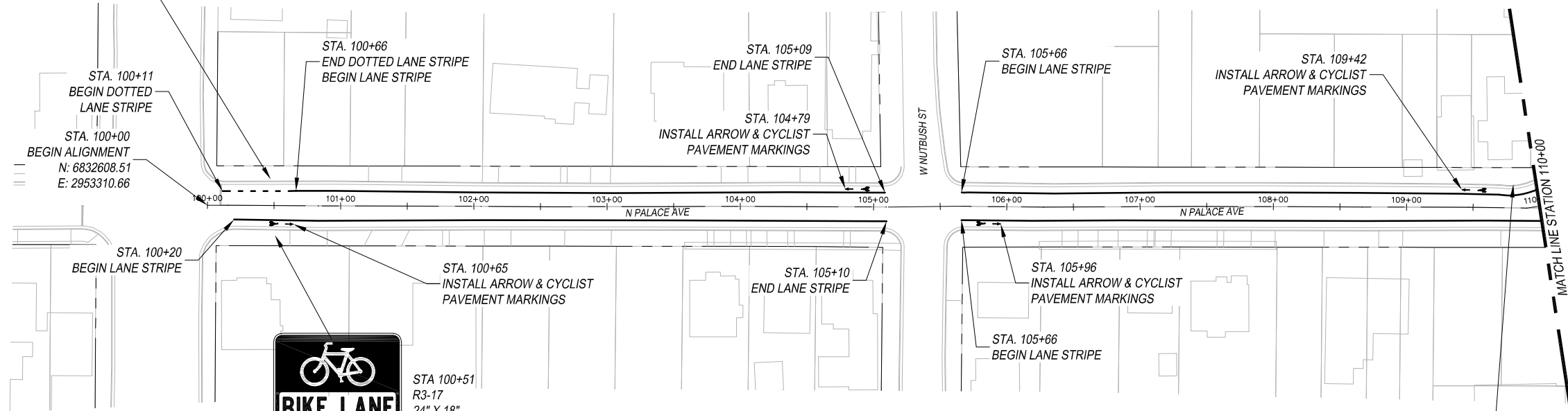

- ARROW & CYCLIST PAVEMENT MARKING DETAIL**
- A - REFL PAV MRK TY I (W) 4" (SLD)
  - B - PREFAB PAV MRK TY C (W) (BIKE SYML)
  - C - PREFAB PAV MRK TY C (W) (BIKE ARROW)

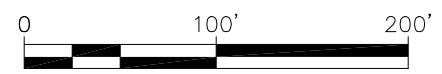
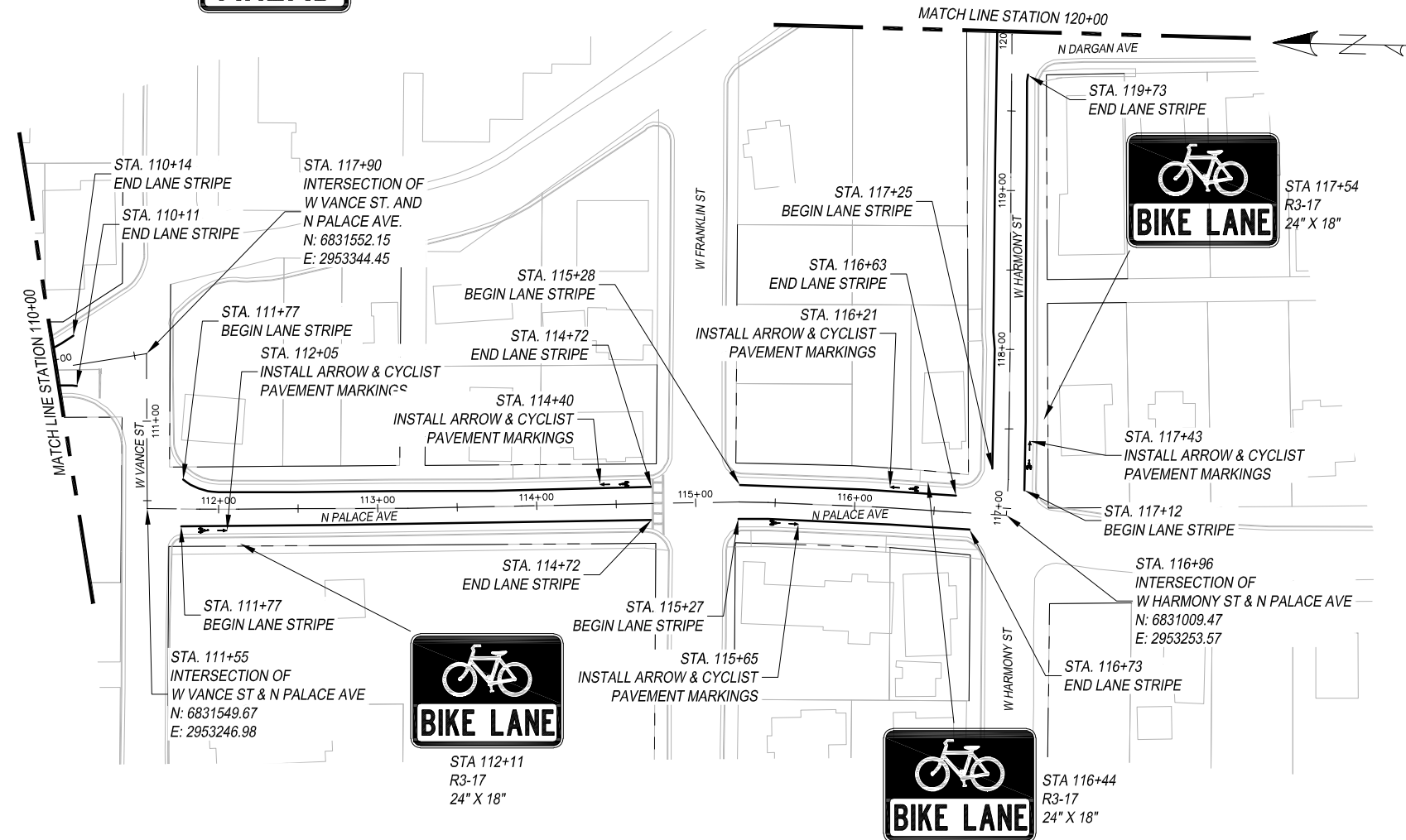

THIS DOCUMENT IS RELEASED FOR THE PURPOSE OF INTERIM REVIEW UNDER THE AUTHORITY OF MENA I. SOULIMAN, P.E. 136203 ON APRIL 24, 2020. IT IS NOT TO BE USED FOR CONSTRUCTION, BIDDING OR PERMIT PURPOSES.



TYLER BIKE STRIPES  
SPOKE 6  
SCALE: 1" = 100'

FED. AD. DIV. NO.	FEDERAL AID PROJECT NO.	SHT. NO.	
6.	STP 2019 (290)	S6-1	
STATE	STATE DIST. NO.	COUNTY	
TEXAS	10	SMITH	
CONT.	SECT.	JOB	HIGHWAY NO.
0910	16	144	CS

EXISTING CONDITIONS			
Roadway Name	Station	Number of Lanes	Lane Widths*
W. Harmony St.	120+00-128+00	2	14'-15'
N. Border Ave.	128+00-140+00	2	14.5'-15.5'

\* Distances are measured from the edge of the pavement, excluding the gutter.

PROPOSED CONDITIONS				
Roadway Name	Station	Number of Lanes	Lane Widths*	Bicycle Lane Width*
W. Harmony St.	120+00-128+00	2	9'-10'	5'
N. Border Ave.	128+00-140+00	2	9.5'-10.5'	5'

\* Distances are measured from the edge of the pavement, excluding the gutter.

### LEGEND

- EXISTING ROW
- PROPOSED SIGN

#### NOTES:

- \* CONTRACTOR TO VERIFY LOCATION OF EXISTING SIDEWALKS AND DRIVEWAYS
- \* CONTRACTOR TO VERIFY LOCATION OF EXISTING SIGNAGE TO ENSURE PROPER SIGN SPACING.

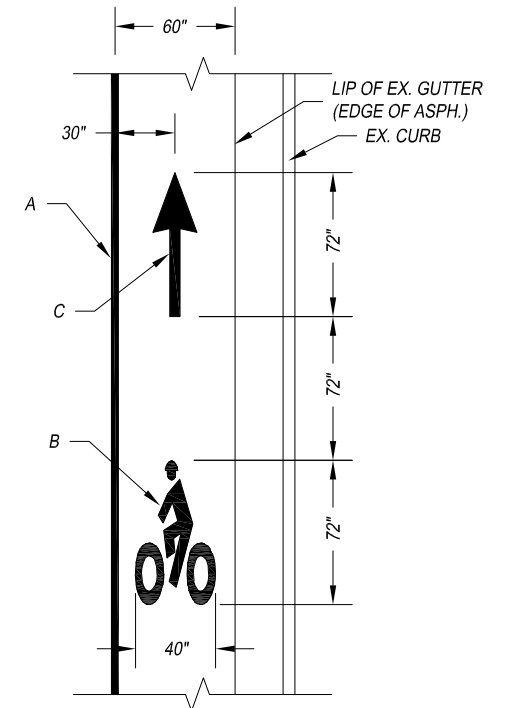
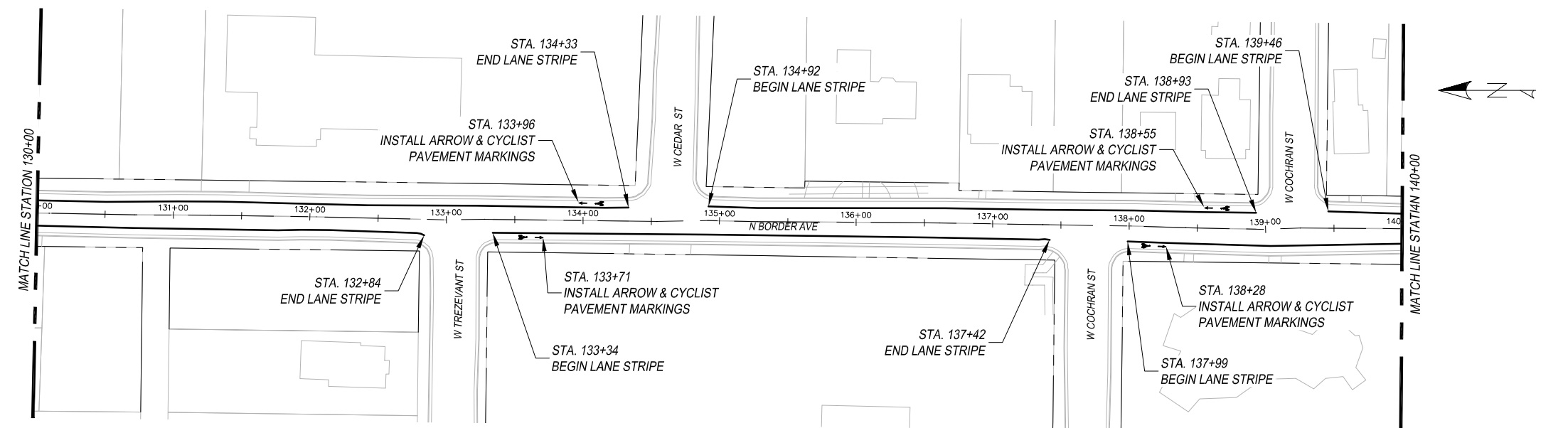
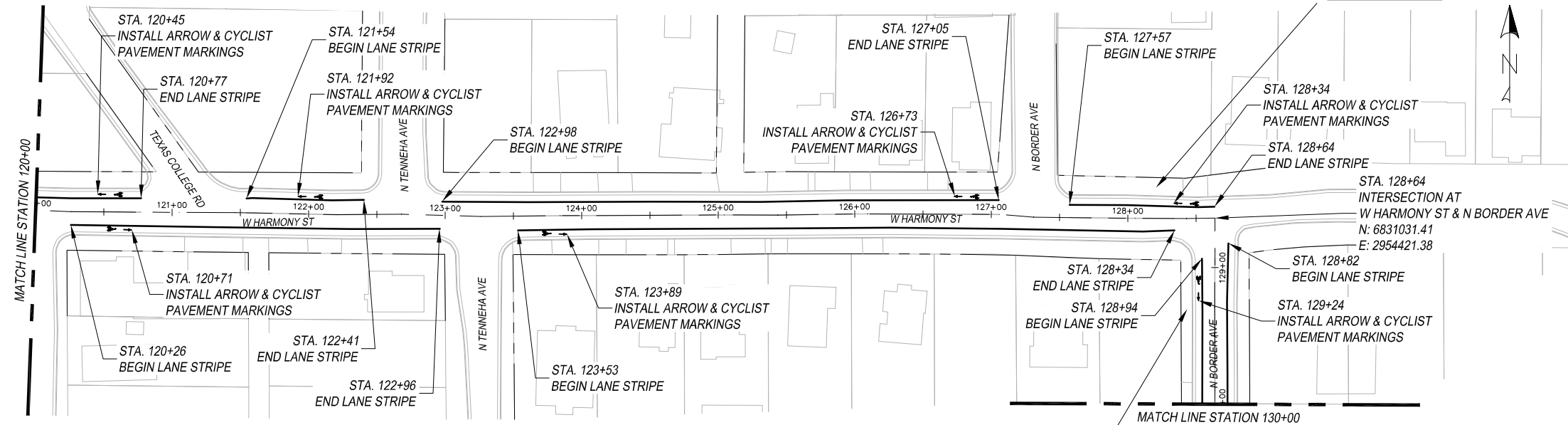

- A - REFL PAV MRK TY I (W) 4" (SLD)
- B - PREFAB PAV MRK TY C (W) (BIKE SYML)
- C - PREFAB PAV MRK TY C (W) (BIKE ARROW)

THIS DOCUMENT IS RELEASED FOR THE PURPOSE OF INTERIM REVIEW UNDER THE AUTHORITY OF MENA I. SOULIMAN, P.E. 136203 ON APRIL 24, 2020. IT IS NOT TO BE USED FOR CONSTRUCTION, BIDDING OR PERMIT PURPOSES.



TYLER BIKE STRIPES  
SPOKE 6  
SCALE: 1" = 100'

FED. AD. DIV. NO.	FEDERAL AID PROJECT NO.	SHT. NO.	
6.	STP 2019 (290)	S6-2	
STATE	STATE DIST. NO.	COUNTY	
TEXAS	10	SMITH	
CONT.	SECT.	JOB	HIGHWAY NO.
0910	16	144	CS





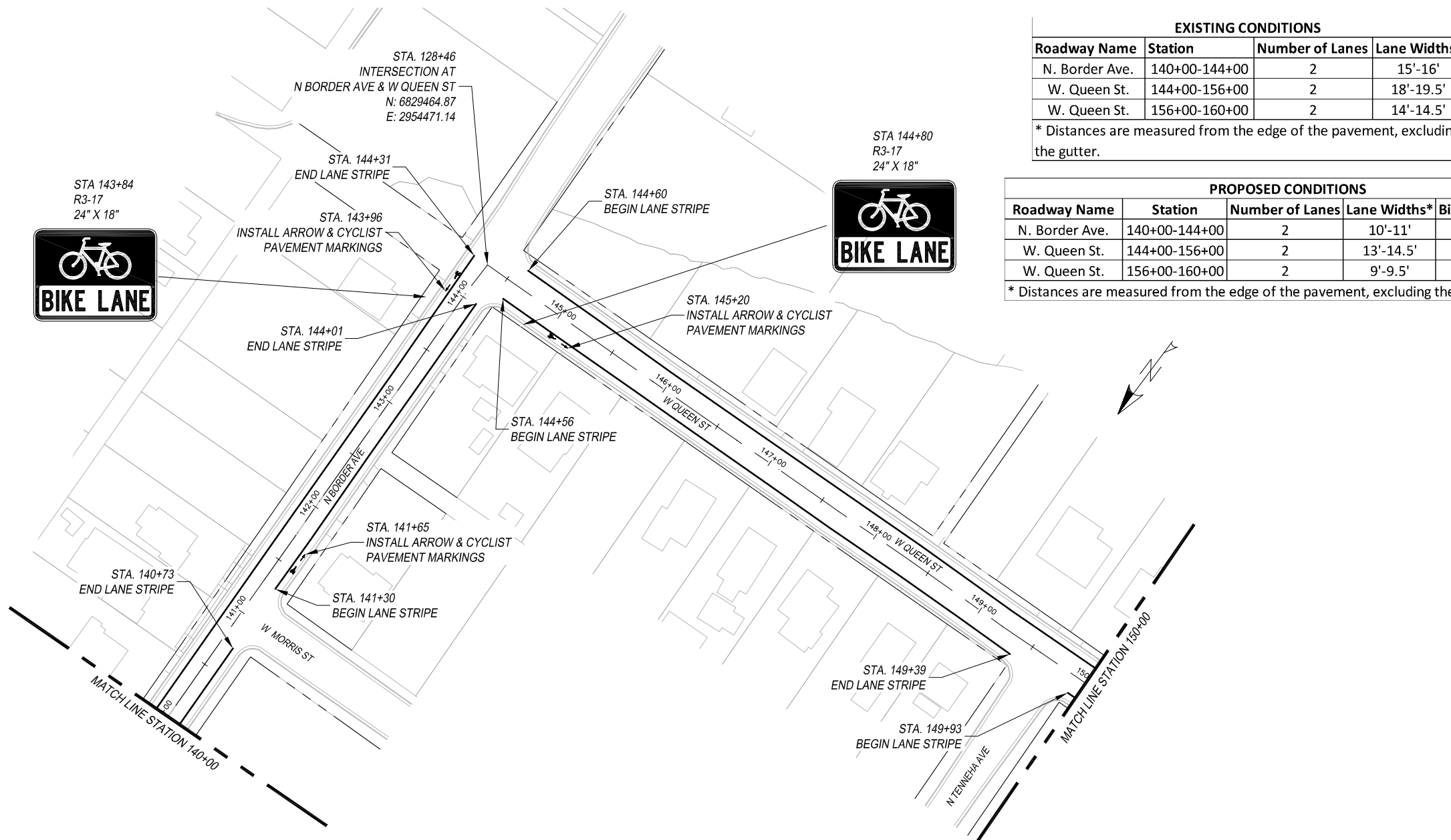

**EXISTING CONDITIONS**

Roadway Name	Station	Number of Lanes	Lane Widths*
N. Border Ave.	140+00-144+00	2	15'-16'
W. Queen St.	144+00-156+00	2	18'-19.5'
W. Queen St.	156+00-160+00	2	14'-14.5'

\* Distances are measured from the edge of the pavement, excluding the gutter.

**PROPOSED CONDITIONS**

Roadway Name	Station	Number of Lanes	Lane Widths*	Bicycle Lane Width*
N. Border Ave.	140+00-144+00	2	10'-11'	5'
W. Queen St.	144+00-156+00	2	13'-14.5'	5'
W. Queen St.	156+00-160+00	2	9'-9.5'	5'

\* Distances are measured from the edge of the pavement, excluding the gutter.

**LEGEND**

- EXISTING ROW
- PROPOSED SIGN

- NOTES:
- \* CONTRACTOR TO VERIFY LOCATION OF EXISTING SIDEWALKS AND DRIVEWAYS
  - \* CONTRACTOR TO VERIFY LOCATION OF EXISTING SIGNAGE TO ENSURE PROPER SIGN SPACING.

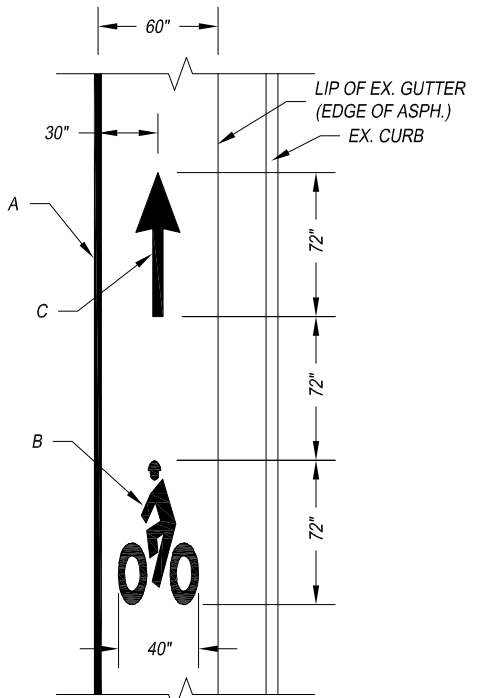

**ARROW & CYCLIST PAVEMENT MARKING DETAIL**

- A - REFL PAV MRK TY I (W) 4" (SLD)
- B - PREFAB PAV MRK TY C (W) (BIKE SYML)
- C - PREFAB PAV MRK TY C (W) (BIKE ARROW)

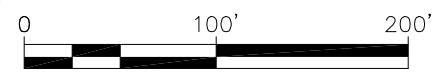
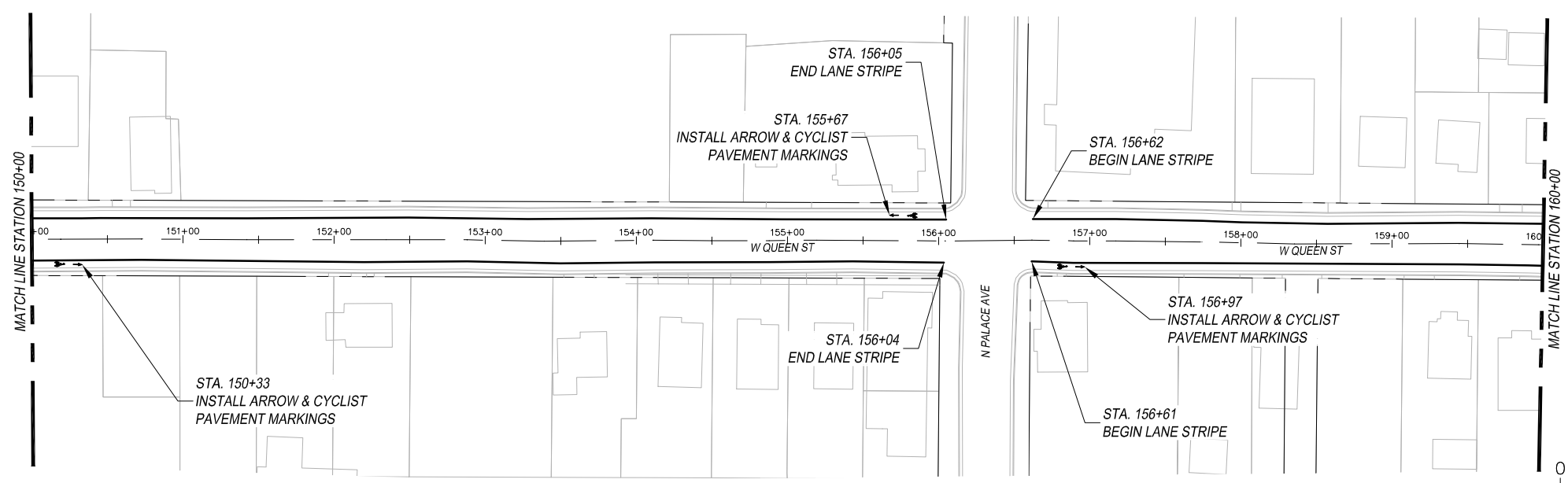

THIS DOCUMENT IS RELEASED FOR THE PURPOSE OF INTERIM REVIEW UNDER THE AUTHORITY OF MENA I. SOULIMAN, P.E. 136203 ON APRIL 24, 2020. IT IS NOT TO BE USED FOR CONSTRUCTION, BIDDING OR PERMIT PURPOSES.



TYLER BIKE STRIPES  
SPOKE 6  
SCALE: 1" = 100'

FED. AD. DIV. NO.	FEDERAL AID PROJECT NO.	SHT. NO.	
6.	STP 2019 (290)	S6-3	
STATE	STATE DIST. NO.	COUNTY	
TEXAS	10	SMITH	
CONT.	SECT.	JOB	HIGHWAY NO.
0910	16	144	CS

EXISTING CONDITIONS			
Roadway Name	Station	Number of Lanes	Lane Widths*
W. Queen St.	160+00-166+00	2	14.5'-16'
N. Ross Ave.	166+00-177+00	2	14.5'-16'
W. Bow St.	177+00-180+00	2	19'-20'

\* Distances are measured from the edge of the pavement, excluding the gutter.

PROPOSED CONDITIONS				
Roadway Name	Station	Number of Lanes	Lane Widths*	Bicycle Lane Width*
W. Queen St.	160+00-166+00	2	9.5'-11'	5'
N. Ross Ave.	166+00-177+00	2	9.5'-11'	5'
W. Bow St.	177+00-180+00	2	14'-15'	5'

\* Distances are measured from the edge of the pavement, excluding the gutter.

### LEGEND

- EXISTING ROW
- PROPOSED SIGN

- NOTES:
- \* CONTRACTOR TO VERIFY LOCATION OF EXISTING SIDEWALKS AND DRIVEWAYS
  - \* CONTRACTOR TO VERIFY LOCATION OF EXISTING SIGNAGE TO ENSURE PROPER SIGN SPACING.

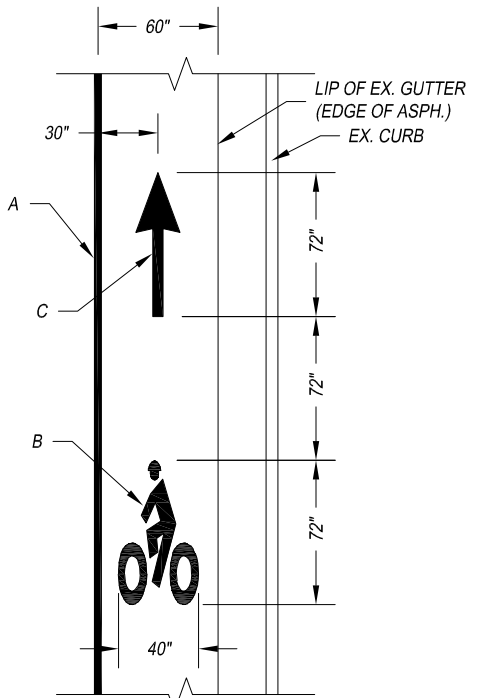
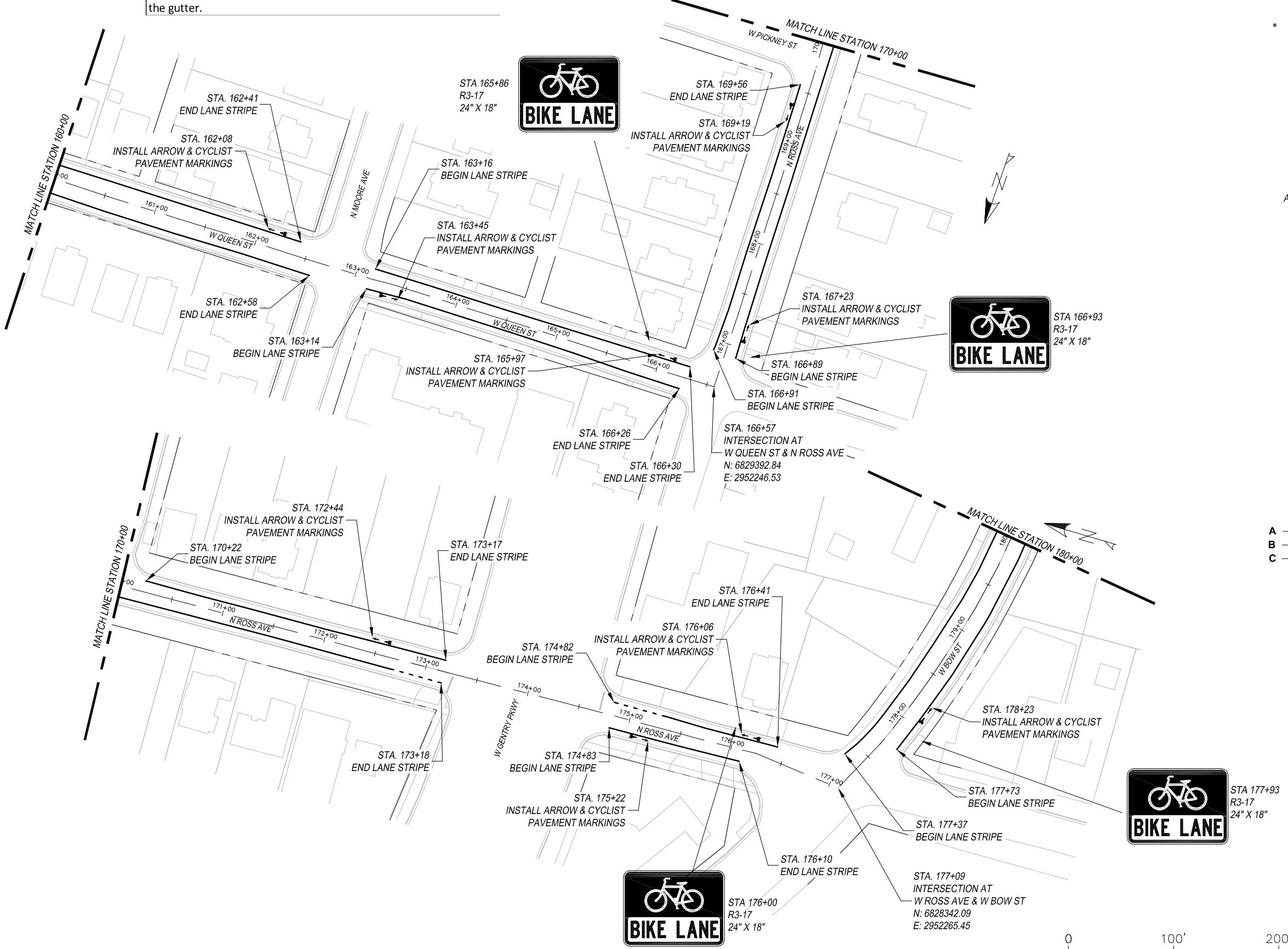

- ARROW & CYCLIST PAVEMENT MARKING DETAIL**
- A - REFL PAV MRK TY I (W) 4" (SLD)
  - B - PREFAB PAV MRK TY C (W) (BIKE SYML)
  - C - PREFAB PAV MRK TY C (W) (BIKE ARROW)

THIS DOCUMENT IS RELEASED FOR THE PURPOSE OF INTERIM REVIEW UNDER THE AUTHORITY OF MENA I. SOULIMAN, P.E. 136203 ON APRIL 24, 2020. IT IS NOT TO BE USED FOR CONSTRUCTION, BIDDING OR PERMIT PURPOSES.



TYLER BIKE STRIPES  
SPOKE 6  
SCALE: 1" = 100'

FED. AD. DIV. NO.	FEDERAL AID PROJECT NO.	SHT. NO.	
6.	STP 2019 (290)	S6-4	
STATE	STATE DIST. NO.	COUNTY	
TEXAS	10	SMITH	
CONT.	SECT.	JOB	HIGHWAY NO.
0910	16	144	CS

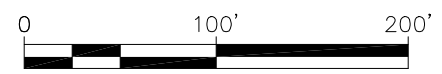

# LEGEND

- EXISTING ROW
- PROPOSED SIGN

- NOTES:
- \* CONTRACTOR TO VERIFY LOCATION OF EXISTING SIDEWALKS AND DRIVEWAYS
  - \* CONTRACTOR TO VERIFY LOCATION OF EXISTING SIGNAGE TO ENSURE PROPER SIGN SPACING.

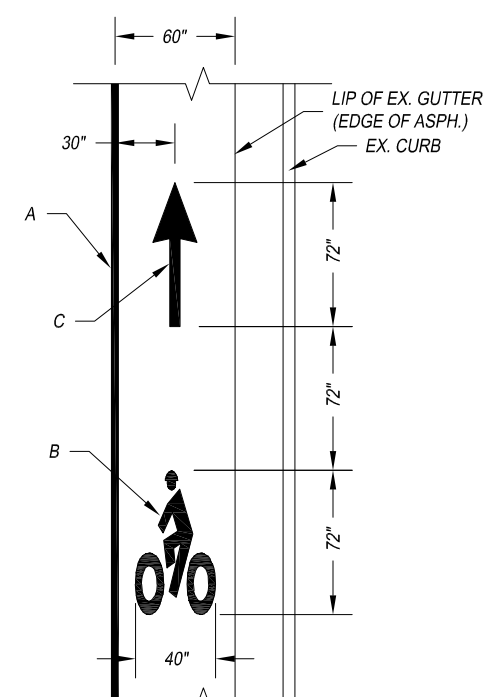
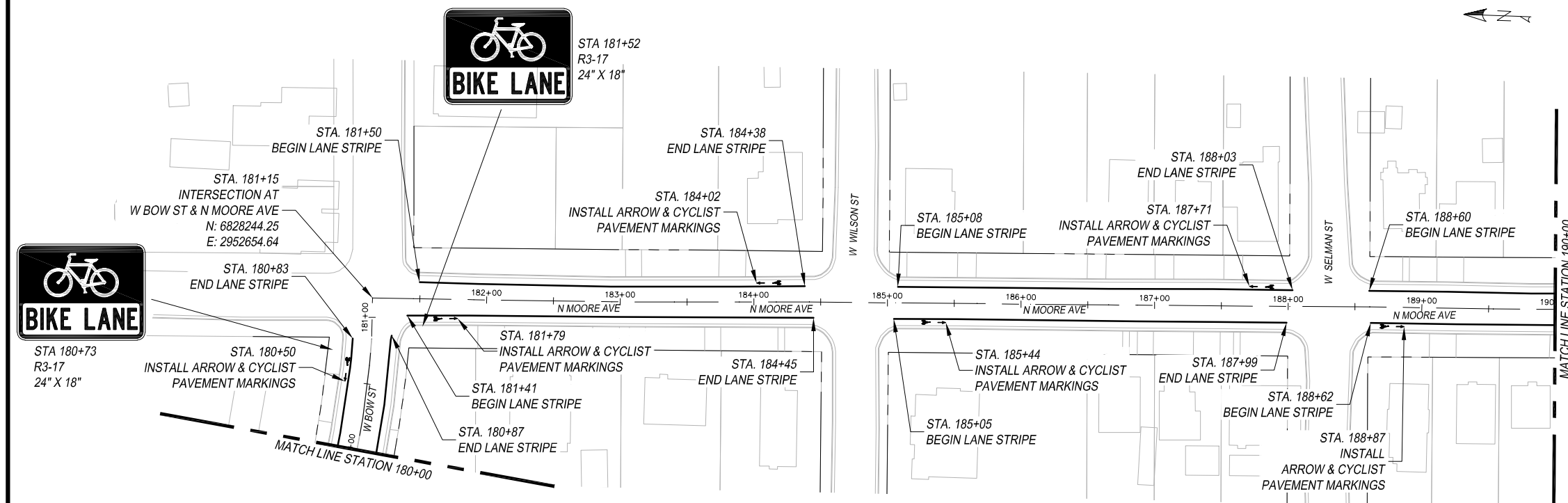

- ARROW & CYCLIST PAVEMENT MARKING DETAIL**
- A - REFL PAV MRK TY I (W) 4" (SLD)
  - B - PREFAB PAV MRK TY C (W) (BIKE SYML)
  - C - PREFAB PAV MRK TY C (W) (BIKE ARROW)

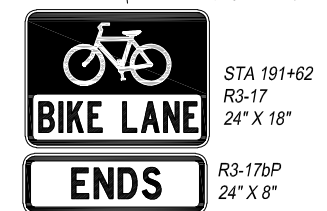
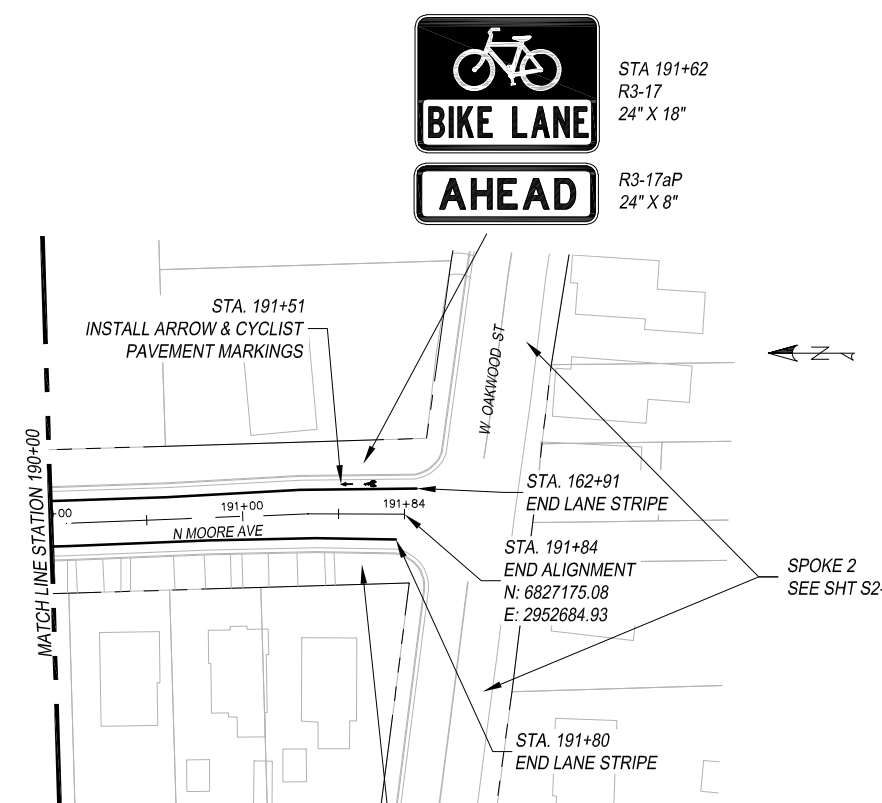

EXISTING CONDITIONS			
Roadway Name	Station	Number of Lanes	Lane Widths*
W. Bow St.	180+00-181+00	2	19'-20'
N. Moore Ave.	181+00-189+00	2	16'-17'
N. Moore Ave	189+00-191+85	2	16.5'-17.5'

\* Distances are measured from the edge of the pavement, excluding the gutter.

PROPOSED CONDITIONS				
Roadway Name	Station	Number of Lanes	Lane Widths*	Bicycle Lane Width*
W. Bow St.	180+00-181+00	2	14'-15'	5'
N. Moore Ave.	181+00-189+00	2	11'-12'	5'
N. Moore Ave.	189+00-191+85	2	11.5'-12.5'	5'

\* Distances are measured from the edge of the pavement, excluding the gutter.

THIS DOCUMENT IS RELEASED FOR THE PURPOSE OF INTERIM REVIEW UNDER THE AUTHORITY OF MENA I. SOULIMAN, P.E. 136203 ON APRIL 24, 2020. IT IS NOT TO BE USED FOR CONSTRUCTION, BIDDING OR PERMIT PURPOSES.



TYLER BIKE STRIPES  
SPOKE 6  
SCALE: 1" = 100'

FED. AD. DIV. NO.	FEDERAL AID PROJECT NO.	SHT. NO.	
6.	STP 2019 (290)	S6-5	
STATE	STATE DIST. NO.	COUNTY	
TEXAS	10	SMITH	
CONT.	SECT.	JOB	HIGHWAY NO.
0910	16	144	CS

