

THIS DOCUMENT IS RELEASED FOR THE PURPOSE OF INTERIM REVIEW UNDER THE AUTHORITY OF MENA I. SOULIMAN, P.E. 136203 ON APRIL 24, 2020. IT IS NOT TO BE USED FOR CONSTRUCTION, BIDDING OR PERMIT PURPOSES.



TYLER BIKE STRIPES HUB VICINITY MAP

FED. AD. DIV. NO.	FEDERAL AID PROJECT NO.	SHT. NO.	
6.	STP 2019 (290)	H-0	
STATE	STATE DIST. NO.	COUNTY	
TEXAS	10	SMITH	
CONT.	SECT.	JOB	HIGHWAY NO.
0910	16	144	CS

EXISTING CONDITIONS				
Roadway Name	Station	Number of Lanes	Lane Widths*	Parking Lane Width*
E. Ferguson St.	100+00-103+00	3	10.5'-11'	7'
W. Ferguson St.	103+00-107+00	2	11'-12.5'	0'
W. Ferguson St.	107+00-118+00	2	9'-9.5'	7' (both sides)
N. Bonner Ave.	118+00-120+00	2	19.5'-20'	0'

* Distances are measured from the edge of the pavement, excluding the gutter.

PROPOSED CONDITIONS					
Roadway Name	Station	Number of Lanes	Lane Widths*	Bicycle Lane Width*	Parking Lane Width*
E. Ferguson St.	100+00-103+00	3	10.5'-11'	0'	7'
W. Ferguson St.	103+00-107+00	2	11'-12.5'	0'	0'
W. Ferguson St.	107+00-118+00	2	9'-9.5'	0'	7' (both sides)
N. Bonner Ave.	118+00-120+00	2	19.5'-20'	0'	0'

* Distances are measured from the edge of the pavement, excluding the gutter.

LEGEND

- EXISTING ROW
- PROPOSED SIGN

- NOTES:
- * CONTRACTOR TO VERIFY LOCATION OF EXISTING SIDEWALKS AND DRIVEWAYS
 - * CONTRACTOR TO VERIFY LOCATION OF EXISTING SIGNAGE TO ENSURE PROPER SIGN SPACING.

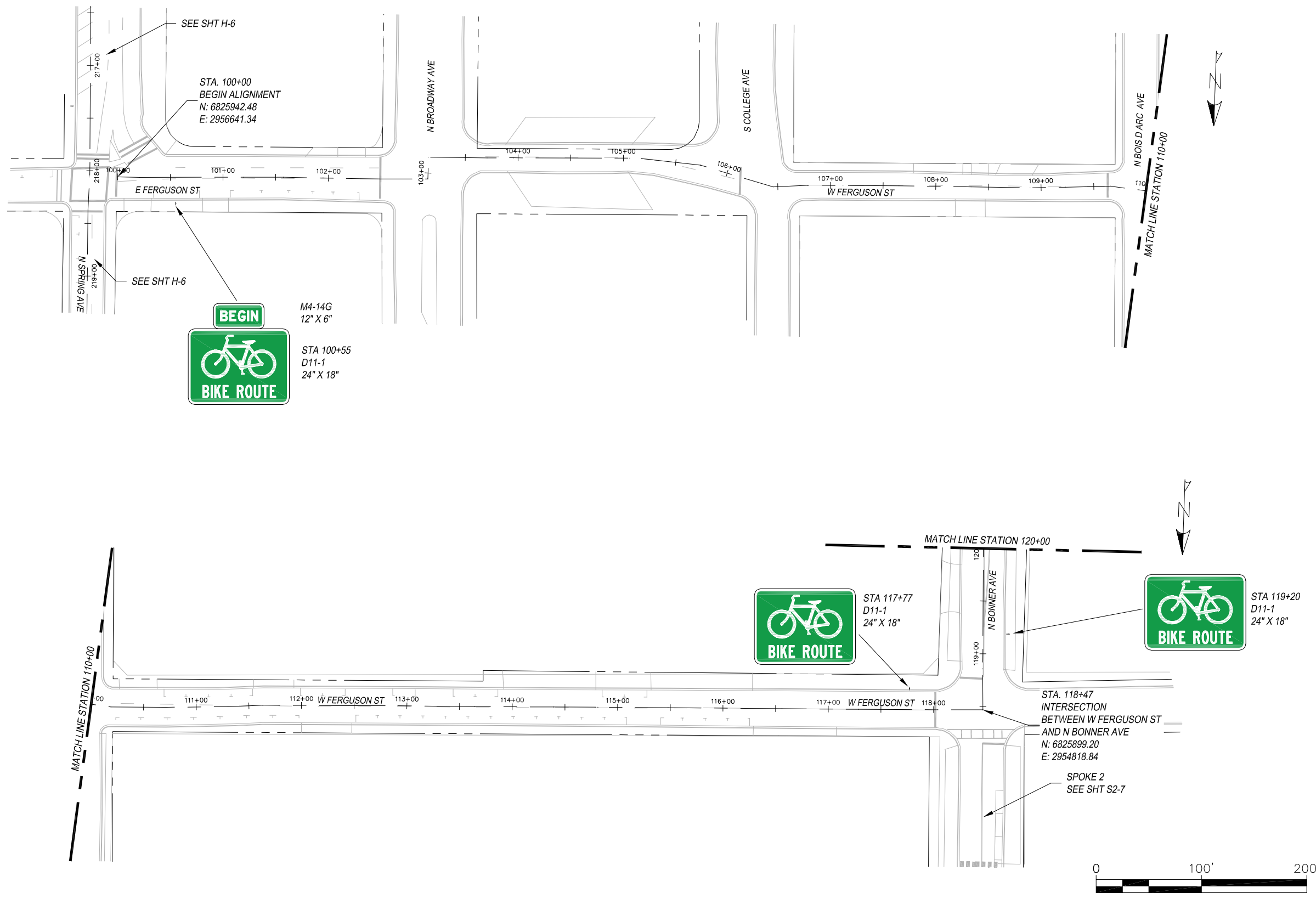

THIS DOCUMENT IS RELEASED FOR THE PURPOSE OF INTERIM REVIEW UNDER THE AUTHORITY OF MENA I. SOULIMAN, P.E. 136203 ON APRIL 24, 2020. IT IS NOT TO BE USED FOR CONSTRUCTION, BIDDING OR PERMIT PURPOSES.



The University of Texas at
TYLER

TYLER BIKE STRIPES
HUB
SCALE: 1" = 100'

FED. AD. DIV. NO.	FEDERAL AID PROJECT NO.	SHT. NO.	
6.	STP 2019 (290)	H-1	
STATE	STATE DIST. NO.	COUNTY	
TEXAS	10	SMITH	
CONT.	SECT.	JOB	HIGHWAY NO.
0910	16	144	CS

LEGEND

- — — — — EXISTING ROW
- PROPOSED SIGN

- NOTES:
- * CONTRACTOR TO VERIFY LOCATION OF EXISTING SIDEWALKS AND DRIVEWAYS
 - * CONTRACTOR TO VERIFY LOCATION OF EXISTING SIGNAGE TO ENSURE PROPER SIGN SPACING.

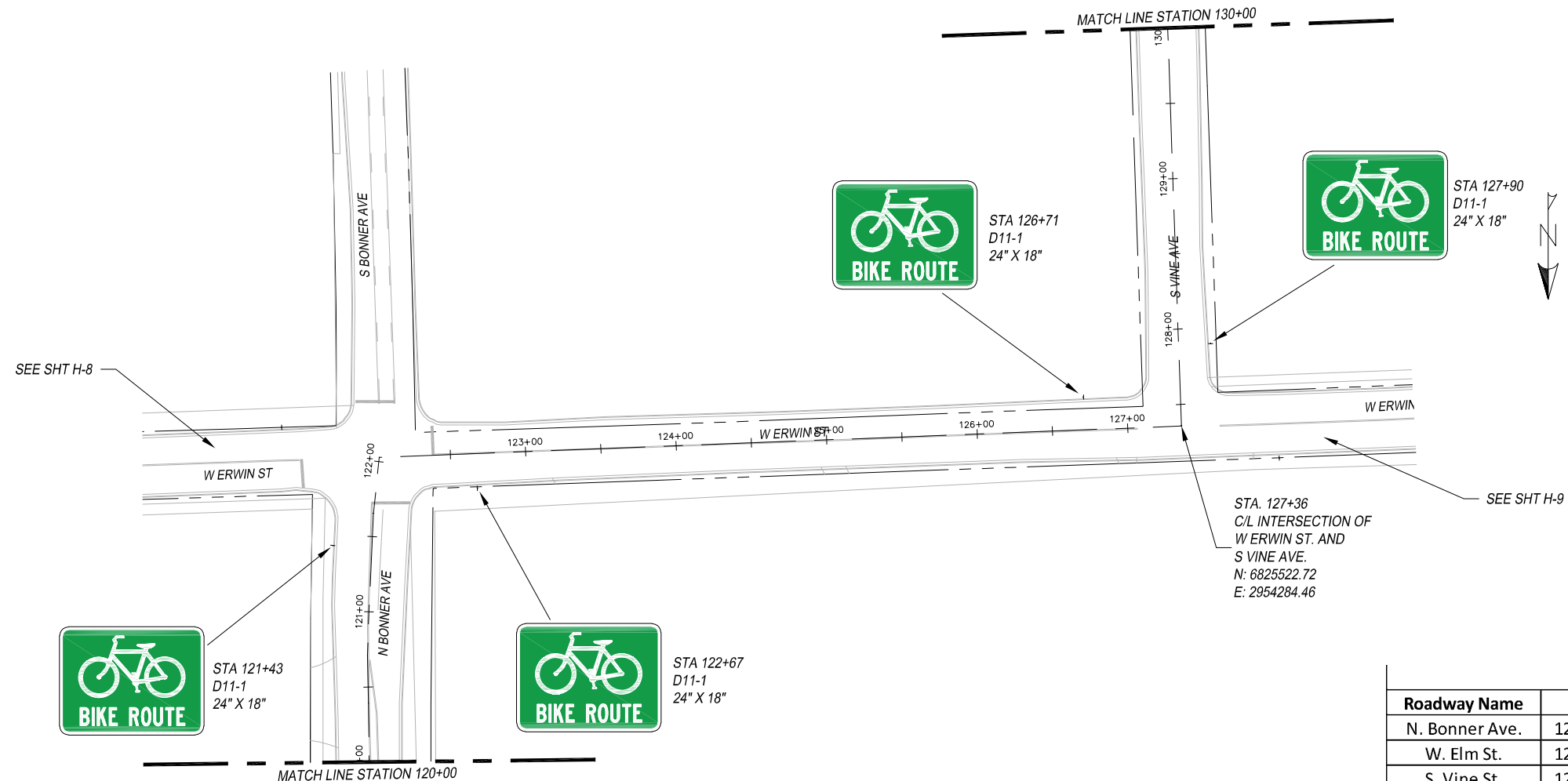

EXISTING CONDITIONS			
Roadway Name	Station	Number of Lanes	Lane Widths*
N. Bonner Ave.	120+00-122+00	3	15'-15.5'
W. Erwin St.	122+00-127+36	2	24'-25'
S. Vine St.	127+36-131+79	2	14'-19'
S. Vine St.	131+79-140+00	2	12.5'-18'

* Distances are measured from the edge of the pavement, excluding the gutter.

PROPOSED CONDITIONS				
Roadway Name	Station	Number of Lanes	Lane Widths*	Bicycle Lane Width*
N. Bonner Ave.	120+00-122+00	3	15'-15.5'	0'
W. Elm St.	122+00-127+36	2	24'-25'	0'
S. Vine St.	127+36-131+79	2	14'-19'	0'
S. Vine St.	131+00-140+00	2	12.5'-18'	0'

* Distances are measured from the edge of the pavement, excluding the gutter.

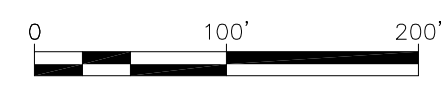
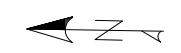
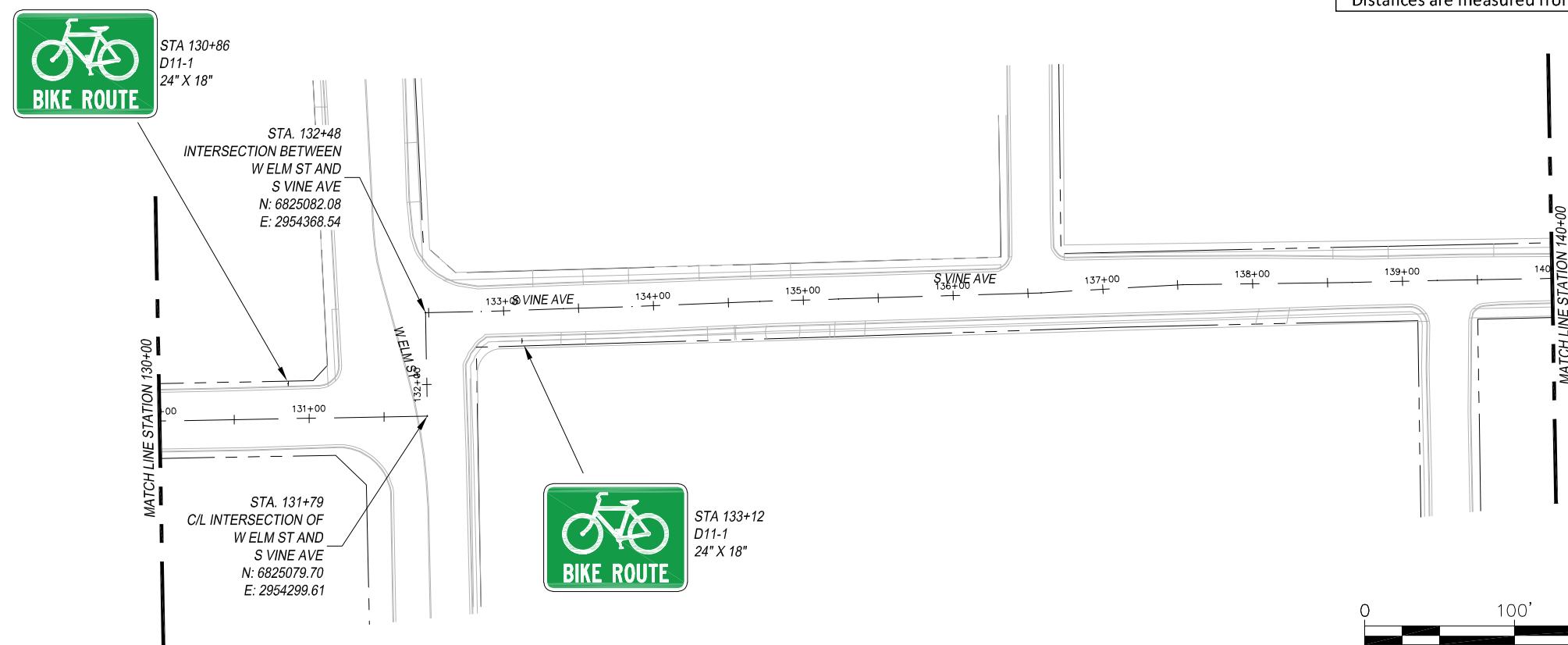

THIS DOCUMENT IS RELEASED FOR THE PURPOSE OF INTERIM REVIEW UNDER THE AUTHORITY OF MENA I. SOULIMAN, P.E. 136203 ON APRIL 24, 2020. IT IS NOT TO BE USED FOR CONSTRUCTION, BIDDING OR PERMIT PURPOSES.



TYLER BIKE STRIPES HUB

SCALE: 1" = 100'

FED. AD. DIV. NO.	FEDERAL AID PROJECT NO.	SHT. NO.	
6.	STP 2019 (290)	H-2	
STATE	STATE DIST. NO.	COUNTY	
TEXAS	10	SMITH	
CONT.	SECT.	JOB	HIGHWAY NO.
0910	16	144	CS

LEGEND

- — — EXISTING ROW
- PROPOSED SIGN

- NOTES:
- * CONTRACTOR TO VERIFY LOCATION OF EXISTING SIDEWALKS AND DRIVEWAYS
 - * CONTRACTOR TO VERIFY LOCATION OF EXISTING SIGNAGE TO ENSURE PROPER SIGN SPACING.

EXISTING CONDITIONS			
Roadway Name	Station	Number of Lanes	Lane Widths*
S. Vine Ave.	140+00-153+00	2	12.5'-18'
Williams Ct.	153+00-155+00	2	16'-16.5'
W. Houston St.	155+00-160+00	2	17.5'-19'

* Distances are measured from the edge of the pavement, excluding the gutter.

PROPOSED CONDITIONS				
Roadway Name	Station	Number of Lanes	Lane Widths*	Bicycle Lane Width*
S. Vine Ave.	140+00-153+00	2	12.5'-13'	0'
Williams Ct.	153+00-155+00	2	16'-16.5'	0'
W. Houston St.	155+00-160+00	2	17.5'-19'	0'

* Distances are measured from the edge of the pavement, excluding the gutter.

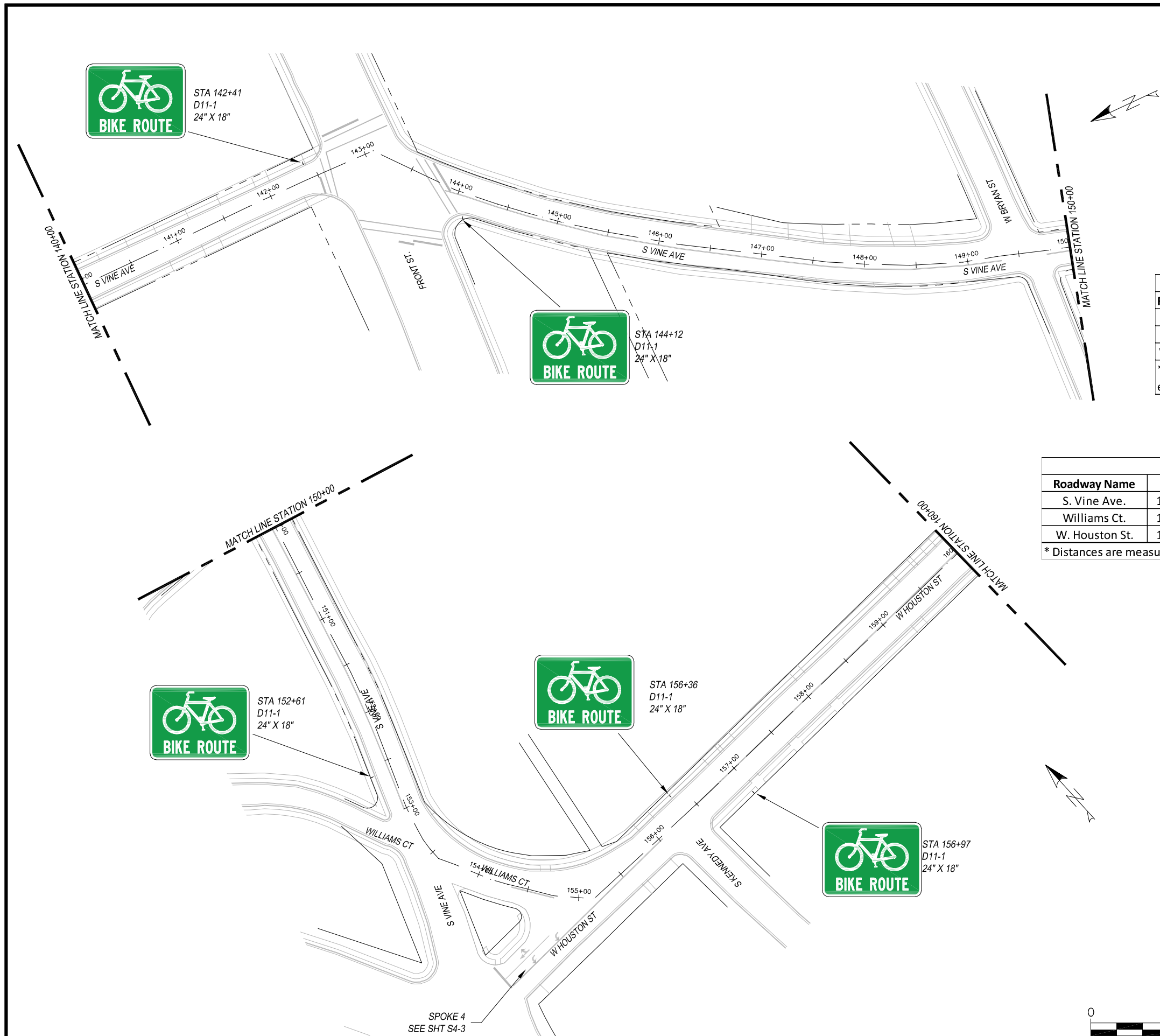

THIS DOCUMENT IS RELEASED FOR THE PURPOSE OF INTERIM REVIEW UNDER THE AUTHORITY OF MENA I. SOULIMAN, P.E. 136203 ON APRIL 24, 2020. IT IS NOT TO BE USED FOR CONSTRUCTION, BIDDING OR PERMIT PURPOSES.



TYLER BIKE STRIPES HUB

SCALE: 1" = 100'

FED. AD. DIV. NO.	FEDERAL AID PROJECT NO.	SHT. NO.	
6.	STP 2019 (290)	H-3	
STATE	STATE DIST. NO.	COUNTY	
TEXAS	10	SMITH	
CONT.	SECT.	JOB	HIGHWAY NO.
0910	16	144	CS

EXISTING CONDITIONS			
Roadway Name	Station	Number of Lanes	Lane Widths*
W. Houston St.	160+00-175+50	2	17.5'-19'
W. Houston St.	175+50-179+00	3	12'-12.5'
E. Houston St.	179+00-180+00	3	12.5'-13'

* Distances are measured from the edge of the pavement, excluding the gutter.

PROPOSED CONDITIONS				
Roadway Name	Station	Number of Lanes	Lane Widths*	Bicycle Lane Width*
W. Houston St.	160+00-175+50	2	17.5'-19'	0'
W. Houston St.	175+50-179+00	3	12'-12.5'	0'
E. Houston St.	179+00-180+00	3	12.5'-13'	0'

* Distances are measured from the edge of the pavement, excluding the gutter.

LEGEND

- — — EXISTING ROW
- PROPOSED SIGN

- NOTES:
- * CONTRACTOR TO VERIFY LOCATION OF EXISTING SIDEWALKS AND DRIVEWAYS
 - * CONTRACTOR TO VERIFY LOCATION OF EXISTING SIGNAGE TO ENSURE PROPER SIGN SPACING.

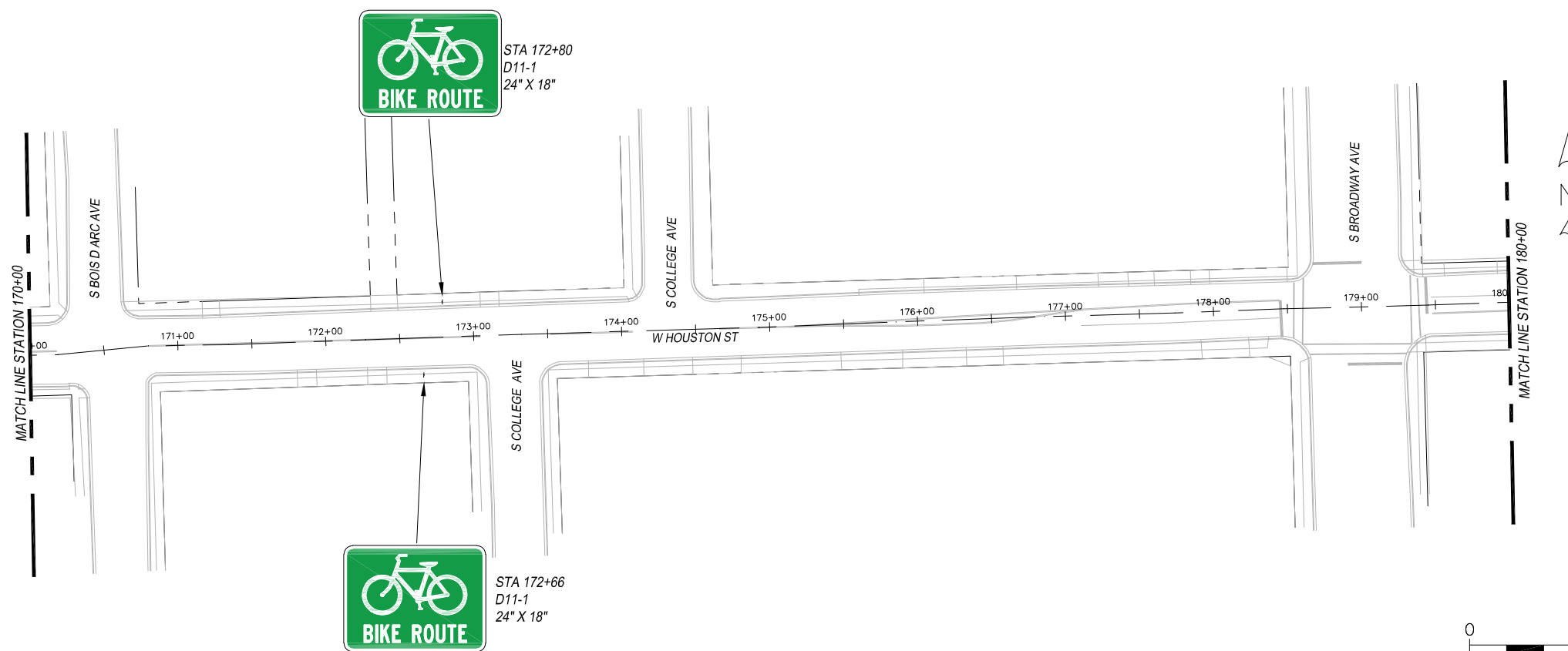
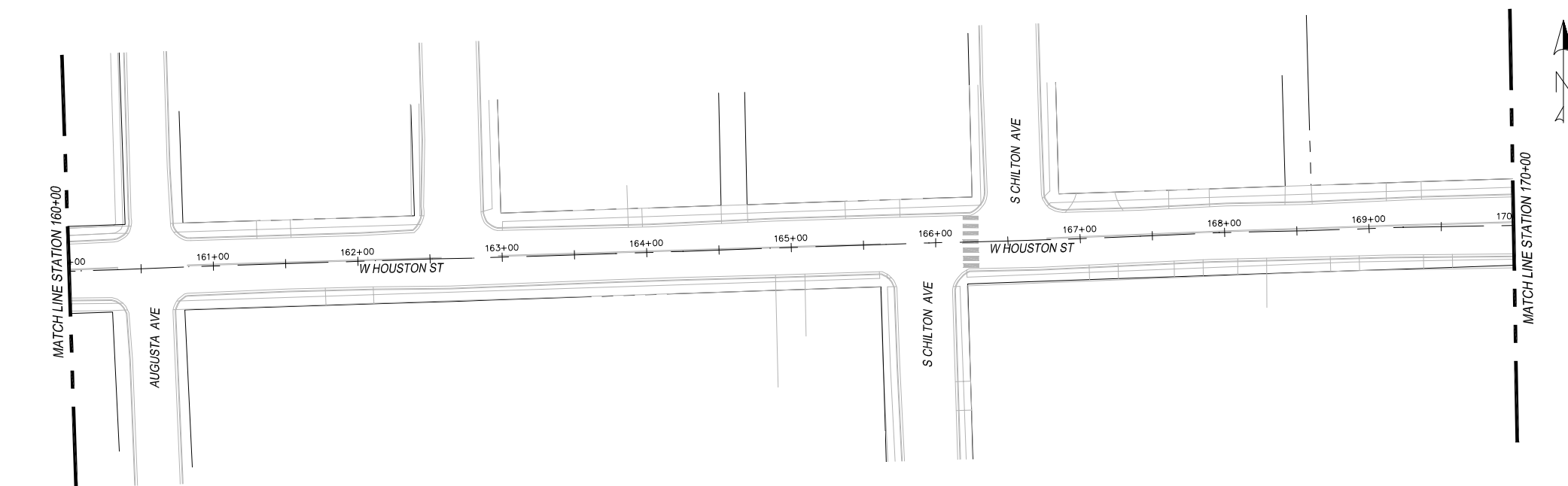

THIS DOCUMENT IS RELEASED FOR THE PURPOSE OF INTERIM REVIEW UNDER THE AUTHORITY OF MENA I. SOULIMAN, P.E. 136203 ON APRIL 24, 2020. IT IS NOT TO BE USED FOR CONSTRUCTION, BIDDING OR PERMIT PURPOSES.



TYLER BIKE STRIPES HUB

SCALE: 1" = 100'

FED. AD. DIV. NO.	FEDERAL AID PROJECT NO.	SHT. NO.	
6.	STP 2019 (290)	H-4	
STATE	STATE DIST. NO.	COUNTY	
TEXAS	10	SMITH	
CONT.	SECT.	JOB	HIGHWAY NO.
0910	16	144	CS

LEGEND

- — — EXISTING ROW
- PROPOSED SIGN

- NOTES:
- * CONTRACTOR TO VERIFY LOCATION OF EXISTING SIDEWALKS AND DRIVEWAYS
 - * CONTRACTOR TO VERIFY LOCATION OF EXISTING SIGNAGE TO ENSURE PROPER SIGN SPACING.

EXISTING CONDITIONS			
Roadway Name	Station	Number of Lanes	Lane Widths*
E. Houston St.	180+00-182+00	3	12.5'-13'
E. Houston St.	182+00-185+60	2	17.5'-19'
S. Fannin Ave.	185+00-193+00	2	15.5'-16.5'
S. Fannin Ave.	193+00-200+00	3	10'-12.5'

* Distances are measured from the edge of the pavement, excluding the gutter.

PROPOSED CONDITIONS				
Roadway Name	Station	Number of Lanes	Lane Widths*	Bicycle Lane Width*
E. Houston St.	180+00-182+00	3	12.5'-13'	0'
E. Houston St.	182+00-185+60	2	17.5'-19'	0'
S. Fannin Ave.	185+00-193+00	2	15.5'-16.5'	0'
S. Fannin Ave.	193+00-200+00	3	10'-12.5'	0'

* Distances are measured from the edge of the pavement, excluding the gutter.

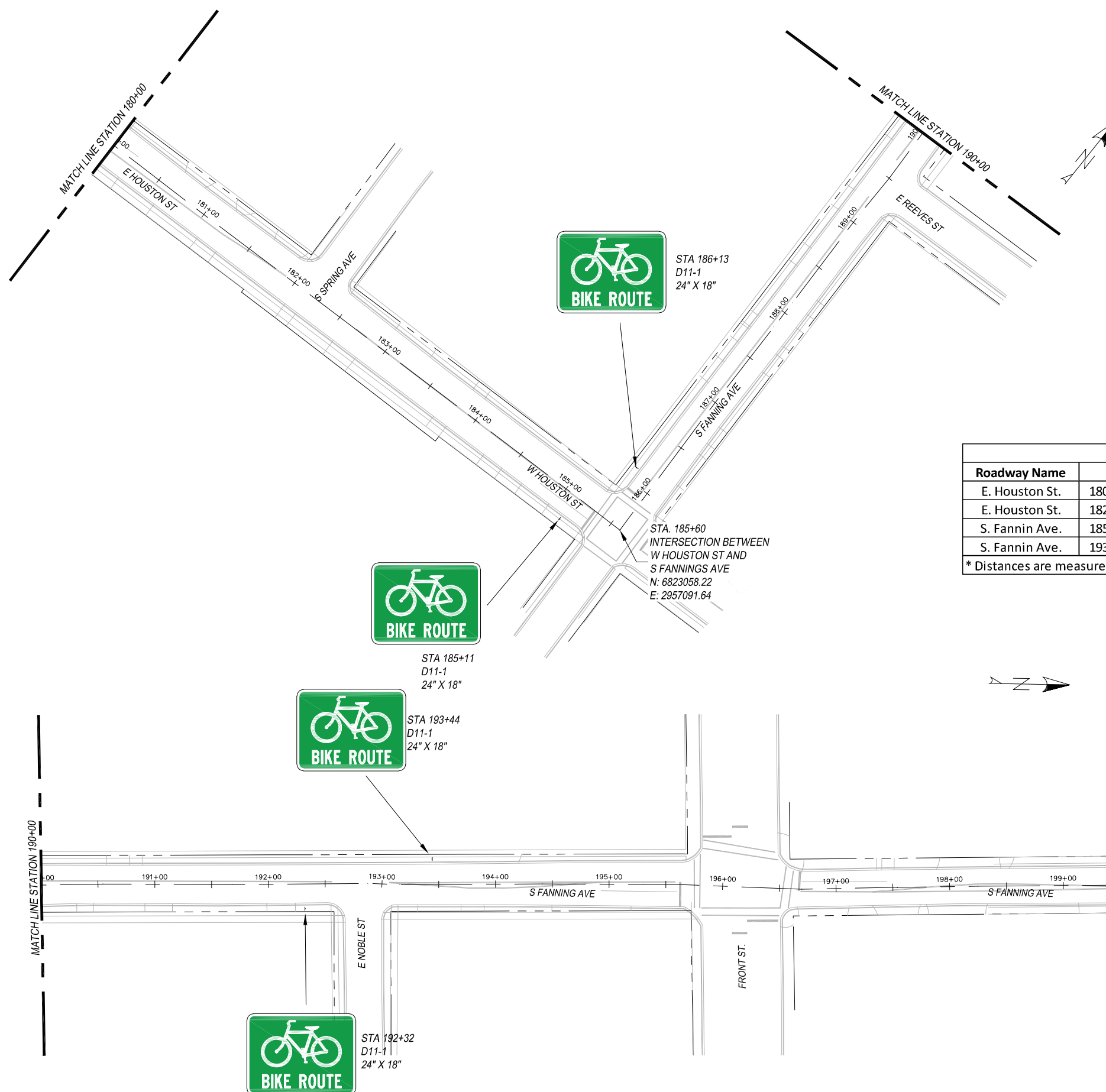

THIS DOCUMENT IS RELEASED FOR THE PURPOSE OF INTERIM REVIEW UNDER THE AUTHORITY OF MENA I. SOULIMAN, P.E. 136203 ON APRIL 24, 2020. IT IS NOT TO BE USED FOR CONSTRUCTION, BIDDING OR PERMIT PURPOSES.



TYLER BIKE STRIPES HUB

SCALE: 1" = 100'

FED. AD. DIV. NO.	FEDERAL AID PROJECT NO.	SHT. NO.	
6.	STP 2019 (290)	H-5	
STATE	STATE DIST. NO.	COUNTY	
TEXAS	10	SMITH	
CONT.	SECT.	JOB	HIGHWAY NO.
0910	16	144	CS

EXISTING CONDITIONS				
Roadway Name	Station	Number of Lanes	Lane Widths*	Parking Lane Width*
S. Fannin Ave.	200+00-207+12	2	14.5'-15.5'	0'
E. Elm St.	207+12-210+64	2	13.5'-15'	0'
S. Spring Ave.	210+64-215+00	2	14'-16'	0'
S. Spring Ave.	215+00-218+00	3	14'-14.5'	14'

* Distances are measured from the edge of the pavement, excluding the gutter.

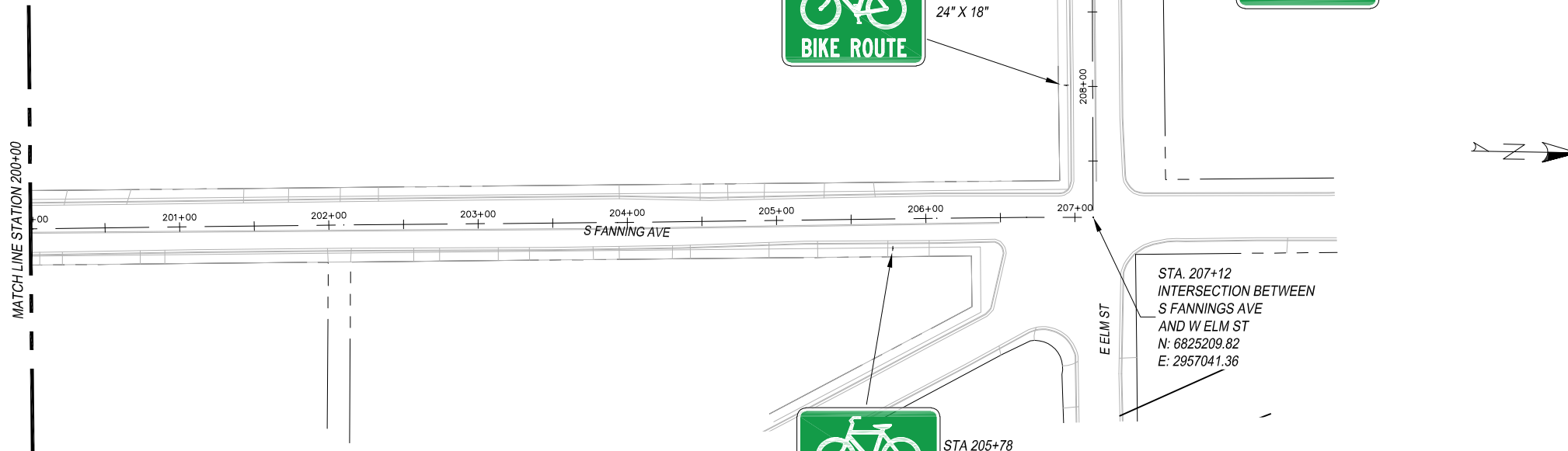

LEGEND

- — — EXISTING ROW
- PROPOSED SIGN

- NOTES:
- * CONTRACTOR TO VERIFY LOCATION OF EXISTING SIDEWALKS AND DRIVEWAYS
 - * CONTRACTOR TO VERIFY LOCATION OF EXISTING SIGNAGE TO ENSURE PROPER SIGN SPACING.

PROPOSED CONDITIONS					
Roadway Name	Station	Number of Lanes	Lane Widths*	Bicycle Lane Width*	Parking Lane Width*
S. Fannin Ave.	200+00-207+12	2	14.5'-15.5'	0'	0'
E. Elm St.	207+12-210+64	2	13.5'-15'	0'	0'
S. Spring Ave.	210+64-215+00	2	14'-16'	0'	0'
S. Spring Ave.	215+00-218+00	3	14'-14.5'	0'	14'

* Distances are measured from the edge of the pavement, excluding the gutter.

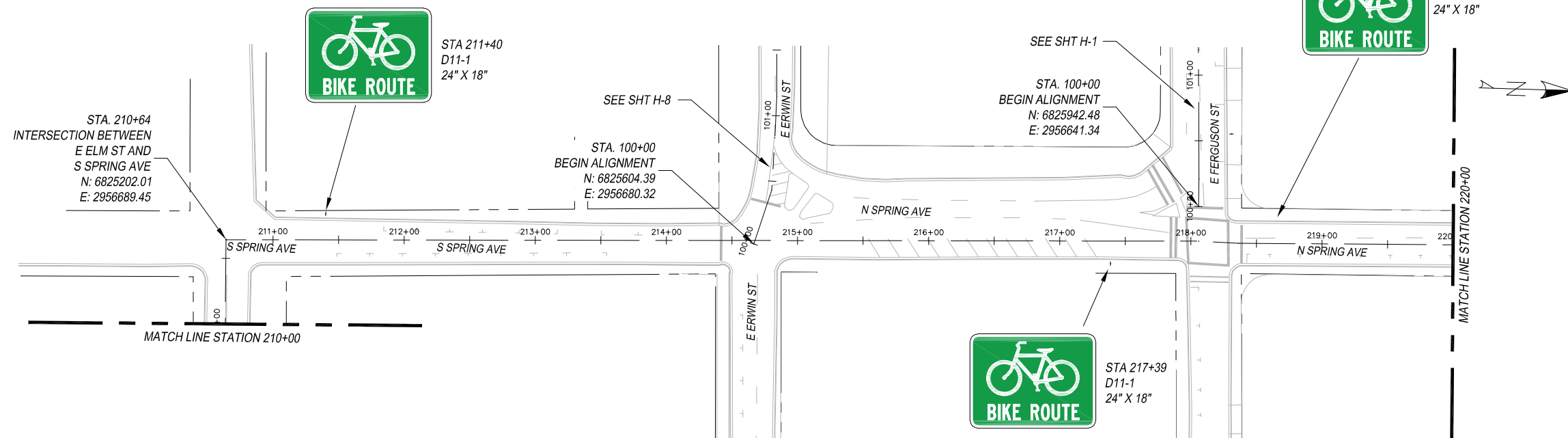

THIS DOCUMENT IS RELEASED FOR THE PURPOSE OF INTERIM REVIEW UNDER THE AUTHORITY OF MENA I. SOULIMAN, P.E. 136203 ON APRIL 24, 2020. IT IS NOT TO BE USED FOR CONSTRUCTION, BIDDING OR PERMIT PURPOSES.



TYLER BIKE STRIPES HUB
SCALE: 1" = 100'

FED. AD. DIV. NO.	FEDERAL AID PROJECT NO.	SHT. NO.	
6.	STP 2019 (290)	H-6	
STATE	STATE DIST. NO.	COUNTY	
TEXAS	10	SMITH	
CONT.	SECT.	JOB	HIGHWAY NO.
0910	16	144	CS

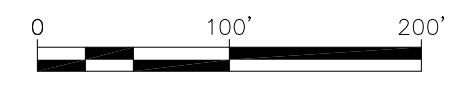

EXISTING CONDITIONS				
Roadway Name	Station	Number of Lanes	Lane Widths*	Parking Lane Width*
N. Spring Ave.	220+00-224+96	2	11'-11.5'	7'

* Distances are measured from the edge of the pavement, excluding the gutter.

PROPOSED CONDITIONS					
Roadway Name	Station	Number of Lanes	Lane Widths*	Bicycle Lane Width*	Parking Lane Width*
N. Spring Ave.	220+00-224+96	2	11'-11.5'	0'	7'

* Distances are measured from the edge of the pavement, excluding the gutter.

LEGEND

- — — EXISTING ROW
- ○ — PROPOSED SIGN

NOTES:

- * CONTRACTOR TO VERIFY LOCATION OF EXISTING SIDEWALKS AND DRIVEWAYS
- * CONTRACTOR TO VERIFY LOCATION OF EXISTING SIGNAGE TO ENSURE PROPER SIGN SPACING.

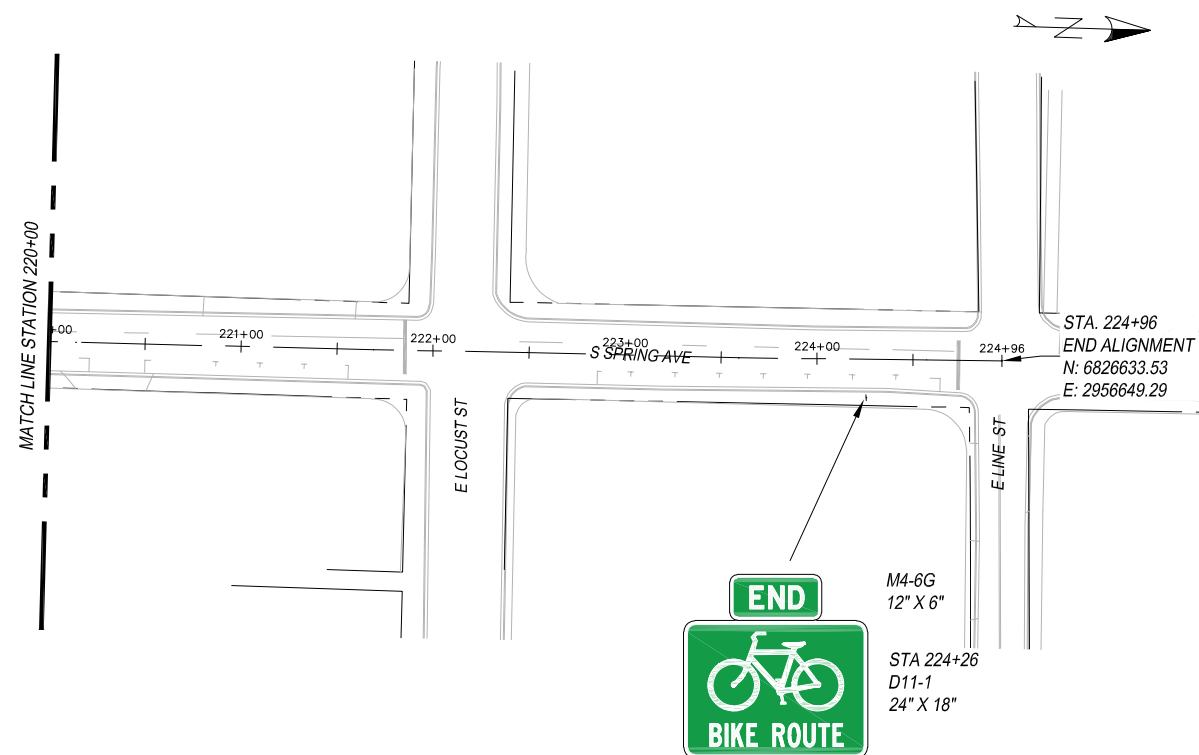

THIS DOCUMENT IS RELEASED FOR THE PURPOSE OF INTERIM REVIEW UNDER THE AUTHORITY OF MENA I. SOULIMAN, P.E. 136203 ON APRIL 24, 2020. IT IS NOT TO BE USED FOR CONSTRUCTION, BIDDING OR PERMIT PURPOSES.



The University of Texas at
TYLER

TYLER BIKE STRIPES
HUB
SCALE: 1" = 100'

FED. AD. DIV. NO.	FEDERAL AID PROJECT NO.		SHT. NO.
6.	STP 2019 (290)		H-7
STATE	STATE DIST. NO.	COUNTY	
TEXAS	10	SMITH	
CONT.	SECT.	JOB	HIGHWAY NO.
0910	16	144	CS



EXISTING CONDITIONS				
Roadway Name	Station	Number of Lanes	Lane Widths*	Parking Lane Width*
W. Erwin St.	100+00-103+00	2	11'-11.5'	0'
W. Erwin St.	103+00-106+00	3	11'-11.5'	0'
W. Erwin St.	106+00-113+00	2	11'-14.5'	7'
W. Erwin St.	113+00-120+00	2	17.5'-19'	0'

* Distances are measured from the edge of the pavement, excluding the gutter.

PROPOSED CONDITIONS					
Roadway Name	Station	Number of Lanes	Lane Widths*	Bicycle Lane Width*	Parking Lane Width*
W. Erwin St.	100+00-103+00	2	11'-11.5'	0'	0'
W. Erwin St.	103+00-106+00	3	11'-11.5'	0'	0'
W. Erwin St.	106+00-113+00	2	11'-14.5'	0'	7'
W. Erwin St.	113+00-120+00	2	17.5'-19'	0'	0'

* Distances are measured from the edge of the pavement, excluding the gutter.

LEGEND

- — — EXISTING ROW
- ○ — PROPOSED SIGN

NOTES:

- * CONTRACTOR TO VERIFY LOCATION OF EXISTING SIDEWALKS AND DRIVEWAYS
- * CONTRACTOR TO VERIFY LOCATION OF EXISTING SIGNAGE TO ENSURE PROPER SIGN SPACING.

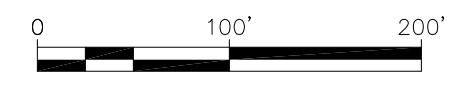
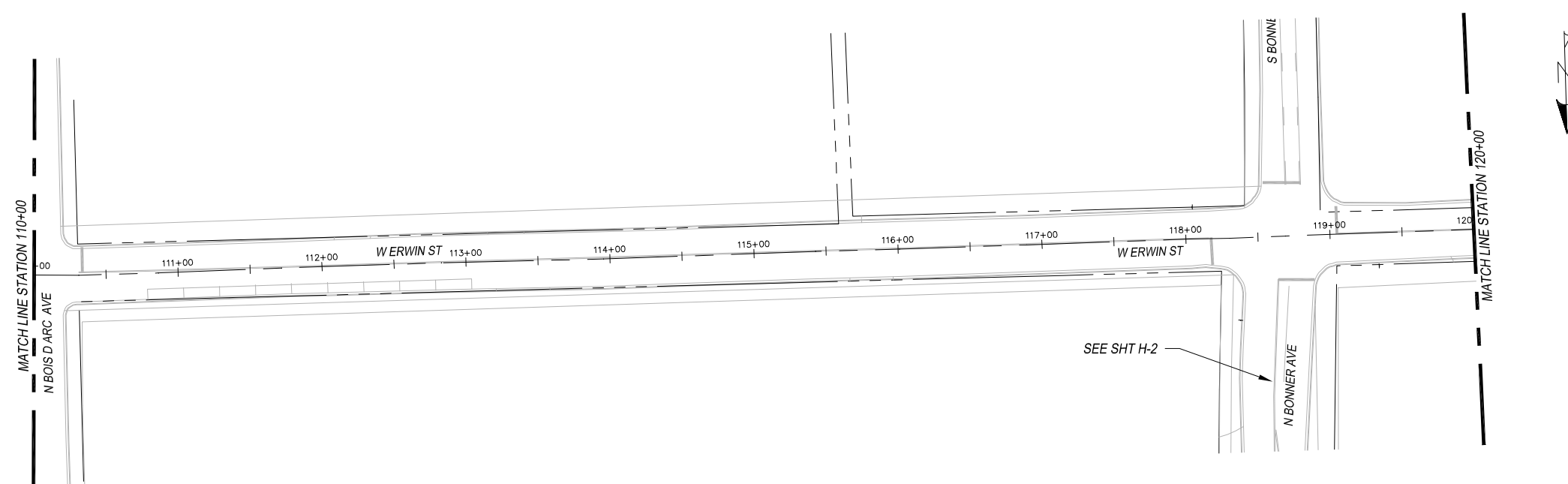
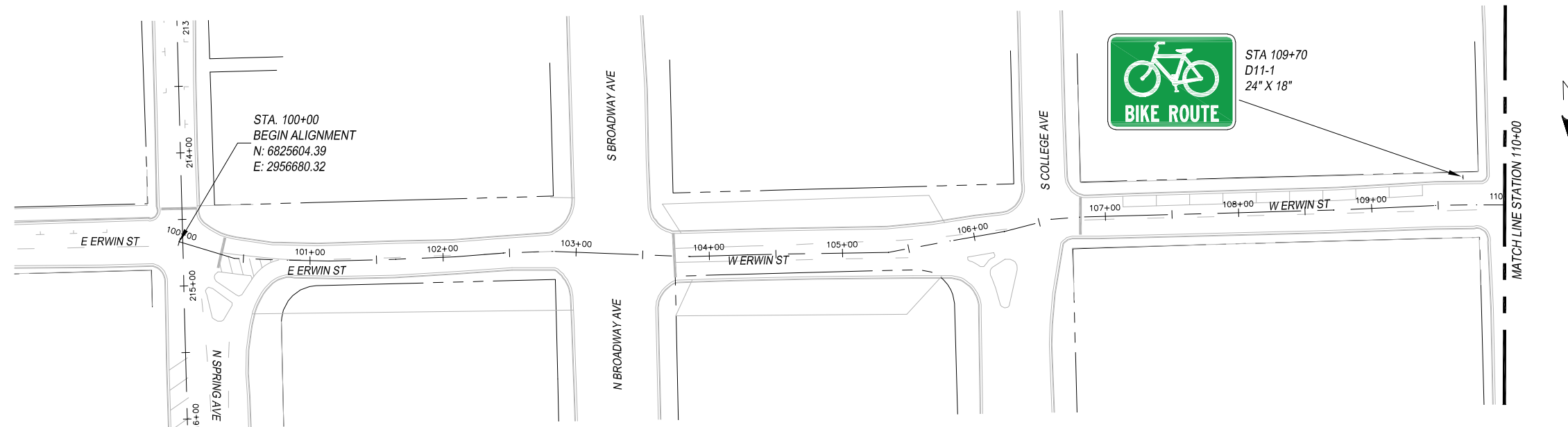

THIS DOCUMENT IS RELEASED FOR THE PURPOSE OF INTERIM REVIEW UNDER THE AUTHORITY OF MENA I. SOULIMAN, P.E. 136203 ON APRIL 24, 2020. IT IS NOT TO BE USED FOR CONSTRUCTION, BIDDING OR PERMIT PURPOSES.



TYLER BIKE STRIPES HUB

SCALE: 1" = 100'

FED. AD. DIV. NO.	FEDERAL AID PROJECT NO.	SHT. NO.	
6.	STP 2019 (290)	H-8	
STATE	STATE DIST. NO.	COUNTY	
TEXAS	10	SMITH	
CONT.	SECT.	JOB	HIGHWAY NO.
0910	16	144	CS

EXISTING CONDITIONS			
Roadway Name	Station	Number of Lanes	Lane Widths*
W. Erwin St.	120+00-130+00	2	18'-18.5'
W. Erwin St.	130+00-136+31	3	11.5'-13.5'

* Distances are measured from the edge of the pavement, excluding the gutter.

PROPOSED CONDITIONS				
Roadway Name	Station	Number of Lanes	Lane Widths*	Bicycle Lane Width*
W. Erwin St.	120+00-130+00	2	18'-18.5'	0'
W. Erwin St.	130+00-136+31	3	11.5'-13.5'	0'

* Distances are measured from the edge of the pavement, excluding the gutter.

LEGEND

- — — EXISTING ROW
- PROPOSED SIGN

- NOTES:
- * CONTRACTOR TO VERIFY LOCATION OF EXISTING SIDEWALKS AND DRIVEWAYS
 - * CONTRACTOR TO VERIFY LOCATION OF EXISTING SIGNAGE TO ENSURE PROPER SIGN SPACING.

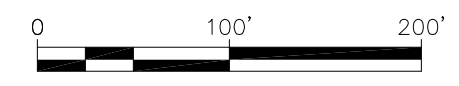
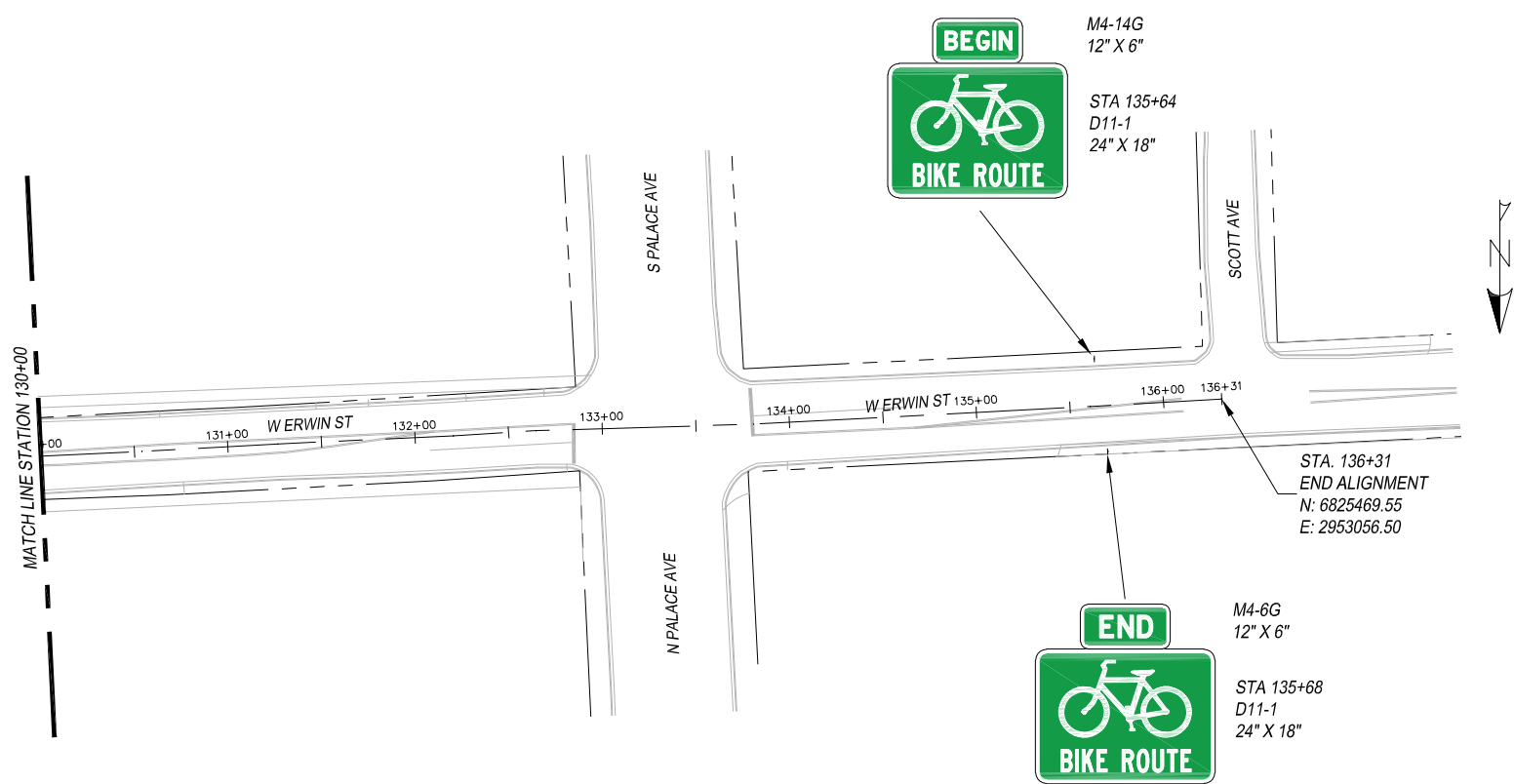
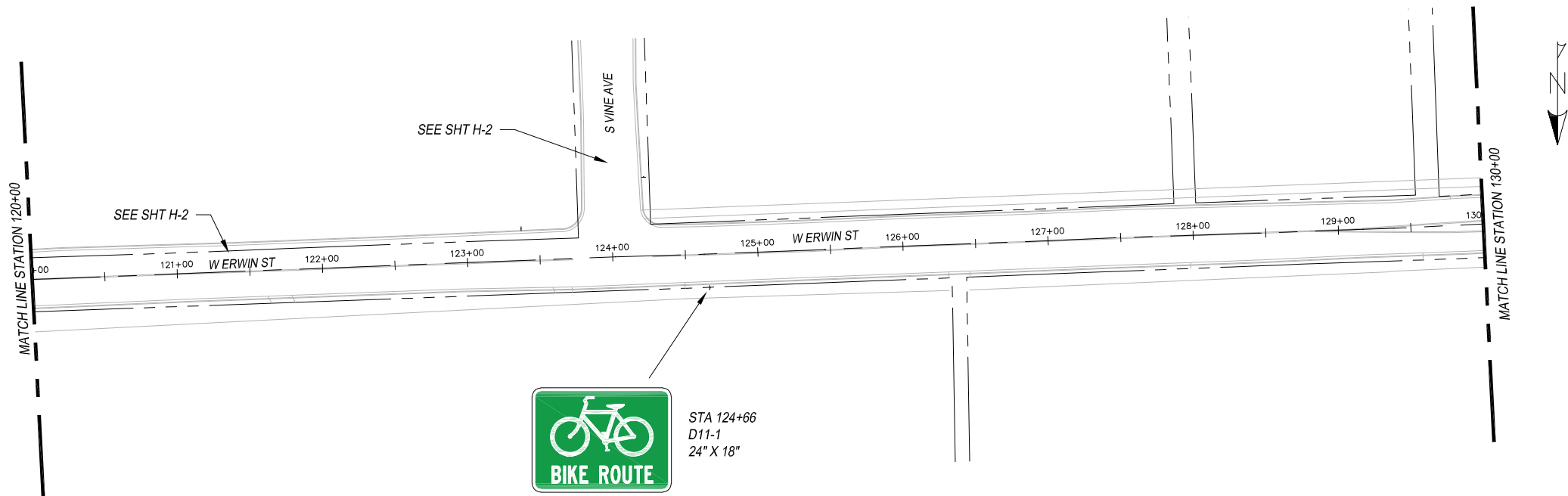

THIS DOCUMENT IS RELEASED FOR THE PURPOSE OF INTERIM REVIEW UNDER THE AUTHORITY OF MENA I. SOULIMAN, P.E. 136203 ON APRIL 24, 2020. IT IS NOT TO BE USED FOR CONSTRUCTION, BIDDING OR PERMIT PURPOSES.



TYLER BIKE STRIPES HUB
SCALE: 1" = 100'

FED. AD. DIV. NO.	FEDERAL AID PROJECT NO.	SHT. NO.	
6.	STP 2019 (290)	H-9	
STATE	STATE DIST. NO.	COUNTY	
TEXAS	10	SMITH	
CONT.	SECT.	JOB	HIGHWAY NO.
0910	16	144	CS